

RASTER

PARENT PARCEL: 02-02-025-121-007

CHILD PARCEL: _____

STARTING POINT: S/L'S 314 & 315 IN OAKLAND ADD. (VOL.4 PG.17)

12-02461-C

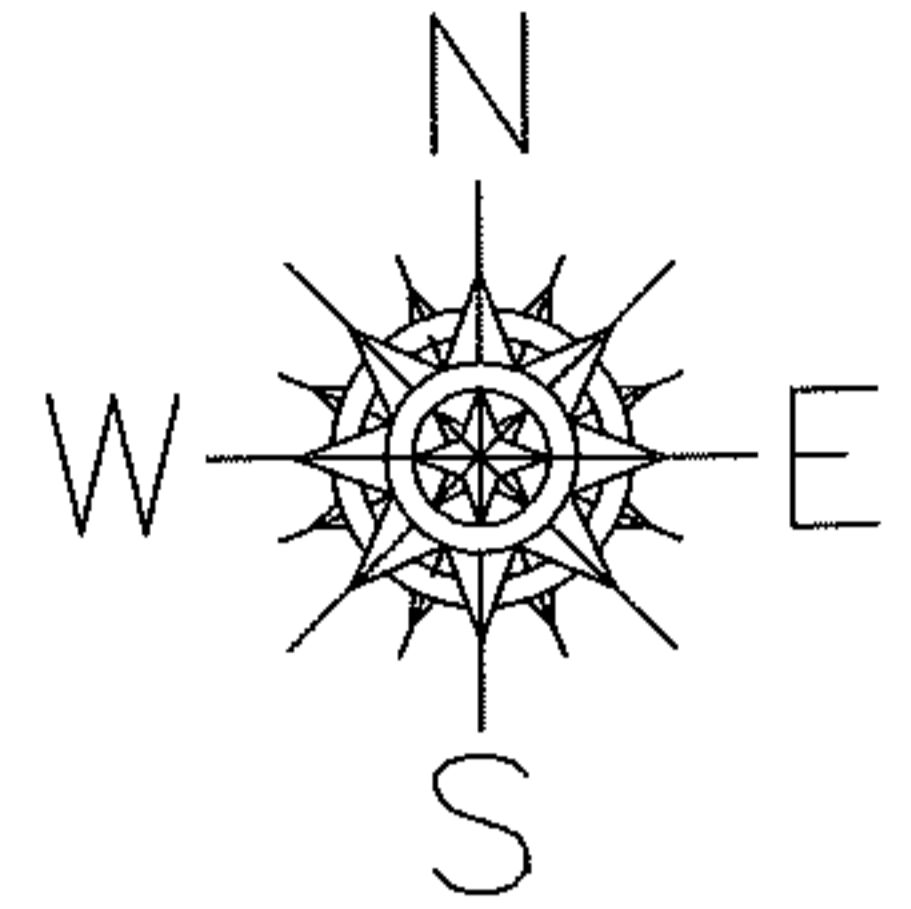

21ST. ST.

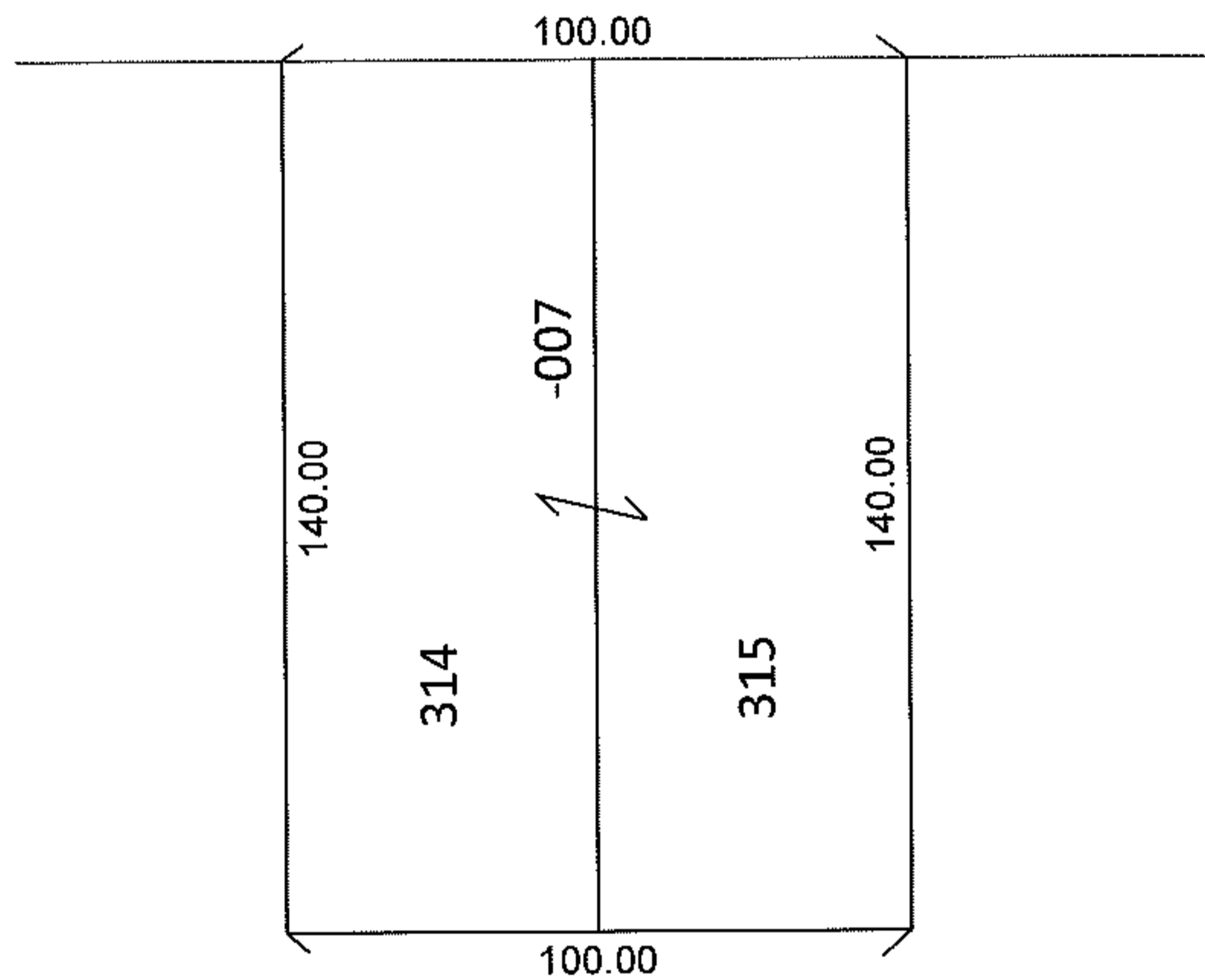

DEPTH CORRECTION

02-02-025-121-007

140

100 X ~~150~~

PER PRIOR DEEDS

NO MAP CHANGES

SPLITS/DEEDS PROCESSED

LORAIN COUNTY TAX MAP DEPARTMENT
226 MIDDLE AVE. ELYRIA, OHIO

SURVEYED BY: N/A

CLOSURE: N/A

MAP PAGE(S): 2-02-025-A

APPROVED BY: RRM DATE: 3-14-12

SCALE: 1" = 50' PRIOR INST.: 20010751131

