

RASTER

PARENT PARCEL: 05-00-080-101-005, -001, -002, -018

07-02433

CHILD PARCEL: 05-00-080-101-096 THRU -099

STARTING POINT: INTERSECTION OF O.L. 60, O.L. 61, O.L. 80, O.L. 79

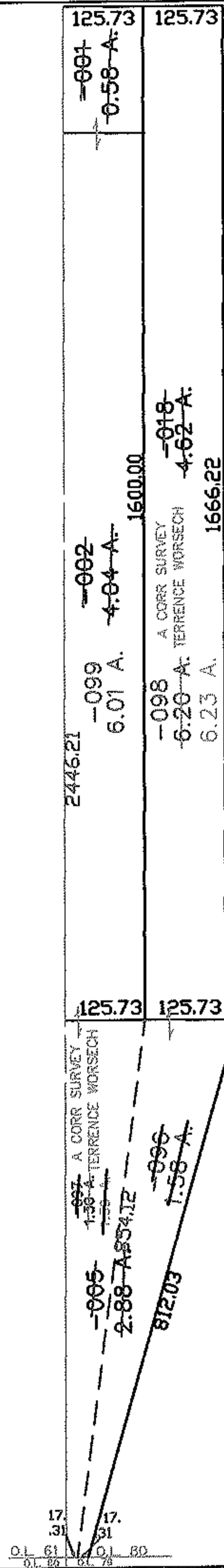
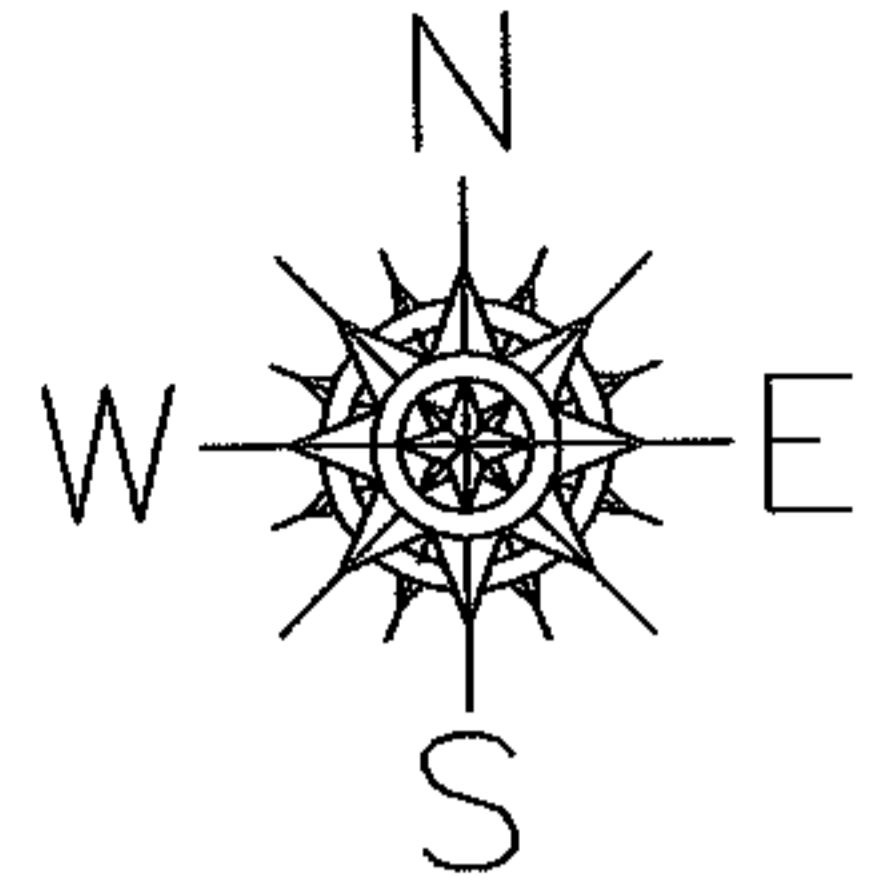

**SPLITS/DEEDS PROCESSED**

LORAIN COUNTY TAX MAP DEPARTMENT  
226 MIDDLE AVE. ELYRIA, OHIO

SURVEYED BY: TERRENCE WORSECH

CLOSURE: 0.00 : 10,000

MAP PAGE(S): 05-00-080-A

APPROVED BY: JAH DATE: 8-6-07

SCALE: 1" = 300 PRIOR INSTRUMENT: OR 1026/712