

PARENT PARCEL: 15-00-046-104-018

CHILD PARCEL:

STARTING POINT: SOUTHWEST CORNER OF O.L.46

11-02358-C

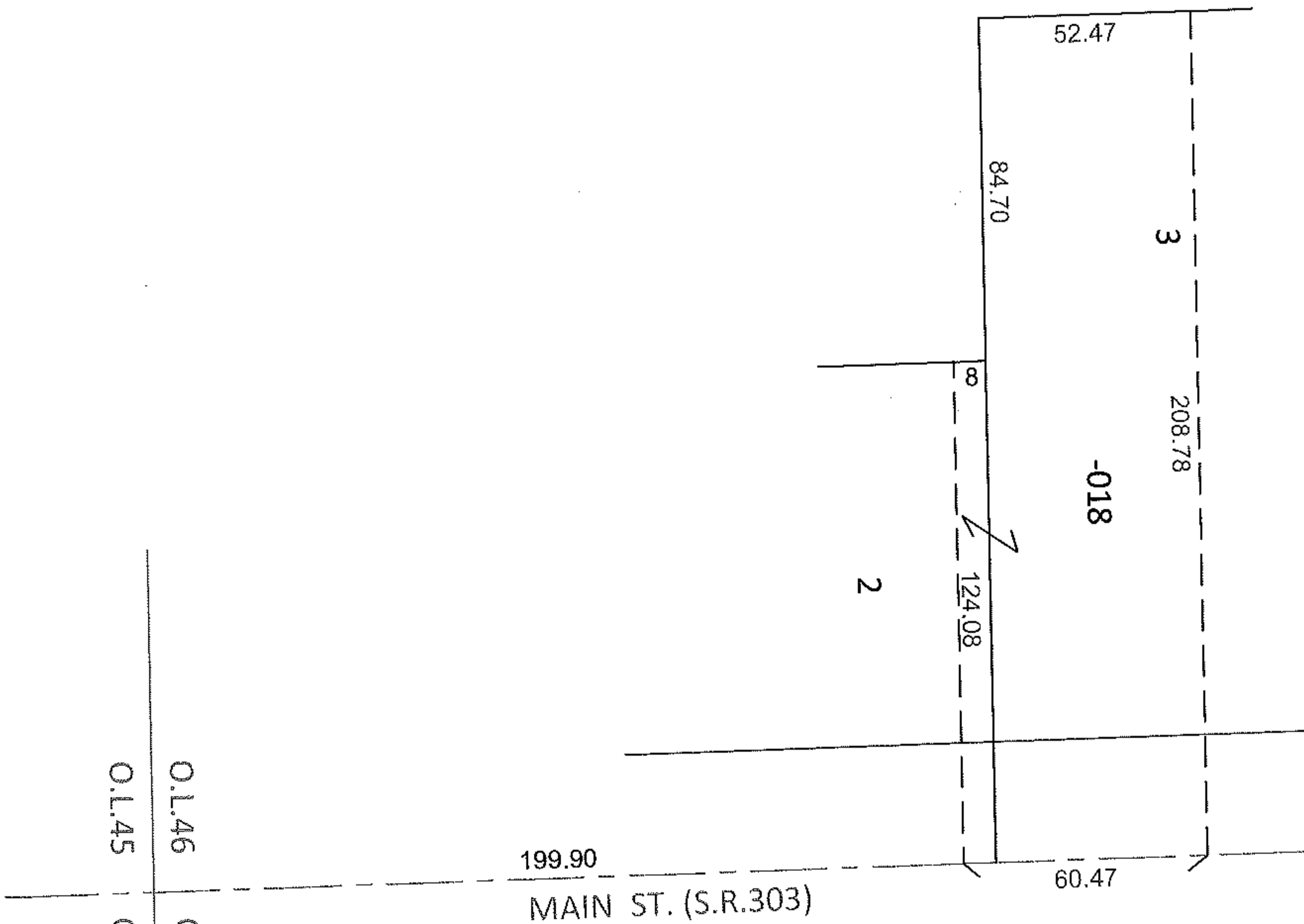
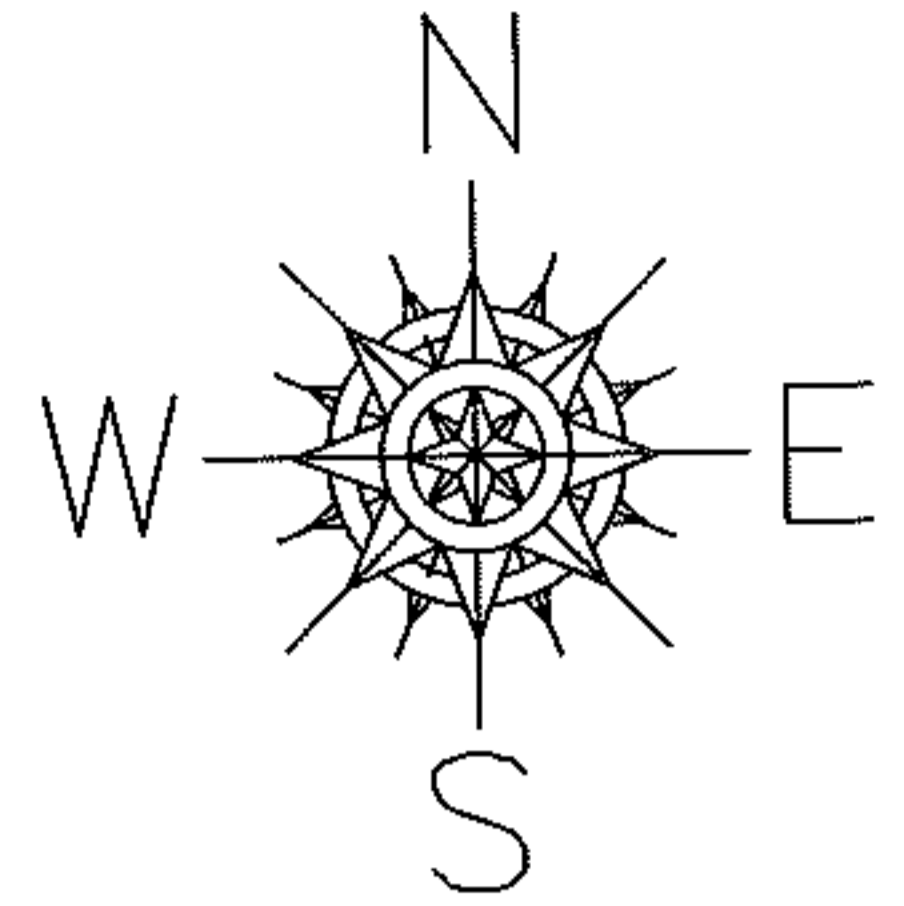

**FRONTAGE AND DEPTH CORRECTION**

15-00-046-104-018

60.47 X 208.78

~~60.50 X 208 IRR~~

PER SURV. G. PENFOUND

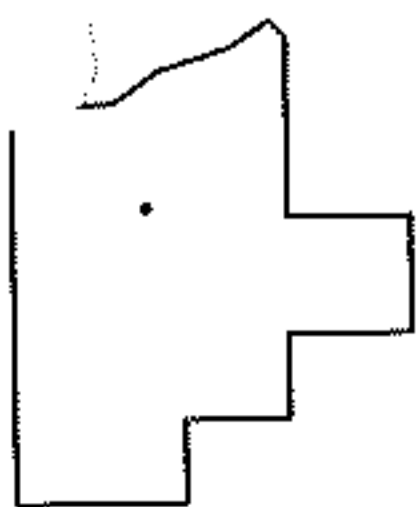

**SPLITS/DEEDS PROCESSED**

LORAIN COUNTY TAX MAP DEPARTMENT  
226 MIDDLE AVE. ELYRIA, OHIO

SURVEYED BY: GARY E. PENFOUND

CLOSURE: .00:10,000

MAP PAGE(S): 15-00-046-A

APPROVED BY: RRM DATE: 9-27-11

SCALE: 1"= 50' PRIOR INST.: 20050112417