

RASTER

PARENT PARCEL: 06-23-010-102-021

CHILD PARCEL: _____

STARTING POINT: SOUTHWEST CORNER OF O.L. 10

11-02325-C

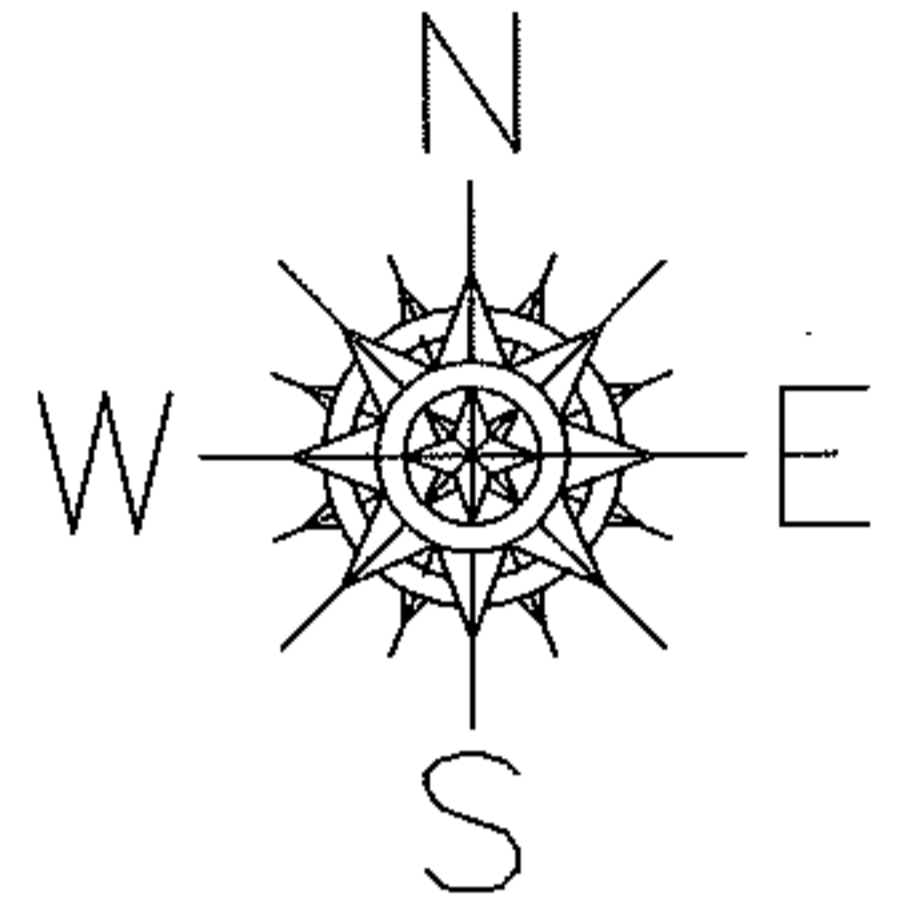

IDLEWOOD DR.

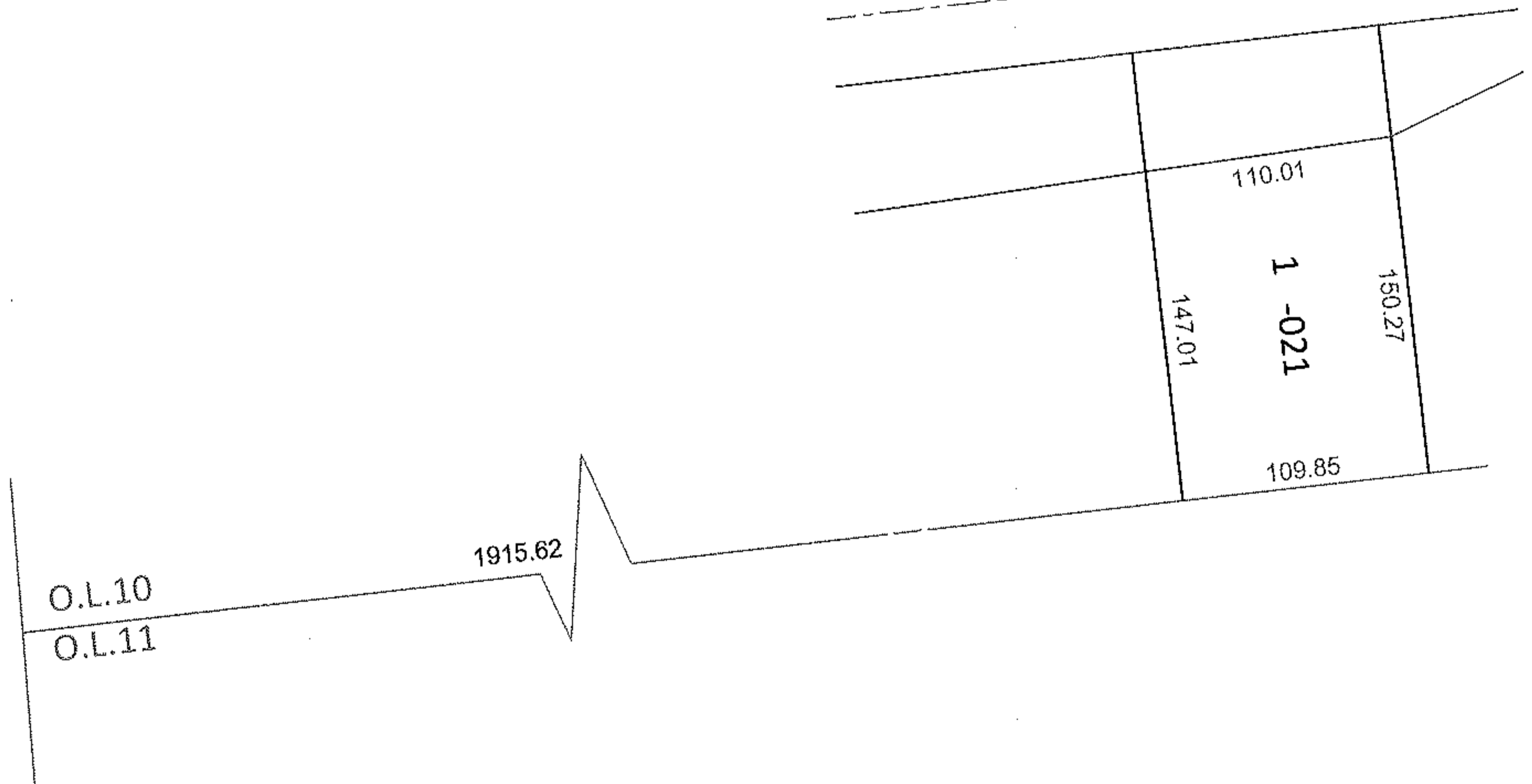

FRONTAGE AND DEPTH CORRECTION

06-23-010-102-021

110.01 X 150.27

~~110 X 147~~

PER SURV. BY T.SIMON

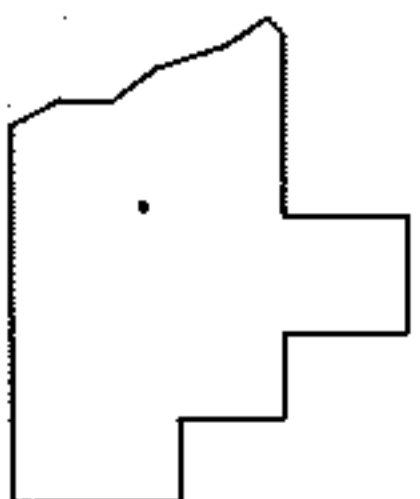

SPLITS/DEEDS PROCESSED

LORAIN COUNTY TAX MAP DEPARTMENT
226 MIDDLE AVE. ELYRIA, OHIO

SURVEYED BY: THOMAS A. SIMON

CLOSURE: .00:10.00

MAP PAGE(S): 6-25

APPROVED BY: RRM DATE: 7-21-11

SCALE: 1"= 100 PRIOR INST.: 20090304133