

RASTER

PARENT PARCEL: 09-00-096-104-007

11-02315-A

CHILD PARCEL: _____

STARTING POINT: SOUTHWEST CORNER OF LAND CONVEYED TO EFFIE S. SECHLER(DV 172/76)

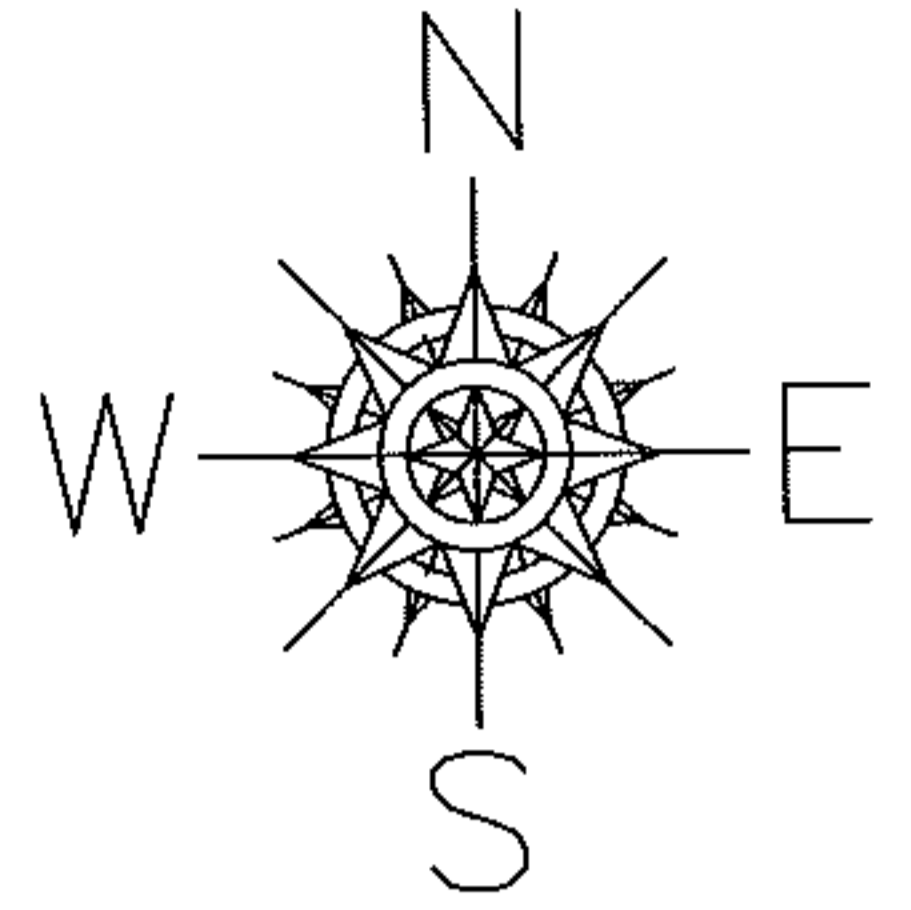

ACREAGE AND MAP CORRECTION
CHANGE OWNERSHIP TO SIDELINE OF STREET

MAIN ST.

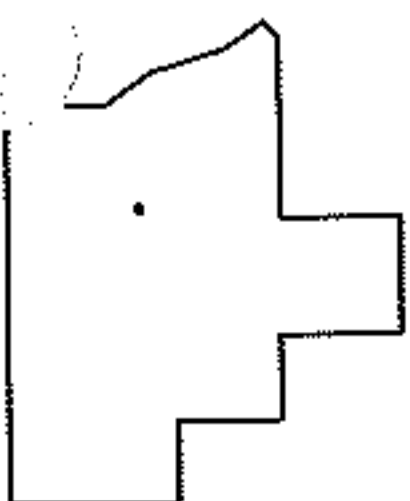
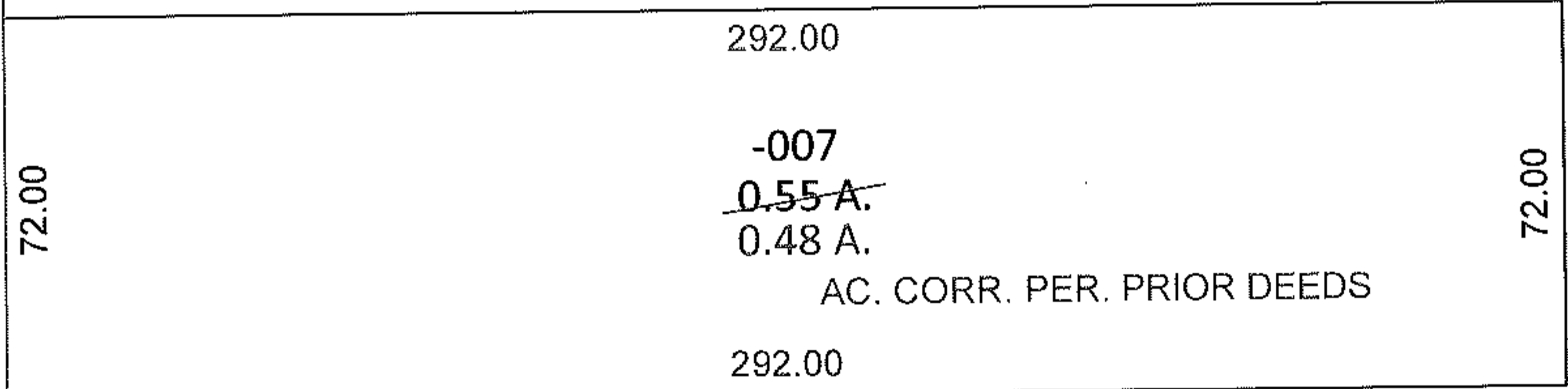

SPLITS/DEEDS PROCESSED

LORAIN COUNTY TAX MAP DEPARTMENT
226 MIDDLE AVE. ELYRIA, OHIO

SURVEYED BY: N/A

CLOSURE: N/A

MAP PAGE(S): 9-00-096-A

APPROVED BY: RRM DATE: 6-29-11

SCALE: 1"= 50' PRIOR INST.: 20020877644