

PARENT PARCEL: 18-00-022-108-036

CHILD PARCEL: _____

STARTING POINT: NORTHEAST CORNER OF S/L 98 IN PHELP'S ADD. TO BLOCK 4(VOL.3 PG.6)

11-02277-C

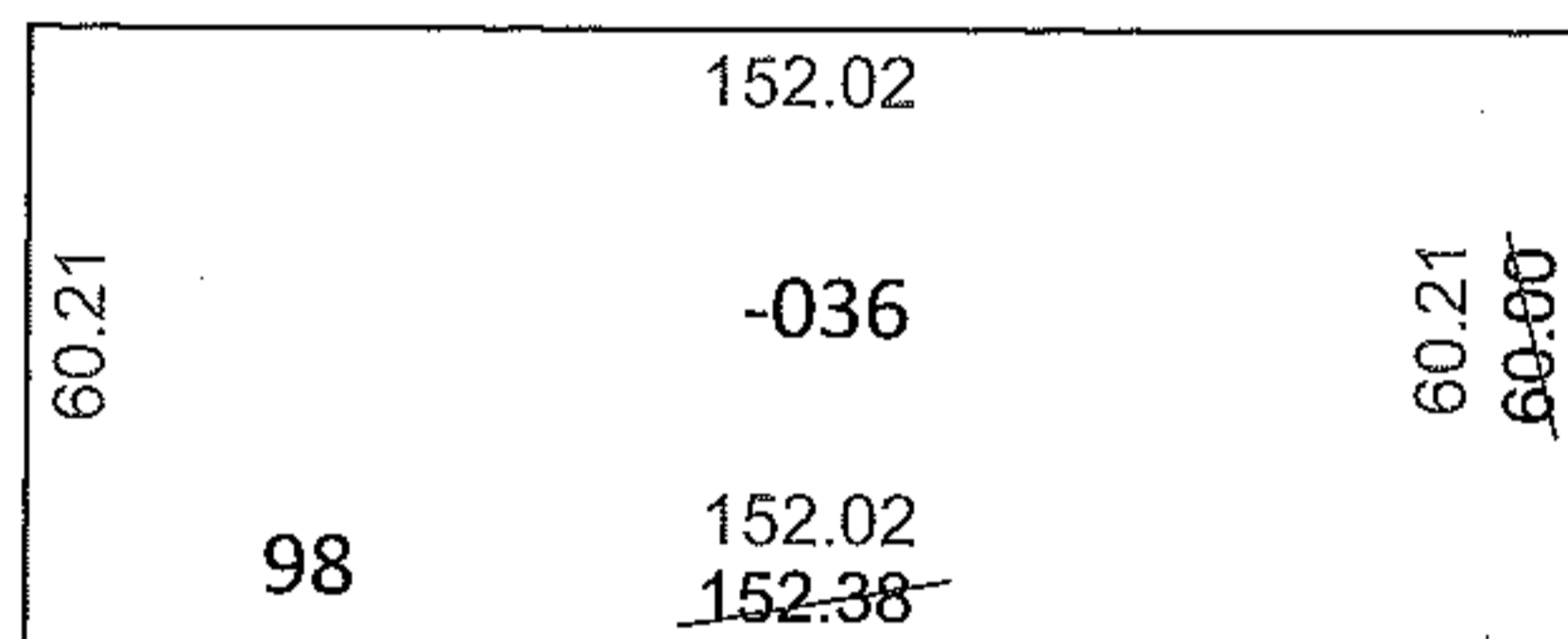
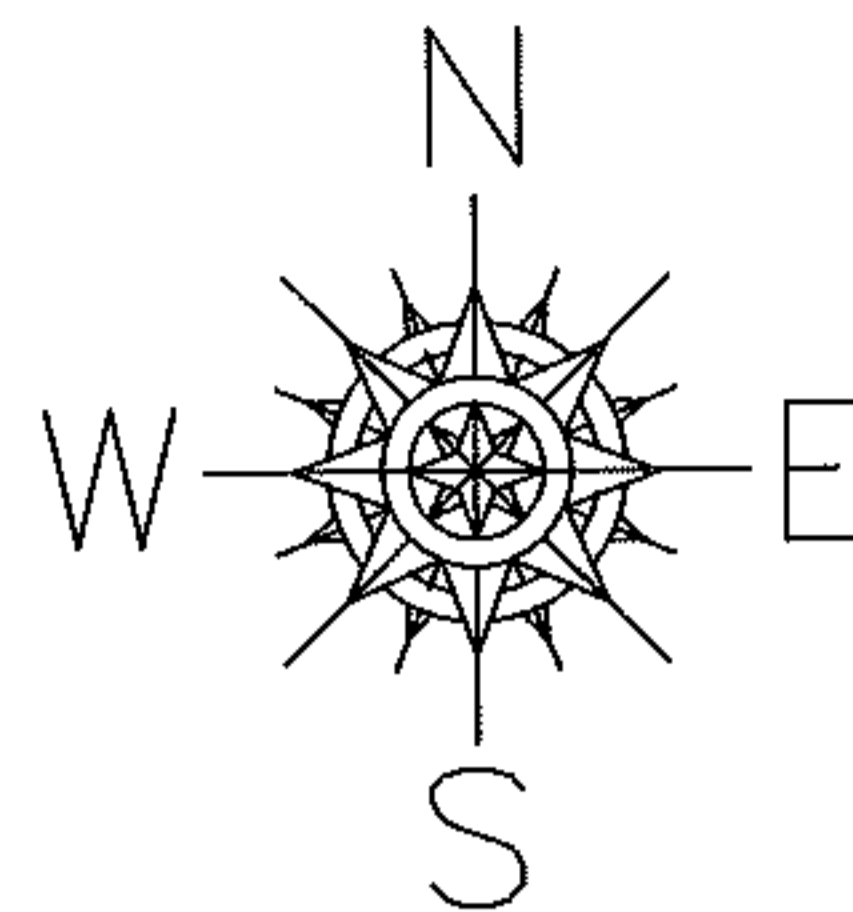

COURTLAND ST.

FRONTAGE AND DEPTH CORRECTION

18-00-022-108-036

60.21 X 152.02

~~60 X 152~~

PER SURV. S. CAMPBELL

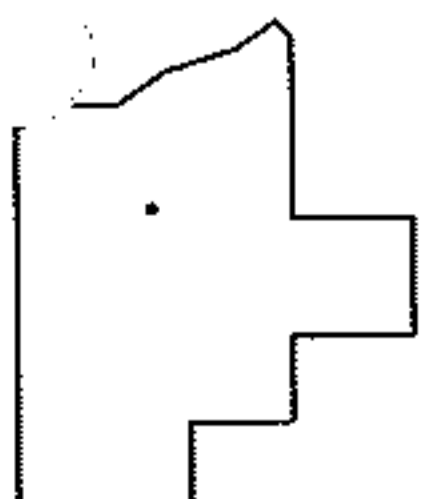

SPLITS/DEEDS PROCESSED

LORAIN COUNTY TAX MAP DEPARTMENT
226 MIDDLE AVE. ELYRIA, OHIO

SURVEYED BY: STEPHEN P. CAMPBELL

CLOSURE: .00:10,000

MAP PAGE(S): 18-00-022-C

APPROVED BY: RRM DATE: 4-5-11

SCALE: 1"= 50' PRIOR INST.: 20100360237