

PARENT PARCEL: 02-02-025-108-021

CHILD PARCEL: _____

STARTING POINT: SOUTHWEST CORNER OF S/L 51 IN W.S. POLE'S 1ST ADD.(VOL.7 PG.39)

11-02275-C

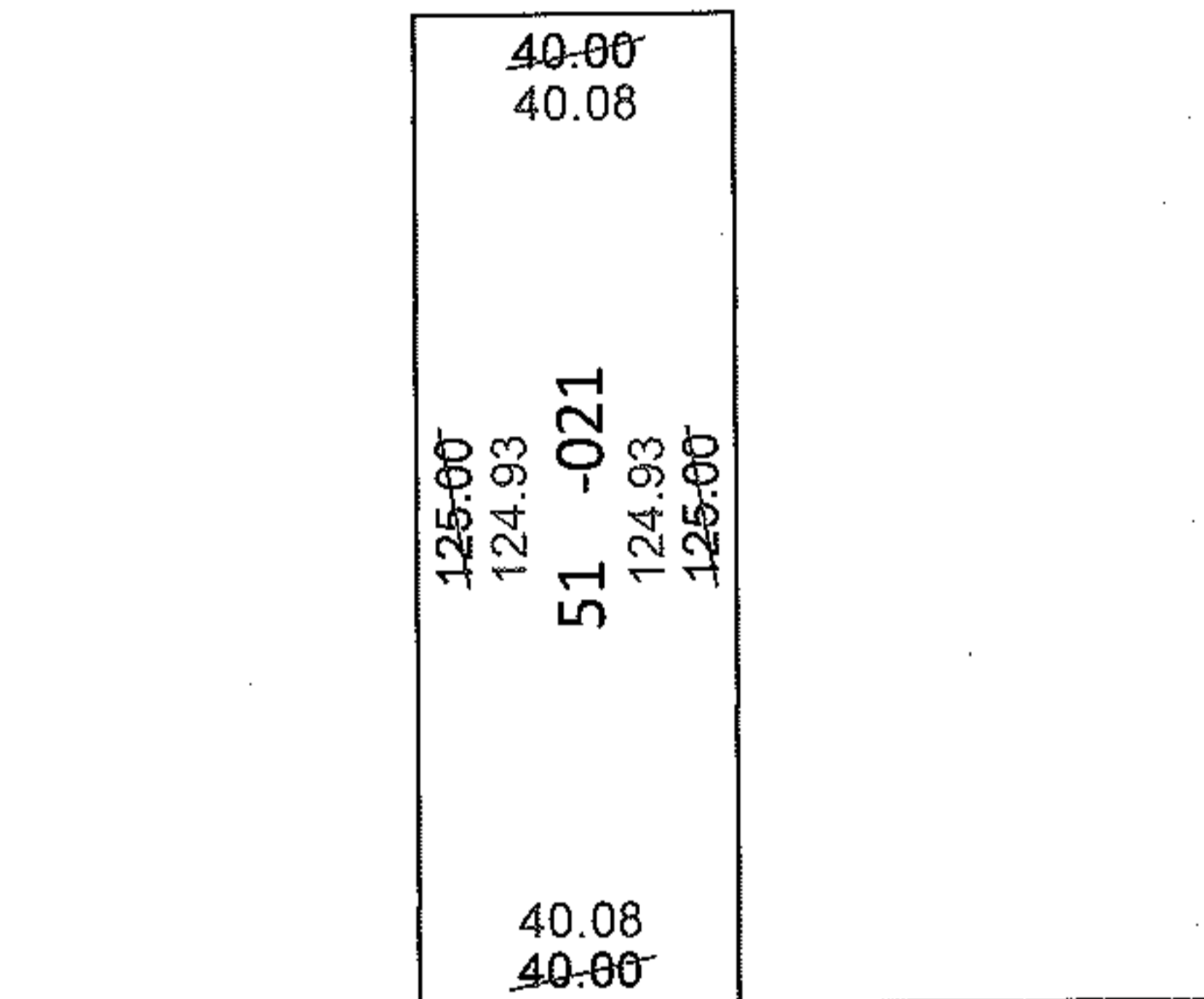
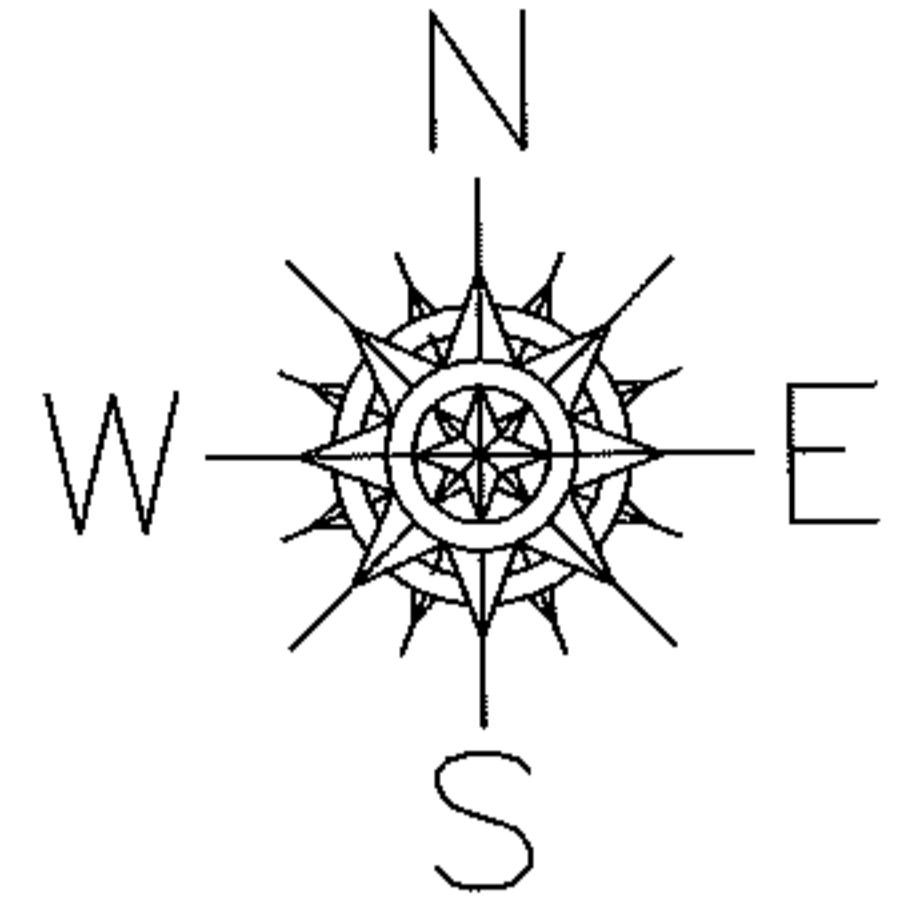

17TH ST.

FRONTAGE AND DEPTH CORRECTION

02-02-025-108-021

40.08 X 124.93

~~40 X 125~~

PER SURV. J.CORALL

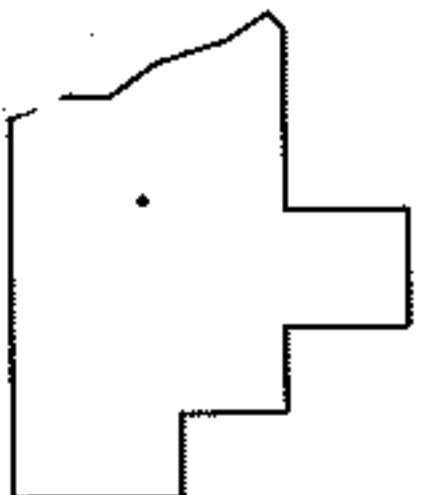

SPLITS/DEEDS PROCESSED

LORAIN COUNTY TAX MAP DEPARTMENT
226 MIDDLE AVE. ELYRIA, OHIO

SURVEYED BY: JOSEPH A. CORALL

CLOSURE: .00:10,000

MAP PAGE(S): 2-02-025-B

APPROVED BY: RRM DATE: 3-31-11

SCALE: 1"= 50' PRIOR INST.: 20110363807