

PARENT PARCEL: 06-22-012-101-014, -018

CHILD PARCEL: _____

STARTING POINT: SOUTHWEST CORNER OF S/L 6 IN FACKLER ALLOT. (VOL.6 PG.5)

11-02256-D

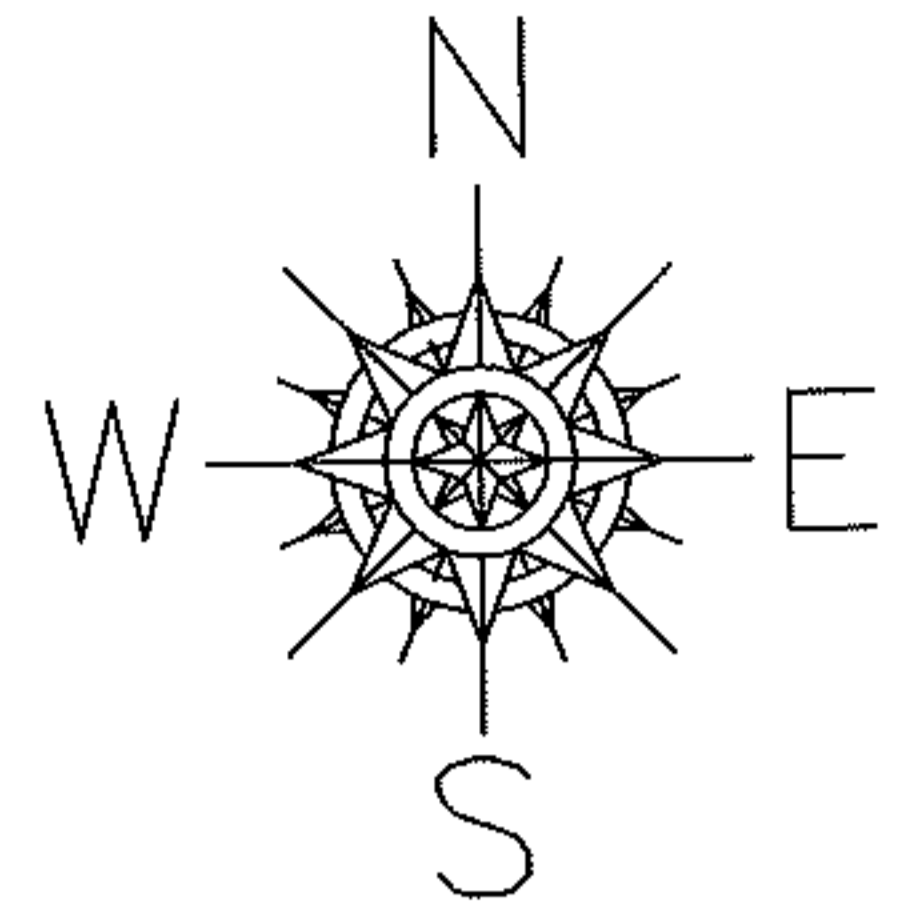

REMOVE SURVEY BEFORE NEXT TRANS

NO MAP CHANGES

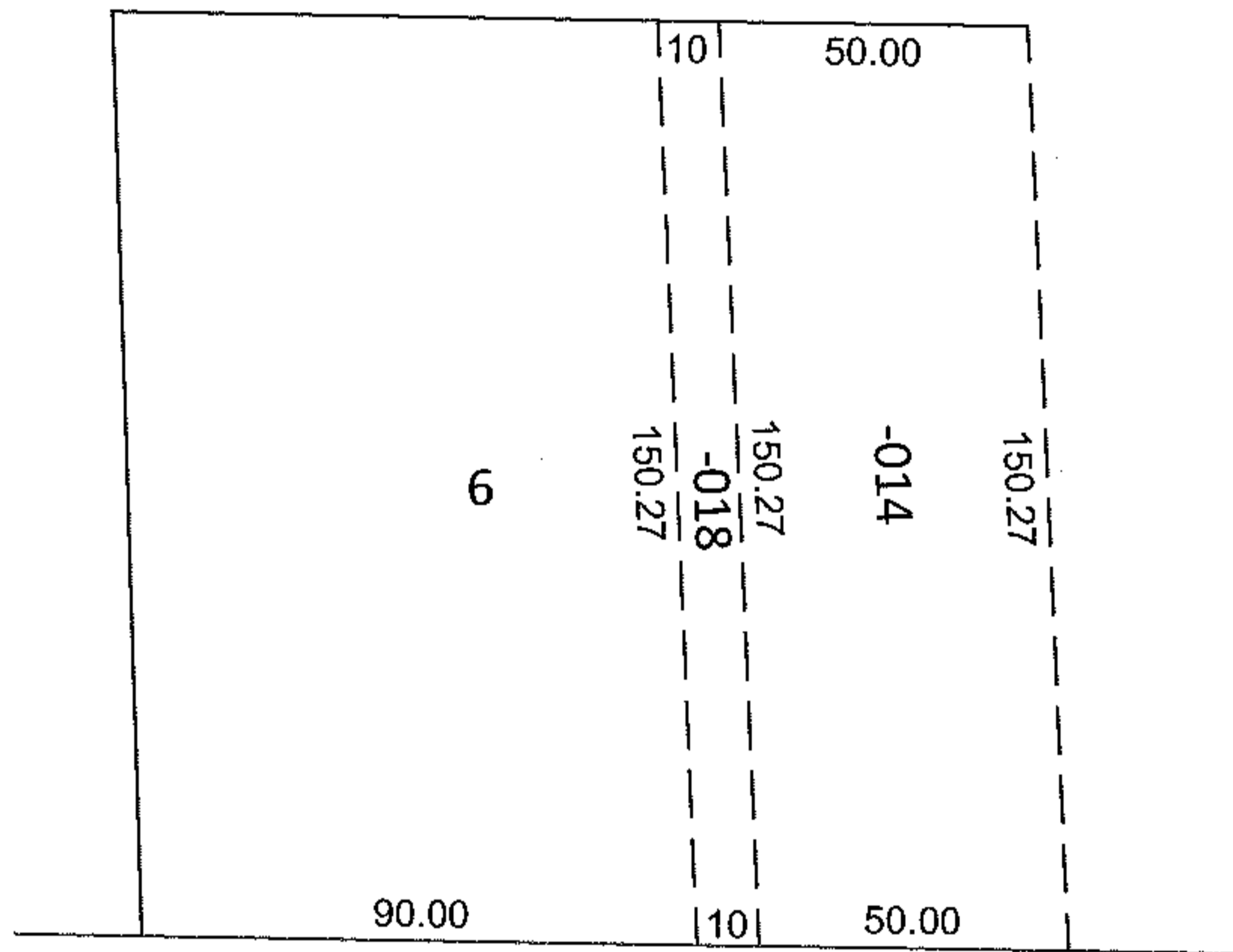

FACKLER AVE

DEPTH CORRECTION

06-22-012-101-014

06-22-012-101-018

150.27
50 X ~~150~~

150.27
10 X ~~150~~

CORR. PER SURV. E.DUDLEY III

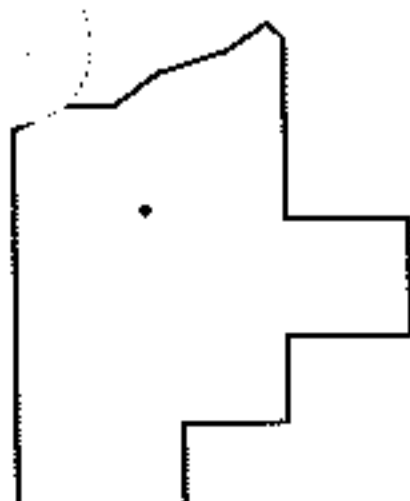

SPLITS/DEEDS PROCESSED

LORAIN COUNTY TAX MAP DEPARTMENT
226 MIDDLE AVE. ELYRIA, OHIO

SURVEYED BY: EDWARD B. DUDLEY III

CLOSURE: .00:10,000

MAP PAGE(S): 6-11

APPROVED BY: RRM DATE: 3-9-11

SCALE: 1"= 50' PRIOR INST.: 20110361987