

PARENT PARCEL: 07-00-036-000-027,-007

CHILD PARCEL: 07-00-036-000-342 THRU -344

06-02239

STARTING POINT: MON BOX AT INTERSECTION OF C/L OF CHESTNUT RIDGE RD. AND C/L OF ARCHER RD.

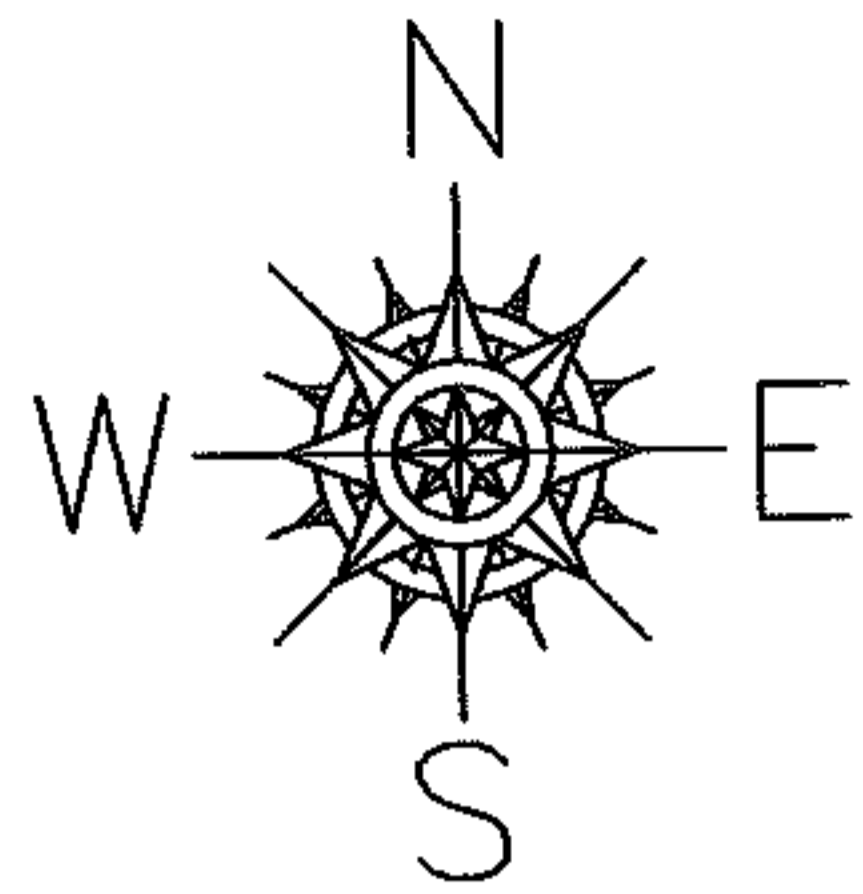
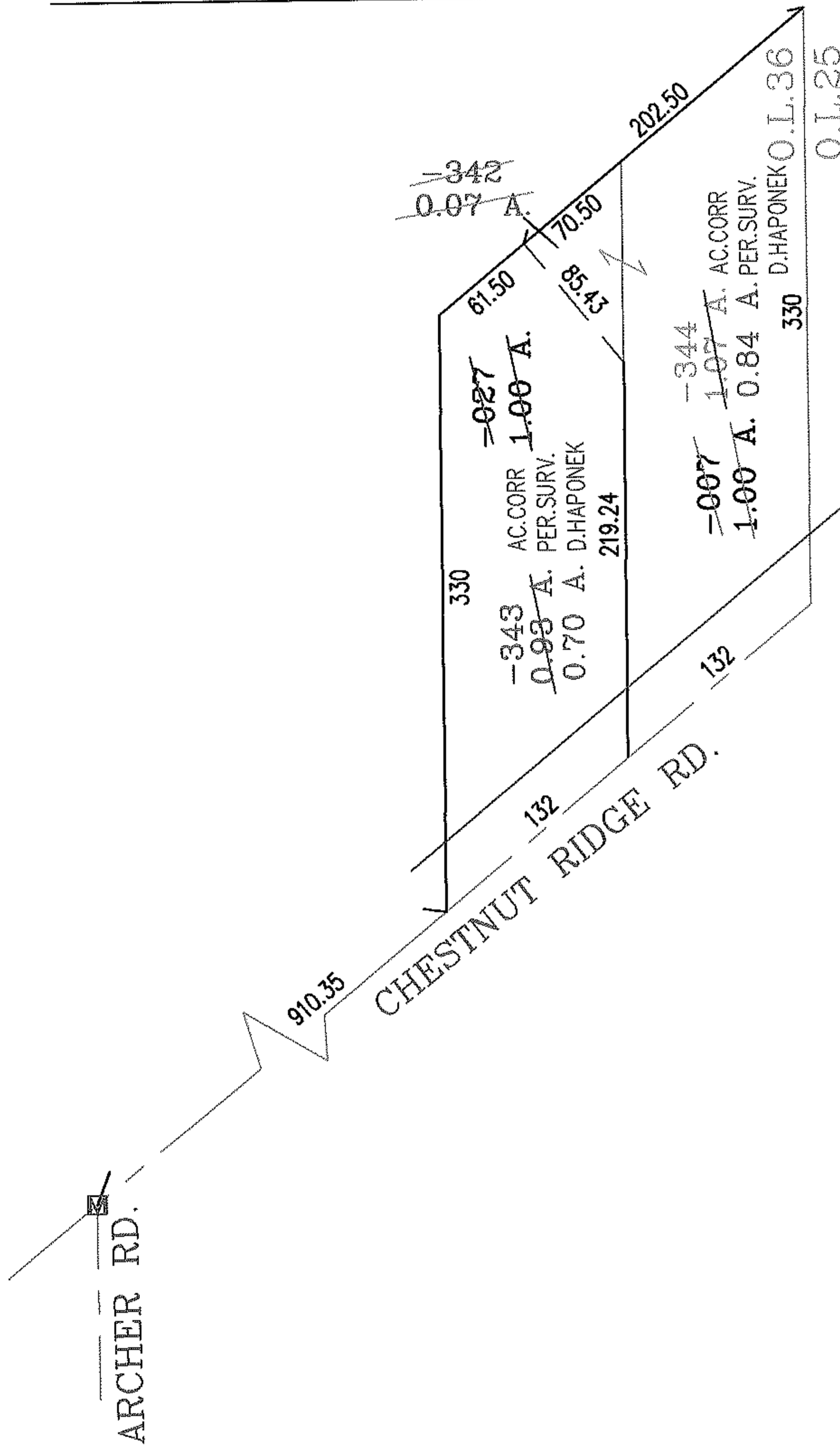

SPLITS/DEEDS PROCESSED
 LORAIN COUNTY TAX MAP DEPARTMENT
 226 MIDDLE AVE. ELYRIA, OHIO

SURVEYED BY: DANE A. HAPONEK
 CLOSURE: .00:10,000
 MAP PAGE(S): 7-00-036-D
 APPROVED BY: RRM DATE: 10/18/06
 SCALE: 1" = 100 PRIOR INSTRUMENT: 20040022292