

RASTER

PARENT PARCEL: 07-00-018-106-065

CHILD PARCEL:

STARTING POINT: S/L'S 50-52 IN BLOCK "V" IN CLEVELAND ROAD HOMESITE ALLOT.(VOL. 10 PG.27)

11-02199-C

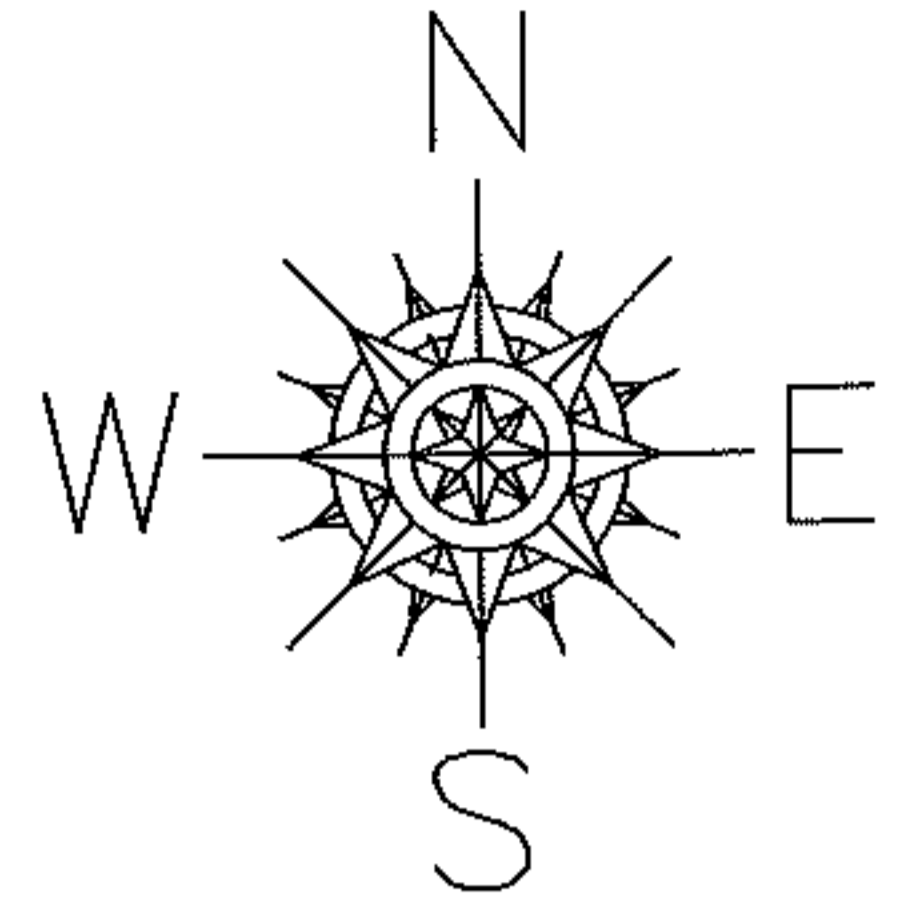

CORNELL AVE.

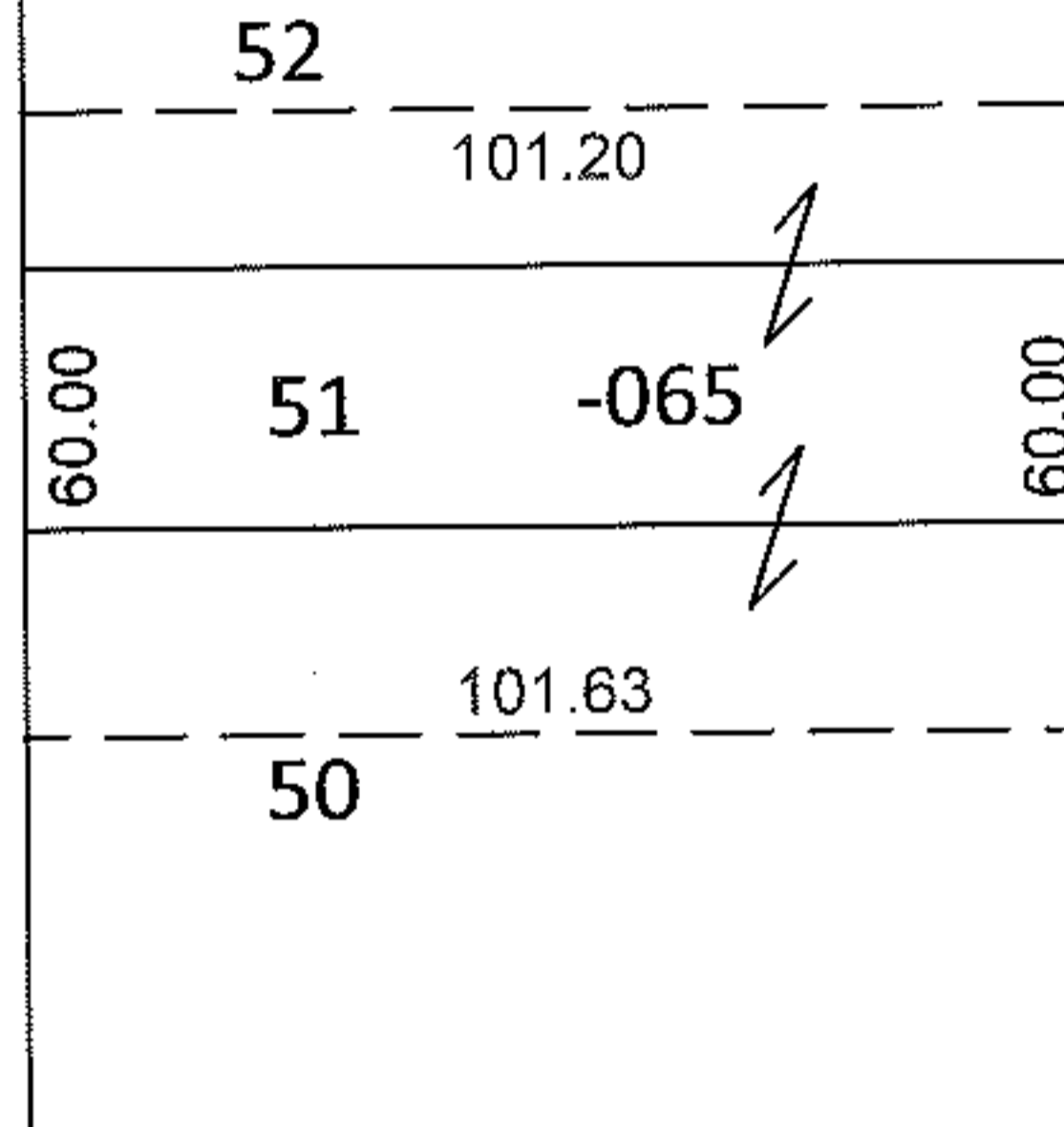

DEPTH CORRECTION

07-00-018-106-065

101.63

60 X 102

PER PRIOR DEEDS

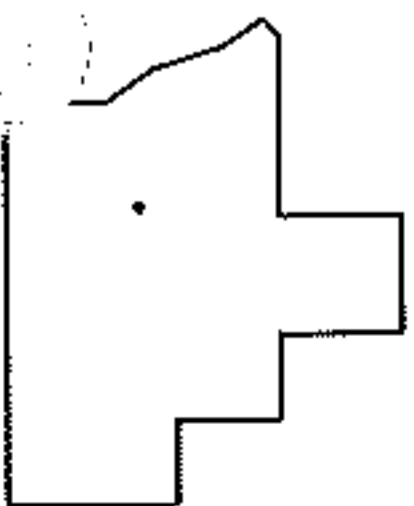

SPLITS/DEEDS PROCESSED

LORAIN COUNTY TAX MAP DEPARTMENT
226 MIDDLE AVE. ELYRIA, OHIO

SURVEYED BY: N/A

CLOSURE: N/A

MAP PAGE(S): 7-00-018-D

APPROVED BY: RRM DATE: 2-18-11

SCALE: 1"= 50' PRIOR INST.: 2005086495