

RASTER

PARENT PARCEL: 02-02-015-109-005

CHILD PARCEL: XX-XX-XXX-XXX-XXX

STARTING POINT: XXXXXX

11-02194-C

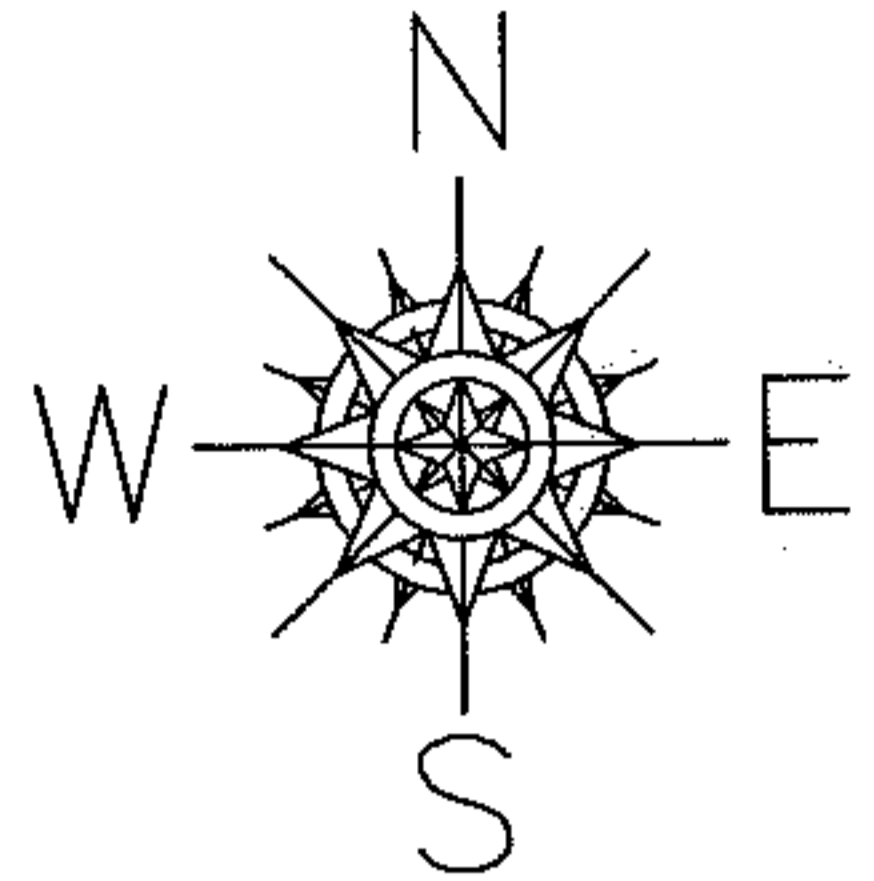

MAP CORRECTION ONLY

DIMENSION CORRECTION PER
PLAT VOL. 15 PG. 25

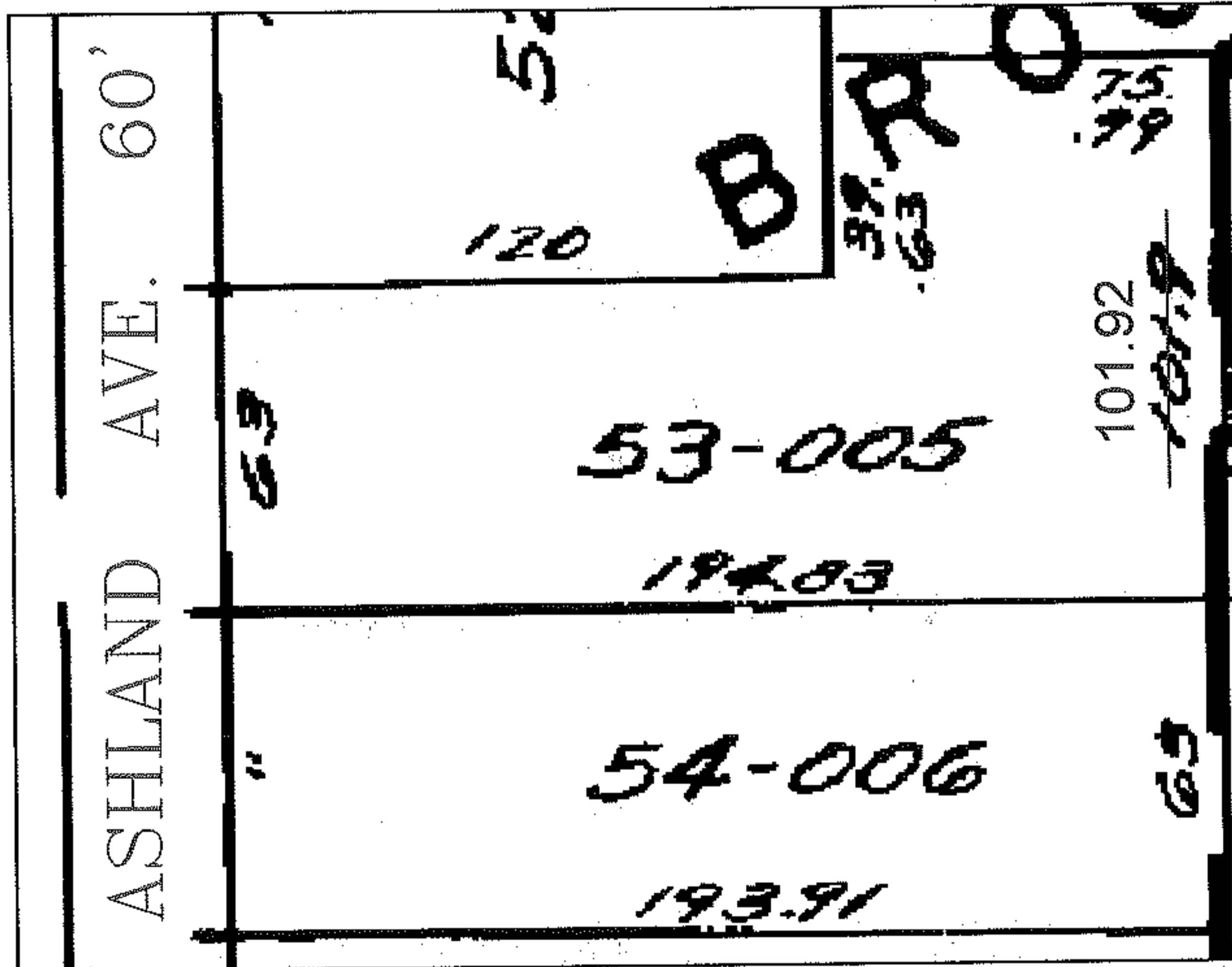

SPLITS/DEEDS PROCESSED

LORAIN COUNTY TAX MAP DEPARTMENT
226 MIDDLE AVE. ELYRIA, OHIO

SURVEYED BY: RAY E. HOLLIS

CLOSURE: 0.00: 10,000

MAP PAGE(S): 02-02-015-B

APPROVED BY: TJS DATE: 1/11/11

SCALE: 1"= 50' PRIOR INST.: PV 15 PG. 25