

RASPER

PARENT PARCEL: 11-00-077-000-060

11-02192-C

CHILD PARCEL: _____

STARTING POINT: INTERSECTION OF NORTH LINE OF CAPEL RD. AND EAST LINE OF DURKEE RD.

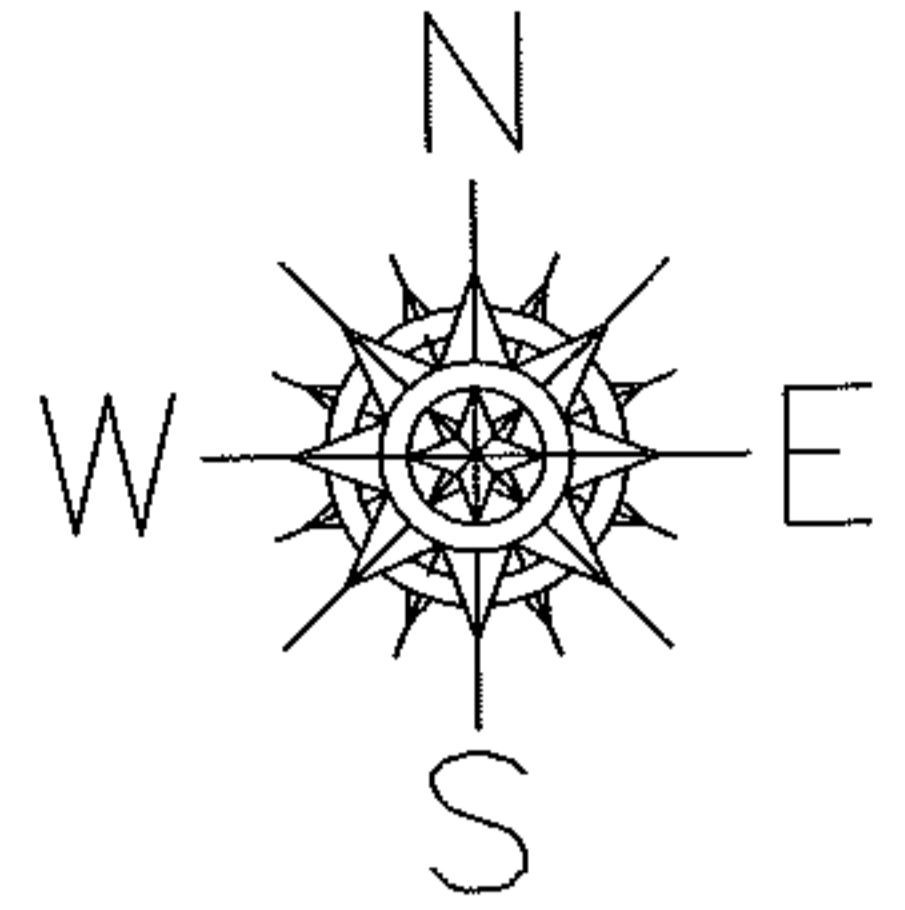

MAP CORRECTION ONLY

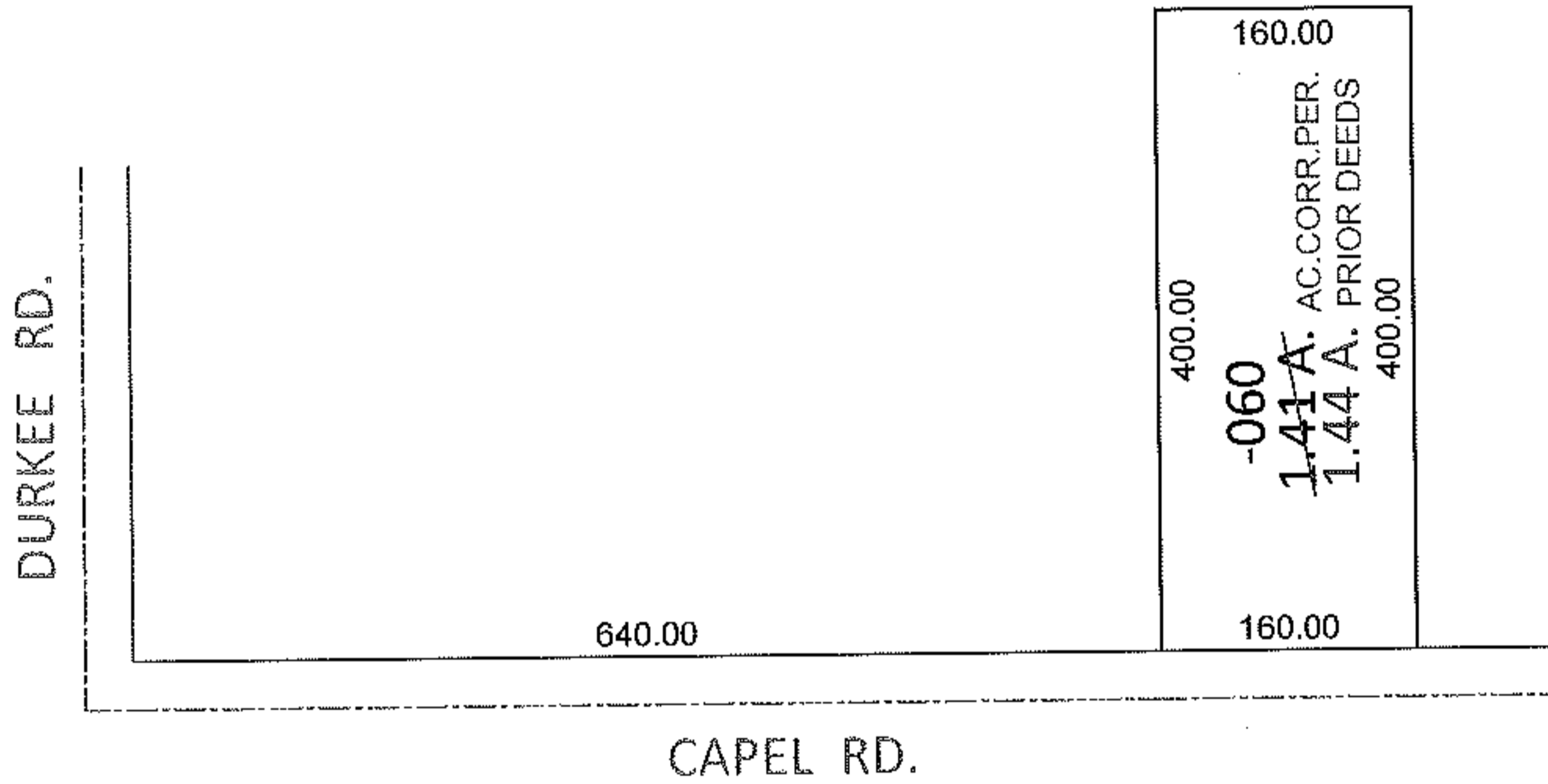

ACREAGE CORRECTION

PER PRIOR DEEDS
OR 20/249
DV 1144/644
DV 1038/602

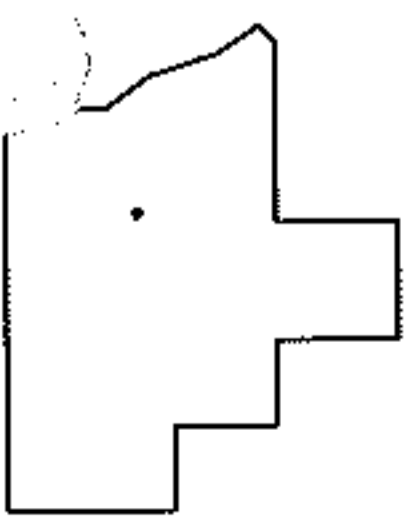

SPLITS/DEEDS PROCESSED

LORAIN COUNTY TAX MAP DEPARTMENT
226 MIDDLE AVE. ELYRIA, OHIO

SURVEYED BY: N/A

CLOSURE: N/A

MAP PAGE(S): 11-00-077-A

APPROVED BY: RRM DATE: 2-18-11

SCALE: 1" = 200 PRIOR INST.: SEE ABOVE