

PARENT PARCEL: 06-24-026-115-041

CHILD PARCEL: 06-24-026-115-045, -046

STARTING POINT: S/L 79 AND PART OF S/L 78 IN J & C SCHAIBLE'S ALLOT. (VOL.8 PG.22)

11-02182-U

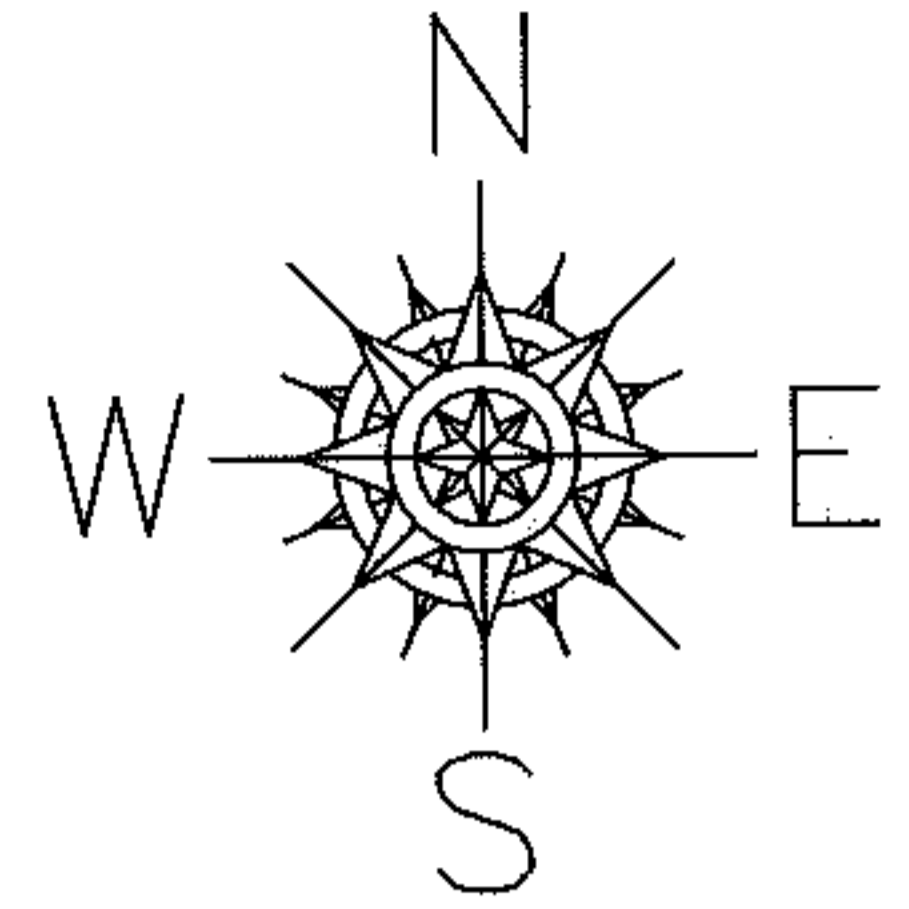

UNCOMBINATION

PER PRIOR DEEDS  
20000683766  
20000695998

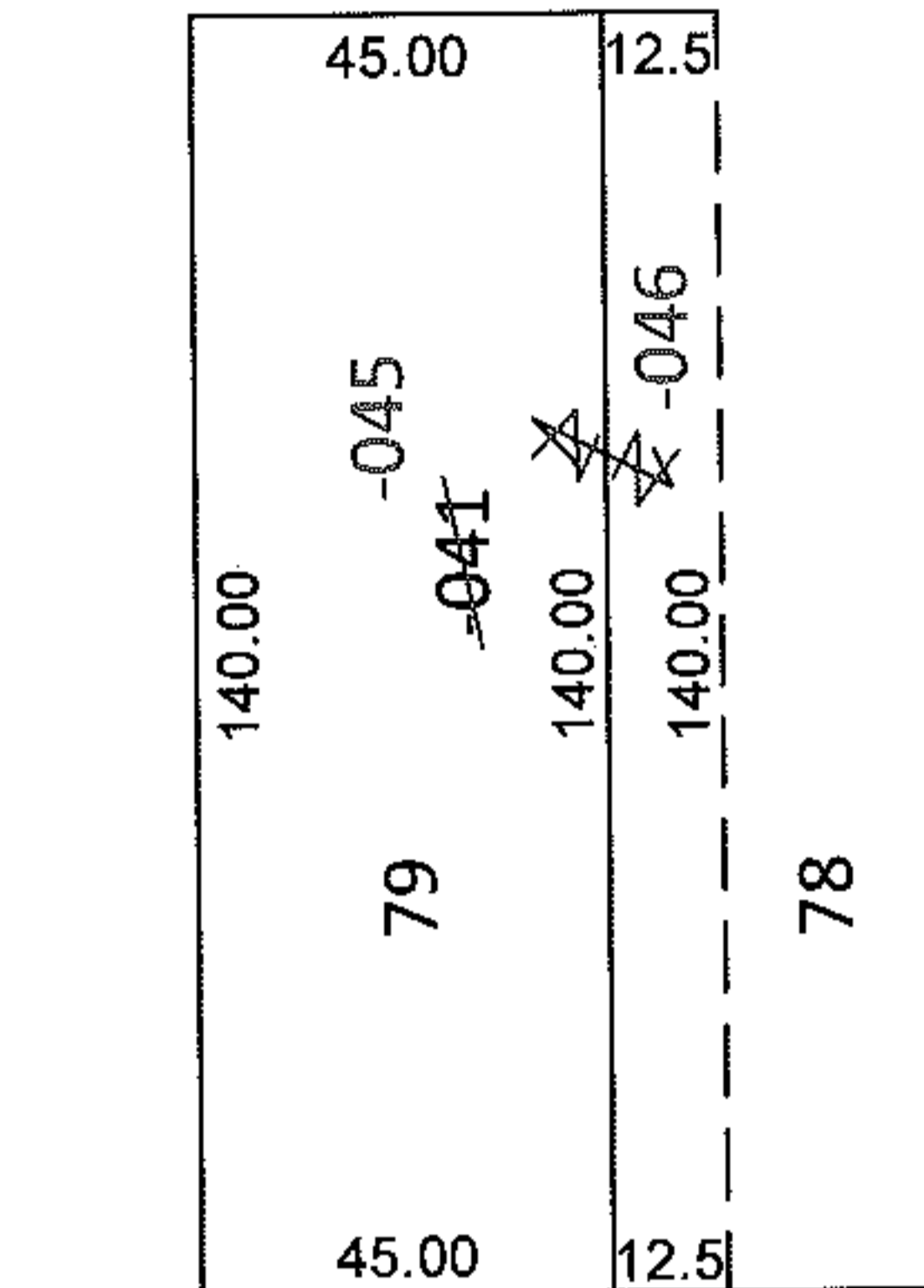

LOWELL ST.

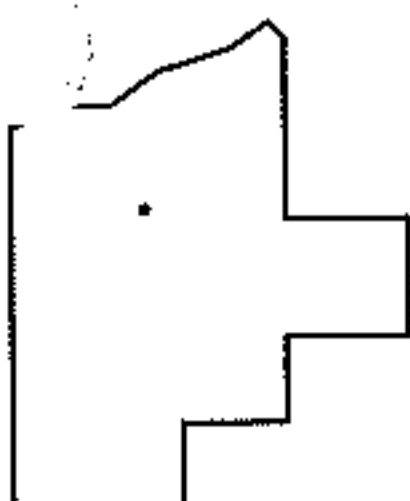

SPLITS/DEEDS PROCESSED

LORAIN COUNTY TAX MAP DEPARTMENT  
226 MIDDLE AVE. ELYRIA, OHIO

SURVEYED BY: N/A

CLOSURE: N/A

MAP PAGE(S): 6-97

APPROVED BY: RRM DATE: 1-5-11

SCALE: 1"= 50' PRIOR INST.: SEE ABOVE