

RASTER

PARENT PARCEL: 06-24-064-101-022  
CHILD PARCEL:  
STARTING POINT: S/L 13 IN C.H. HEIGHTEN'S ADD. (VOL.4 PG. 19)

10-02162-C

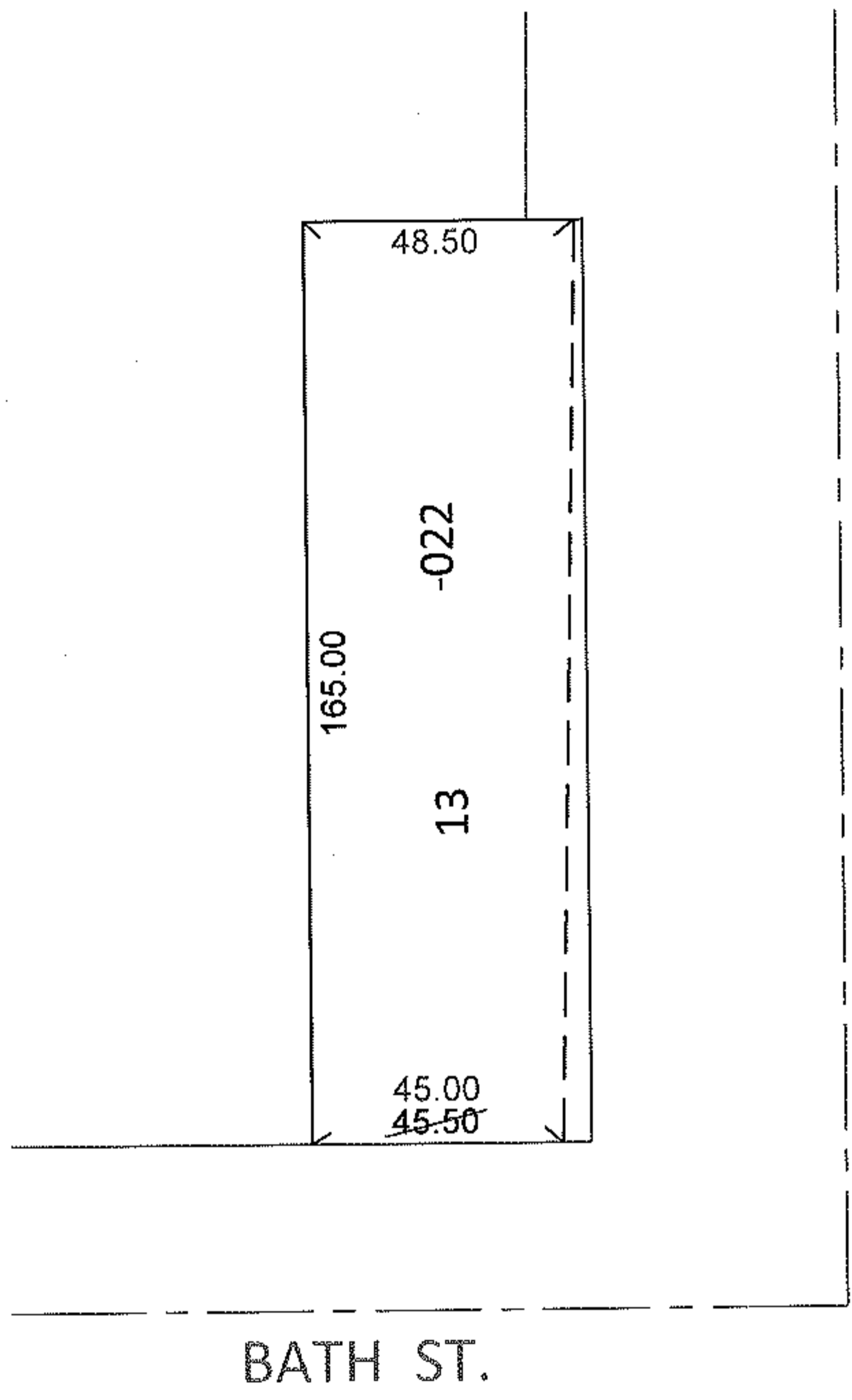
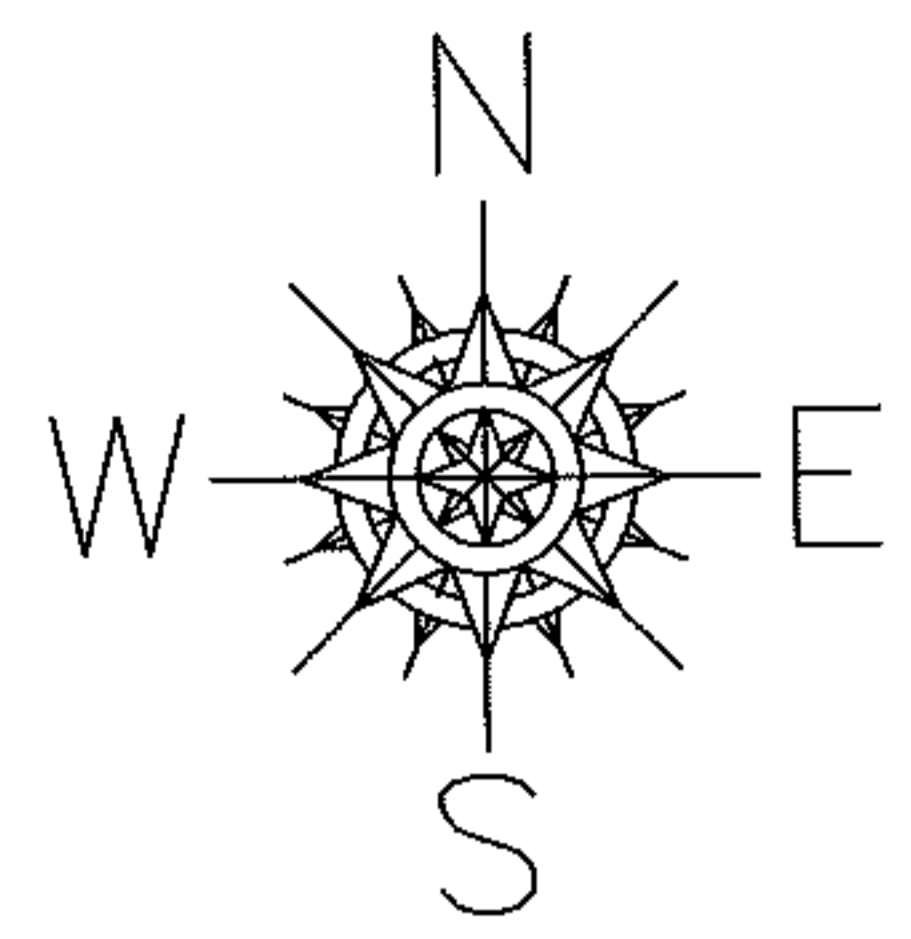

FRONTAGE CORRECTION

06-24-064-101-022  
45.00  
~~45.50~~ X 165

CORR. PER PRIOR DEEDS

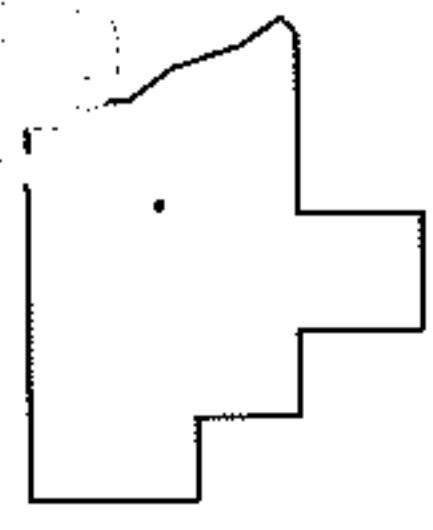

SPLITS/DEEDS PROCESSED  
LORAIN COUNTY TAX MAP DEPARTMENT  
226 MIDDLE AVE. ELYRIA, OHIO

SURVEYED BY: N/A  
CLOSURE: N/A  
MAP PAGE(S): 6-81  
APPROVED BY: RRM DATE: 3-16-11  
SCALE: 1" = 50' PRIOR INST.: 20030967886