

PARENT PARCEL: 16-00-039-000-005

CHILD PARCEL: _____

10-02161-C

STARTING POINT: INTERSECTION OF C/L OF CHAMBERLAIN RD. AND SOUTH LINE OF O.L.39

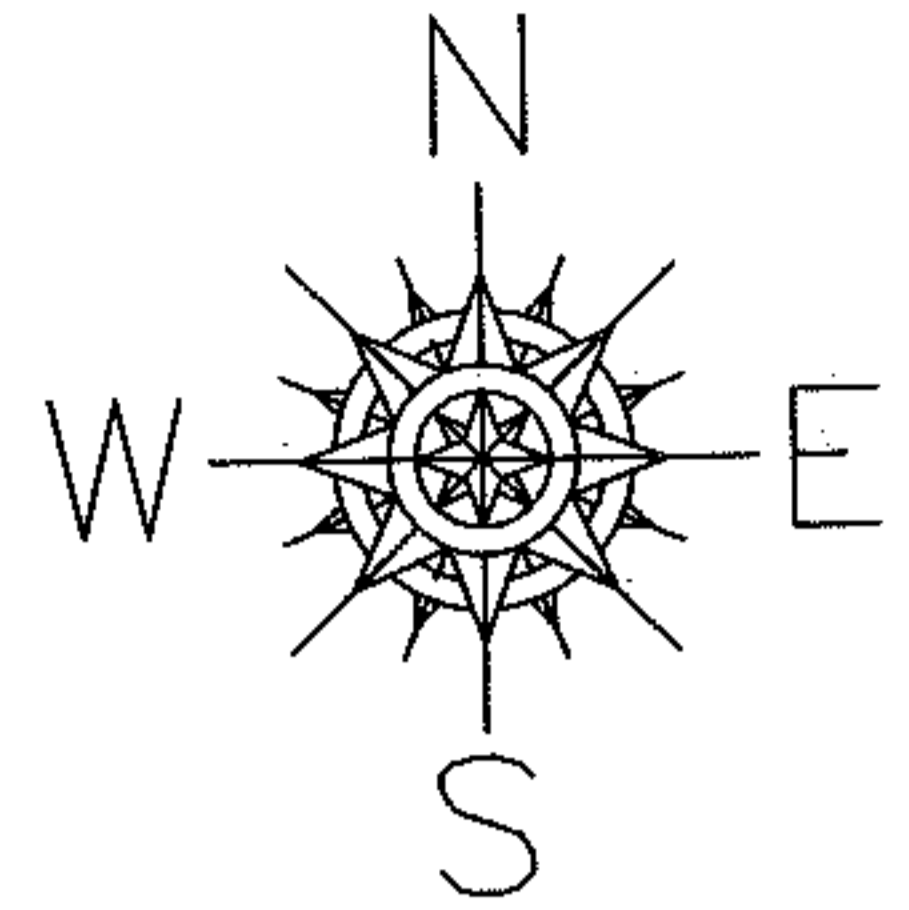

CHAMBERLAIN RD.

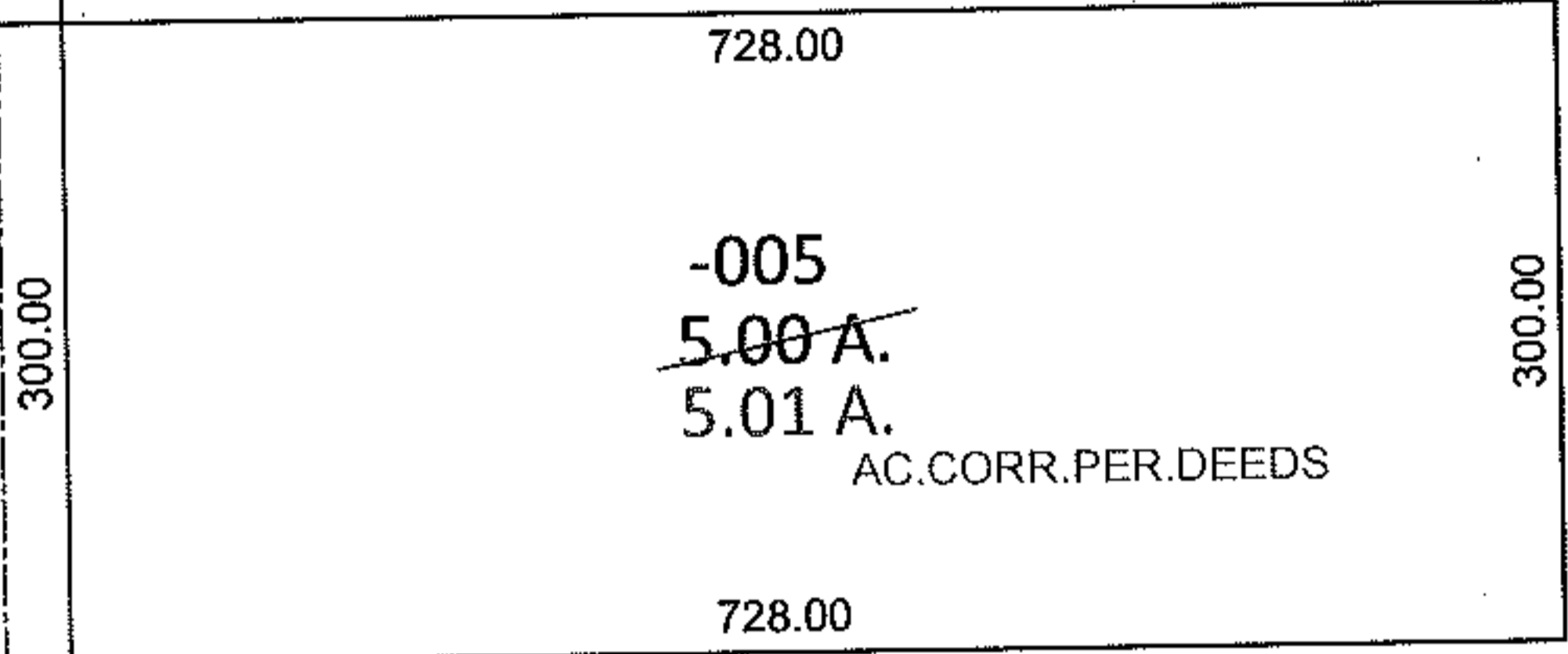

300.00

728.00

-005

~~5.00 A.~~

5.01 A.

AC. CORR. PER. DEEDS

300.00

728.00

1014.50

O.L.39

O.L.41

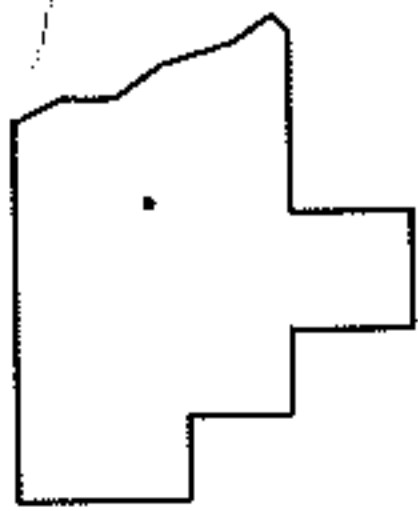

SPLITS/DEEDS PROCESSED

LORAIN COUNTY TAX MAP DEPARTMENT
226 MIDDLE AVE. ELYRIA, OHIO

SURVEYED BY: N/A

CLOSURE: N/A

MAP PAGE(S): 16-A

APPROVED BY: RRM DATE: 1-3-11

SCALE: 1" = 200 PRIOR INST.: 20080246259