

PARENT PARCEL: 06-25-078-104-012, -013

CHILD PARCEL: _____

STARTING POINT: INTERSECTION OF NORTH LINE OF BROAD ST. AND WEST LINE OF SUMMER ST.

10-02133-C

DEPTH & MAP CORRECTION

06-25-078-104-012
40.75 X 132
~~40.75 X~~

06-25-078-104-013
40.75 X 127
~~40.75 X~~

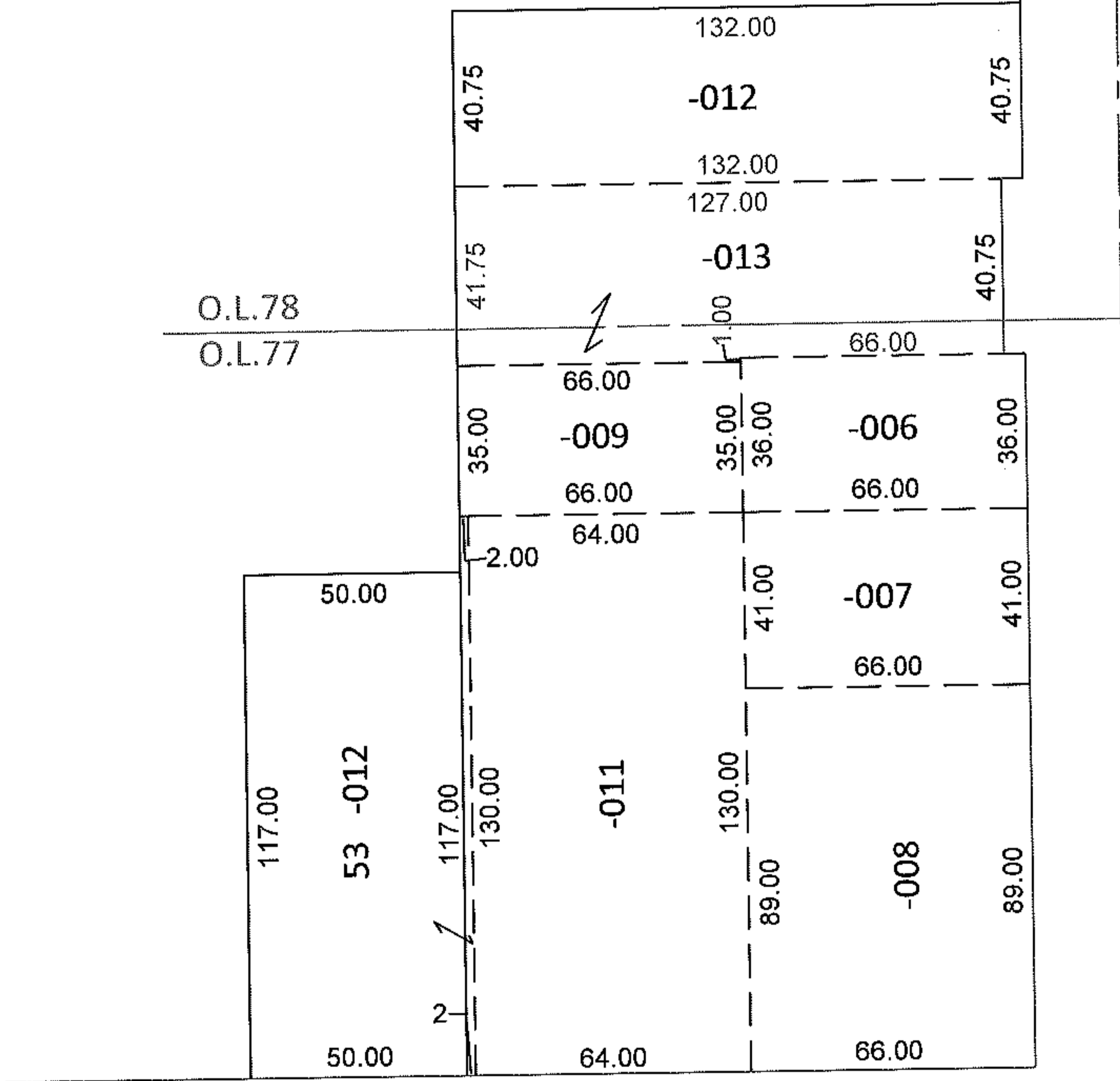
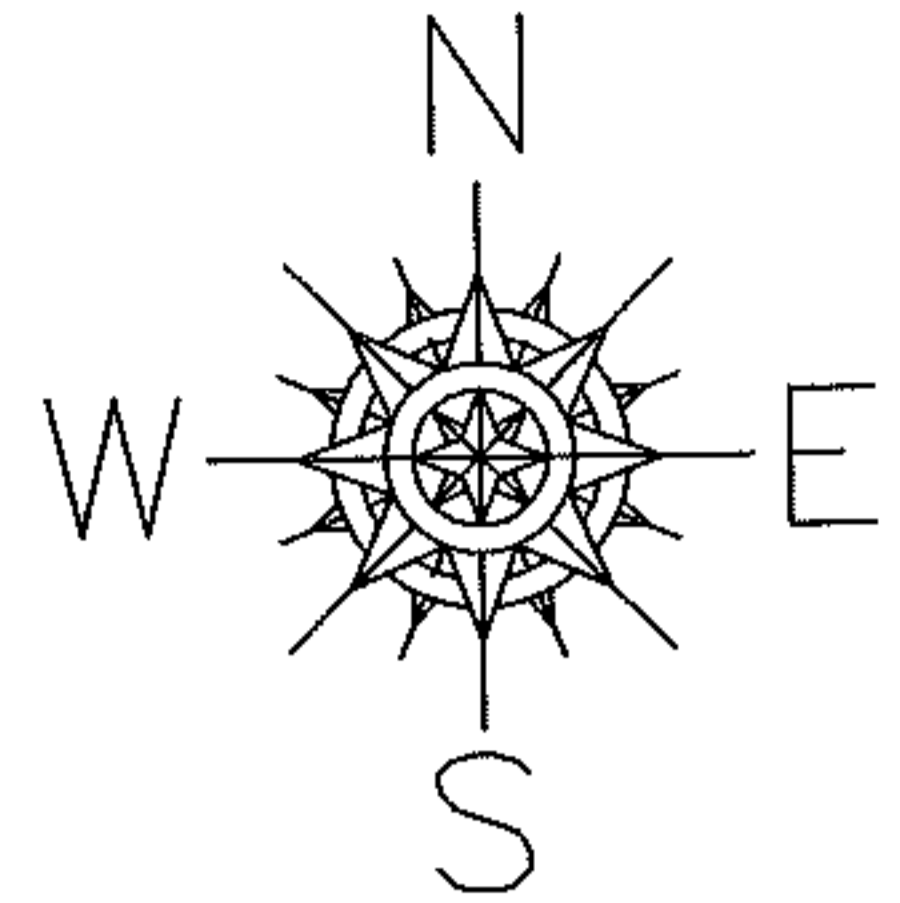

*OR 145/312
*OR 1011/451

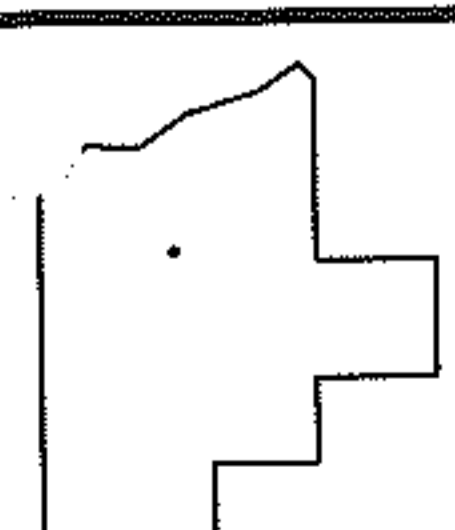

SPLITS/DEEDS PROCESSED

LORAIN COUNTY TAX MAP DEPARTMENT
226 MIDDLE AVE. ELYRIA, OHIO

SURVEYED BY: N/A
CLOSURE: N/A
MAP PAGE(S): 6-122
APPROVED BY: RRM DATE: 11-23-10
SCALE: 1"= 50' PRIOR INST.: *SEE ABOVE*