

PARENT PARCEL: 21-05-005-000-002

CHILD PARCEL: _____

STARTING POINT: INTERSECTION OF C/L OF BURSLEY RD, AND C/L OF S.R.58

10-02132-D

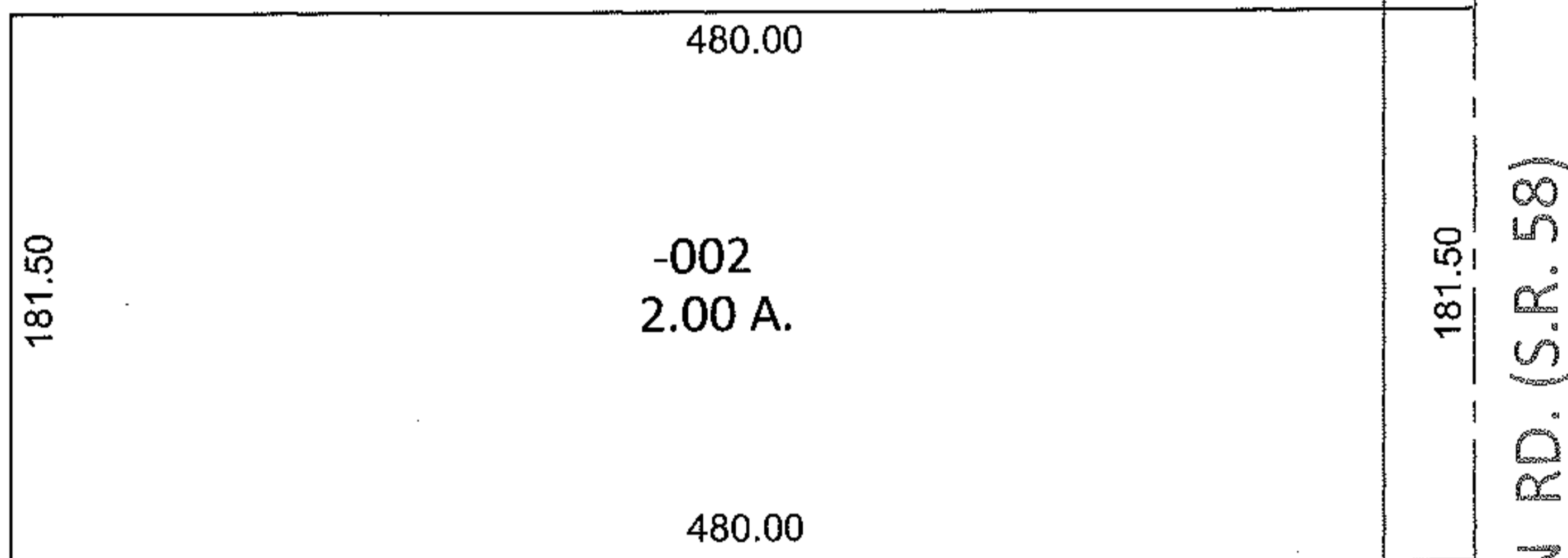
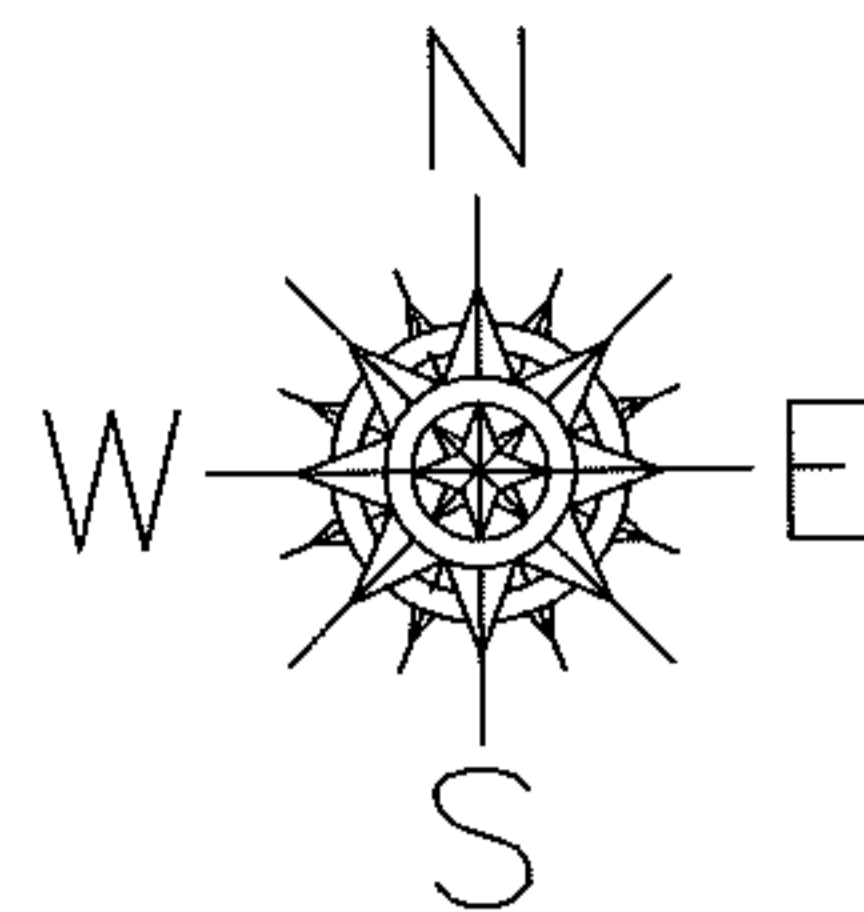

NO MAP CHANGES

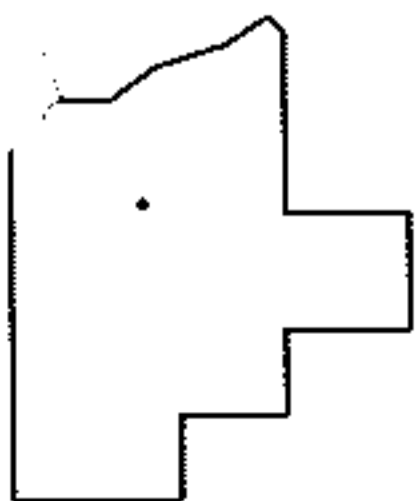

SPLITS/DEEDS PROCESSED

LORAIN COUNTY TAX MAP DEPARTMENT
226 MIDDLE AVE. ELYRIA, OHIO

SURVEYED BY: EDWARD B. DUDLEY

CLOSURE: .00:10,000

MAP PAGE(S): 21-B

APPROVED BY: RRM DATE: 11-19-10

SCALE: 1" = 100 PRIOR INST.: 20100338179