

RASTER

PARENT PARCEL: 15-00-015-000-013,-014
CHILD PARCEL: 15-00-015-000-015 THRU -017
STARTING POINT: SOUTHWEST CORNER OF O.L. 15 AND C/L OF LAGRANGE RD.(S.R. 301)

05-02074

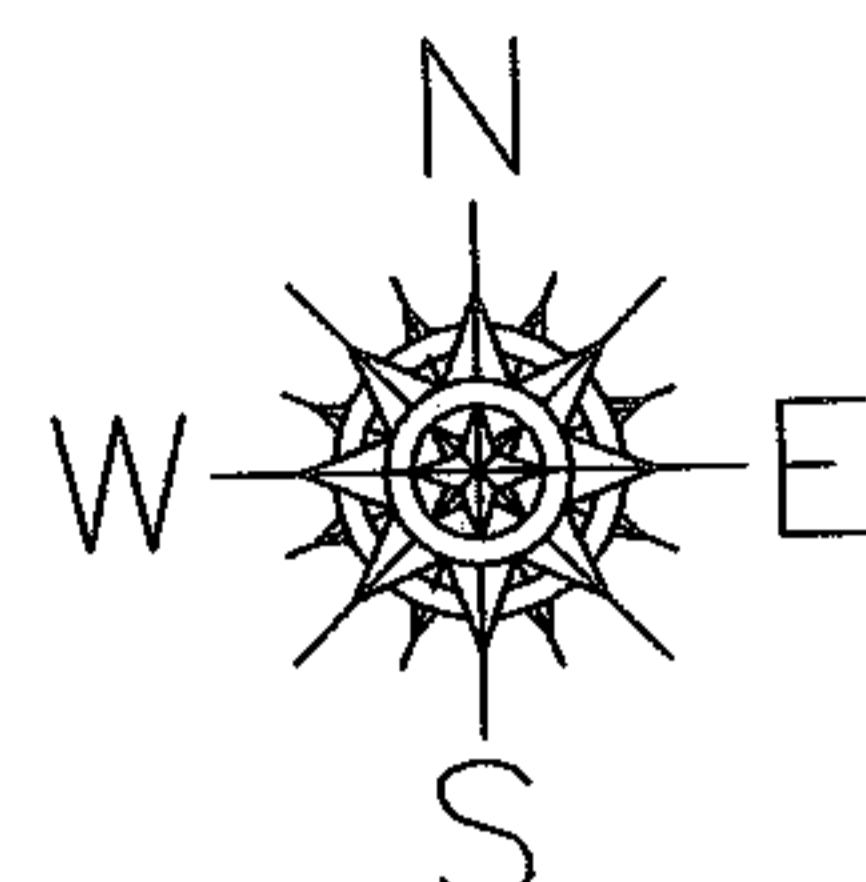
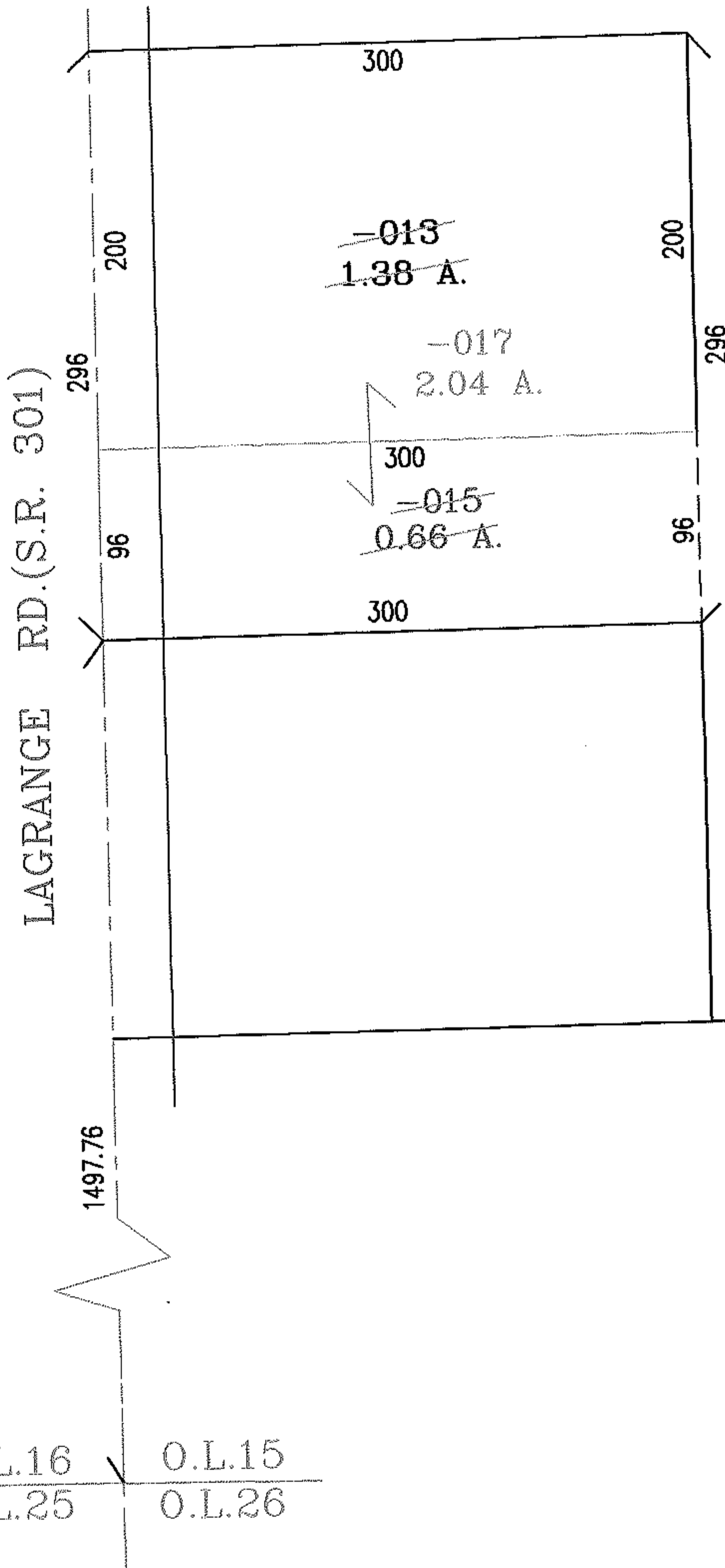

SPLITS/DEEDS PROCESSED

LORAIN COUNTY TAX MAP DEPARTMENT
226 MIDDLE AVE. ELYRIA, OHIO

SURVEYED BY: RICHARD D. CARLSON
CLOSURE: .00:10.000
MAP PAGE(S): 15-C
APPROVED BY: RRM DATE: 12-30-05
SCALE: 1" = 100 PRIOR INSTRUMENT: 20020806694