

RASTER

PARENT PARCEL: 07-00-007-127-021,-022

CHILD PARCEL: 07-00-007-127-065

STARTING POINT: S/L 25 & 26 IN SECTION O OF RIDGEVILLE HEIGHTS SUB.(VOL.10 PGS.11-12)

10-02067-C

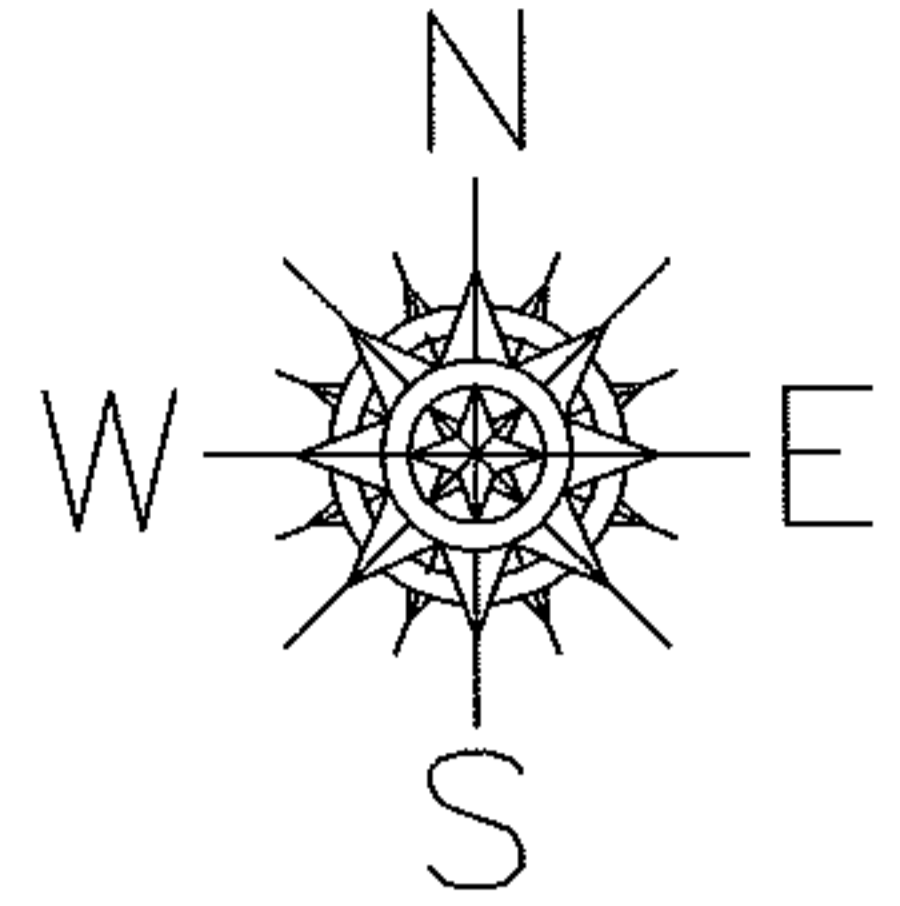

COMBINATION CORRECTION

PER. MARK STEWART

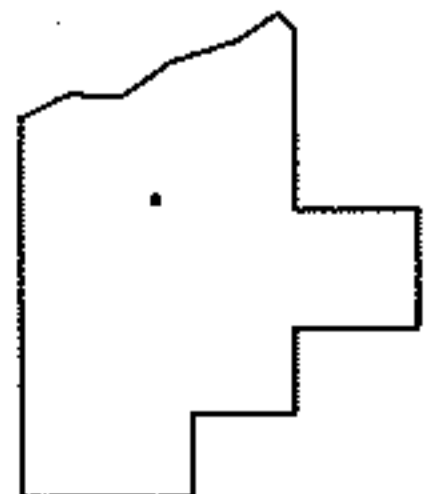
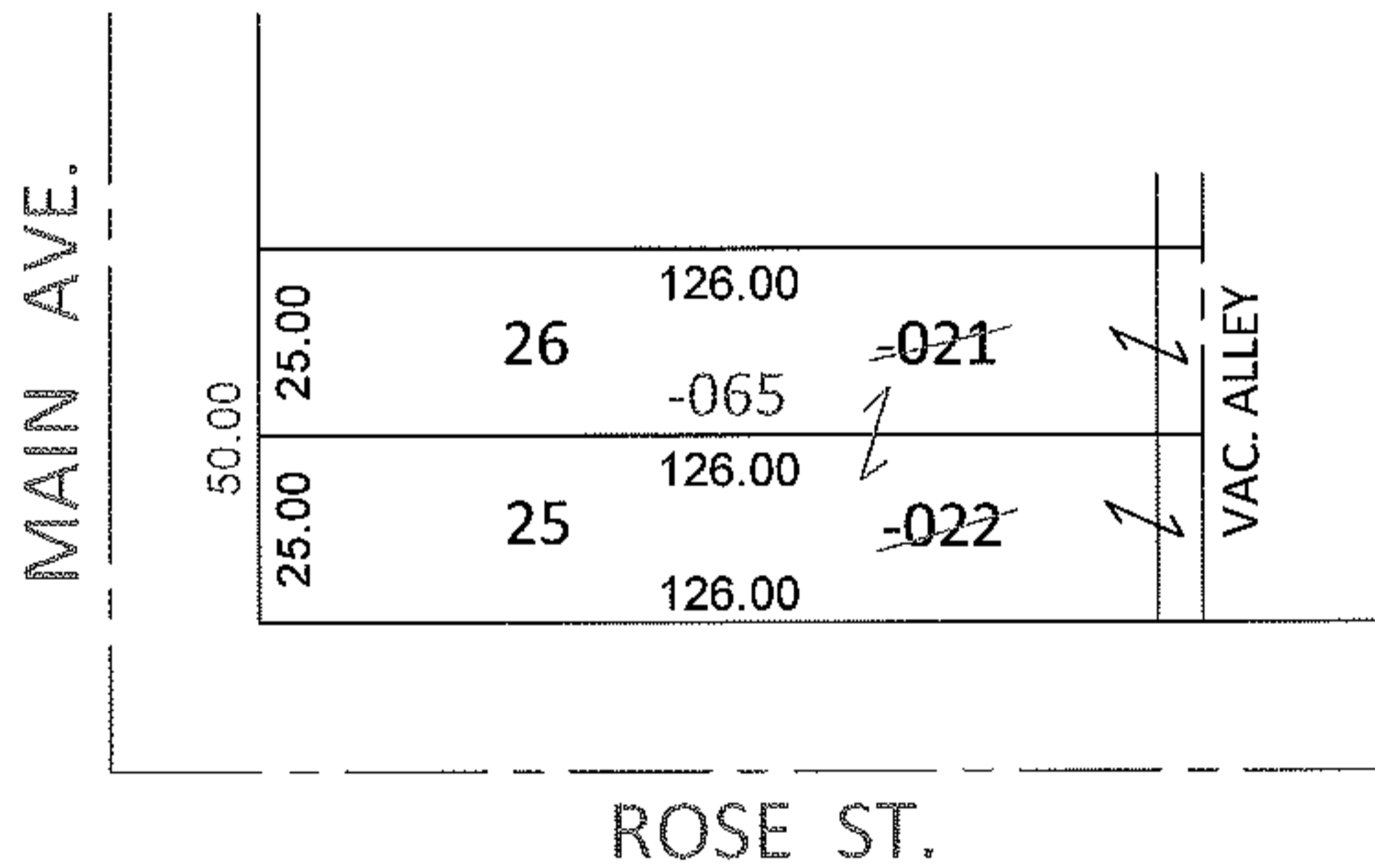

SPLITS/DEEDS PROCESSED

LORAIN COUNTY TAX MAP DEPARTMENT
226 MIDDLE AVE. ELYRIA, OHIO

SURVEYED BY: N/A

CLOSURE: N/A

MAP PAGE(S): 7-00-007-D

APPROVED BY: RRM DATE: 8-18-10

SCALE: 1"= 50' PRIOR INST.: 20060126361