

PARENT PARCEL: 06-24-022-900-001

CHILD PARCEL: 06-24-022-900-002, -003

STARTING POINT: N/A

10-02020-U

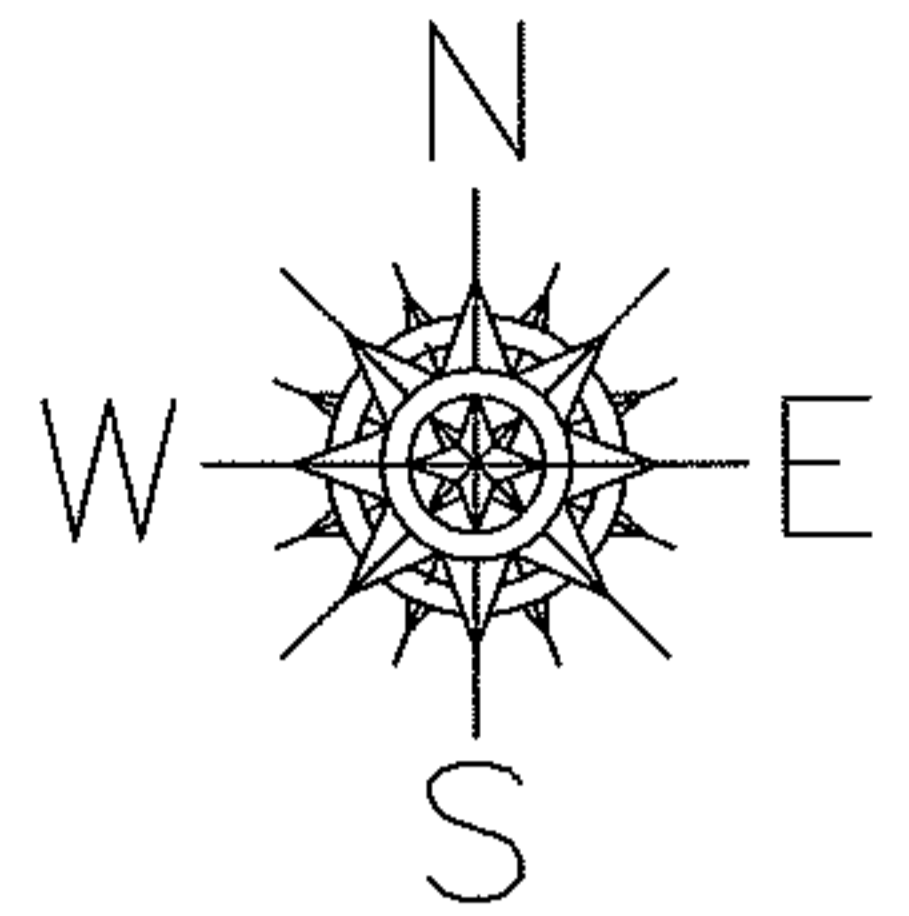
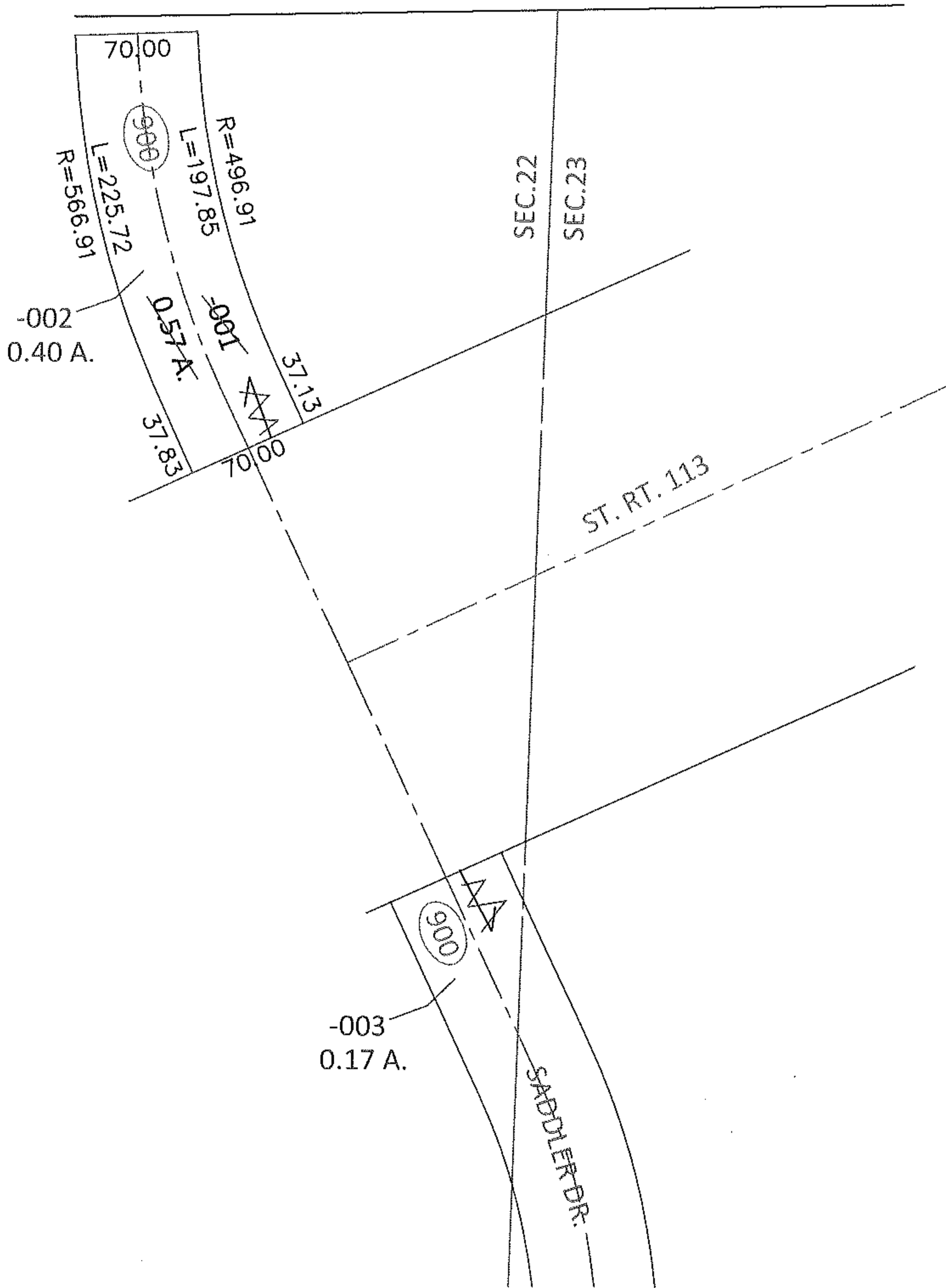

SPLITS/DEEDS PROCESSED

LORAIN COUNTY TAX MAP DEPARTMENT
226 MIDDLE AVE. ELYRIA, OHIO

SURVEYED BY: MICHAEL G. HURA

CLOSURE: .01:10,000

MAP PAGE(S): 6-76

APPROVED BY: RRM DATE: 4/21/10

SCALE: 1"= 100 PRIOR INST.: VOL.25 PG.9