

RASTER

PARENT PARCEL: 06-25-063-000-006

CHILD PARCEL: 06-25-063-000-009 THRU -011

STARTING POINT: RIGHT OF WAY LINE OF RIDGE RD. & O.L. 63

NO. 01100

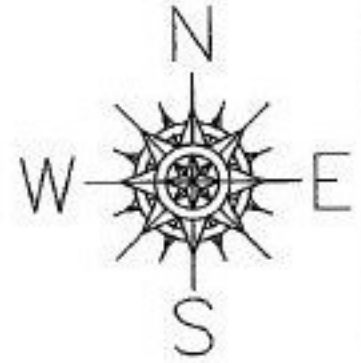

— RIDGE ST. —

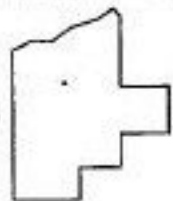
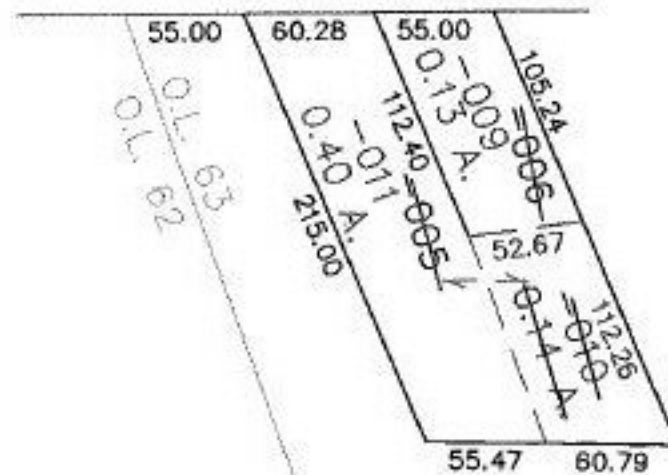

SPLITS/DEEDS PROCESSED

LORAIN COUNTY TAX MAP DEPARTMENT
226 MIDDLE AVE. ELYRIA, OHIO

SURVEYED BY: DOUG MOSLEY

CLOSURE: 0.00 : 10.000

MAP PAGE(S): 6-103

APPROVED BY: JAH DATE: 6-6-02

SCALE: 1" = 100' PRIOR INSTRUMENT: OR 404/779