

RASTER

PARENT PARCEL: 02-00-051-138-021

CHILD PARCEL: 02-00-051-138-032, -033

STARTING POINT: CENTERLINE OF COLORADO AVE. & LEHIGH RD.

NO. 01072

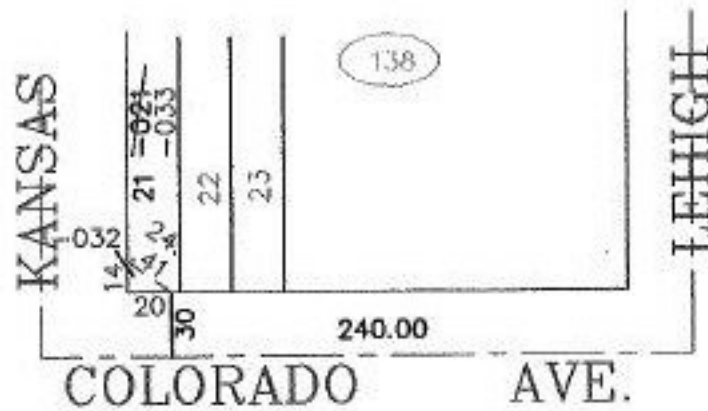

**SPLITS/DEEDS PROCESSED**

LORAIN COUNTY TAX MAP DEPARTMENT  
226 MIDDLE AVE. ELYRIA, OHIO

SURVEYED BY: BRIAN P. MCCARTNEY

CLOSURE: 0.00 : 10.000

MAP PAGE(S): 02-00-051-B

APPROVED BY: JAH DATE: 5-6-02

SCALE: 1" = 100' PRIOR INSTRUMENT: DV 580/32