

RASTER

PARENT PARCEL: 09-00-014-102-011

NO. 00778-A

CHILD PARCEL:

STARTING POINT: INTERSECTION OF C/L OF RUSSIA RD. AND C/L OF ANNIS RD.

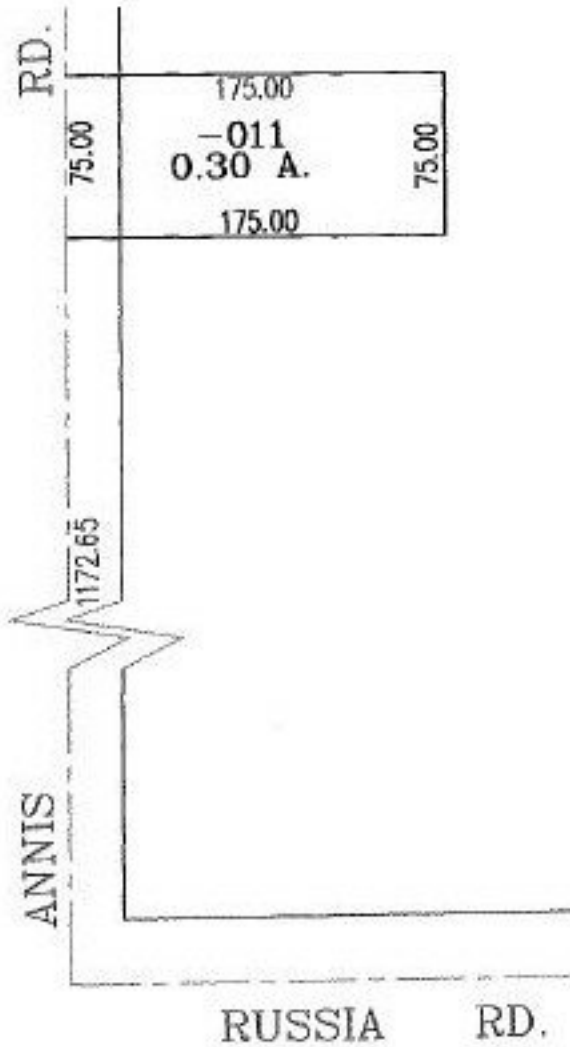

MAP CORR. ONLY

SPLITS/DEEDS PROCESSED

LORAIN COUNTY TAX MAP DEPARTMENT
226 MIDDLE AVE. ELYRIA, OHIO

SURVEYED BY: TIMOTHY E. STOCKER

CLOSURE: .00:10.000

MAP PAGE(S): 9-00-014-B

APPROVED BY: BRM DATE: 12-16-02

SCALE: 1" = 100' PRIOR INSTRUMENT: 20020828404