

RASTER

PARENT PARCEL: 14-00-124-000-004

CHILD PARCEL: 14-00-124-000-005, -006

STARTING POINT: CENTERLINE OF HAWLEY RD. & O.L. 124

NO. 01981

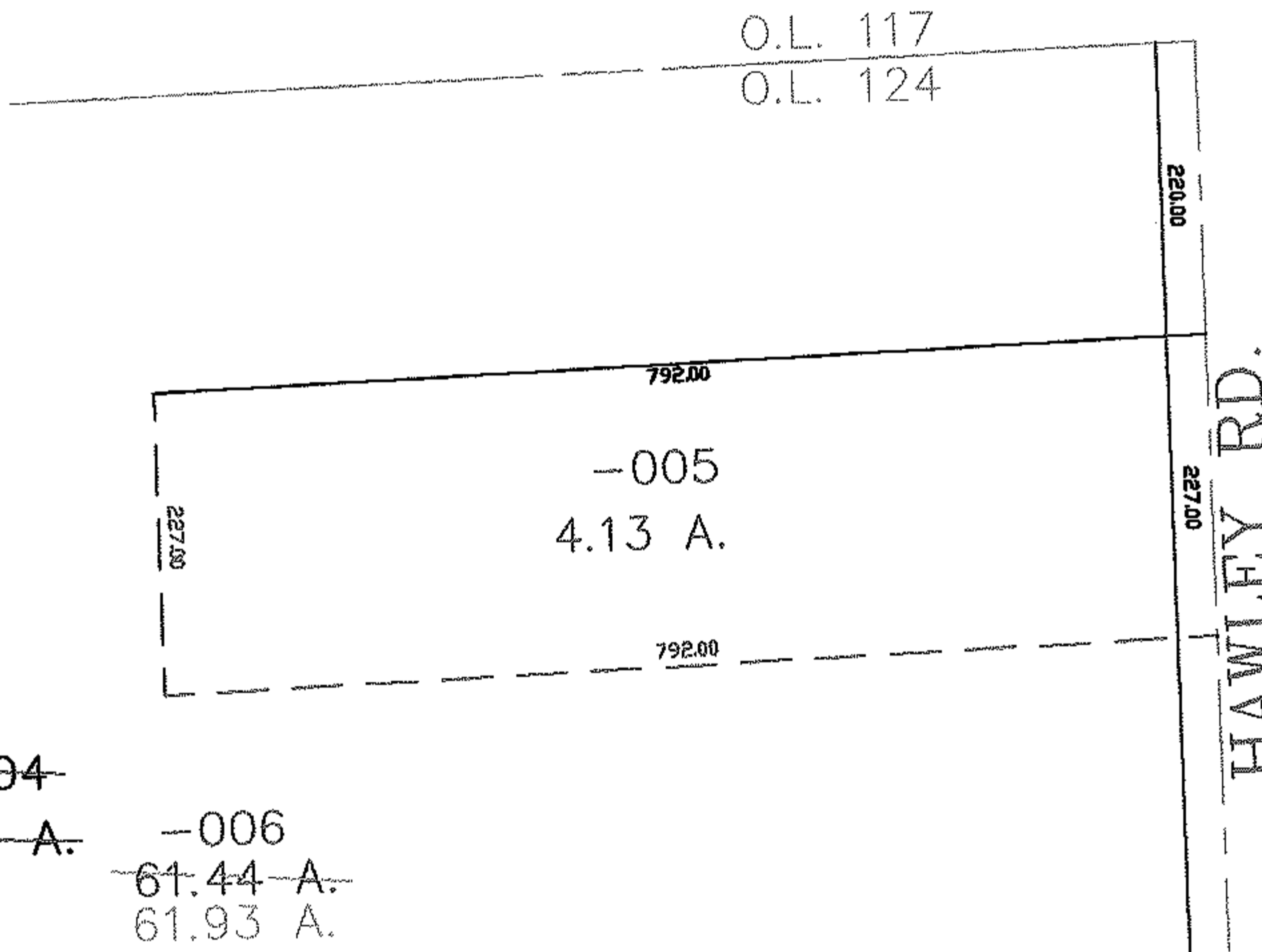
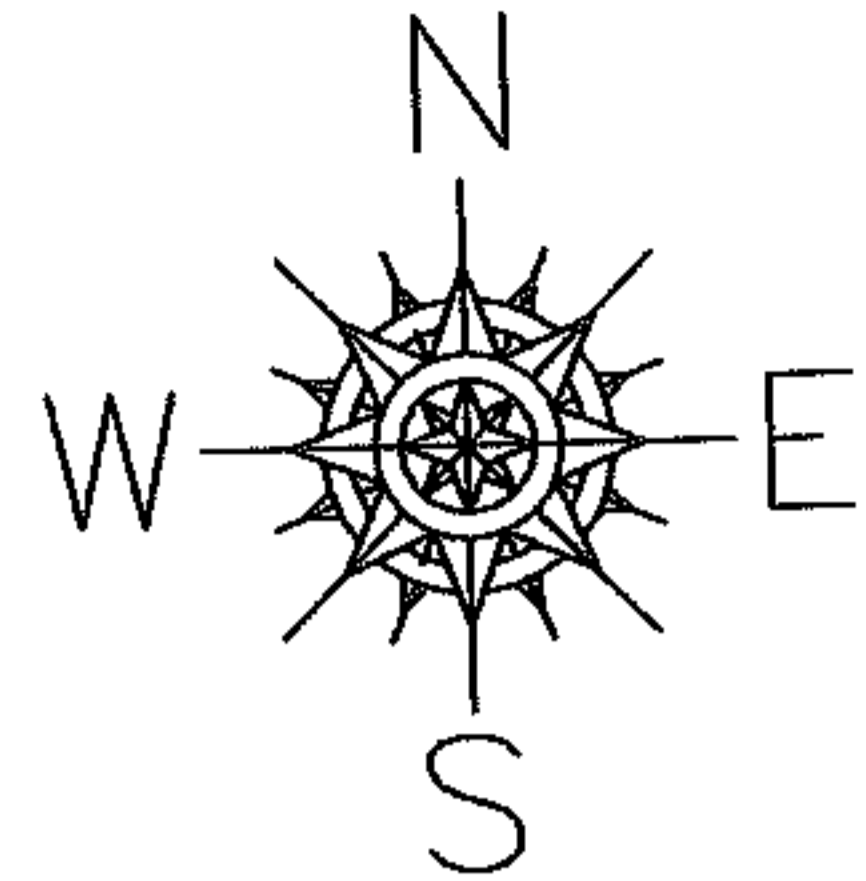

~~=004-~~  
~~65.57 A.~~     -006  
~~61.44 A.~~  
61.93 A.  
A. CORR. PER SURVEY  
RODGER SIMON

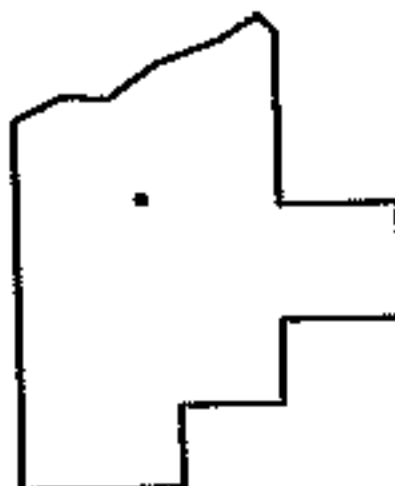

**SPLITS/DEEDS PROCESSED**  
LORAIN COUNTY TAX MAP DEPARTMENT  
226 MIDDLE AVE. ELYRIA, OHIO

SURVEYED BY: RODGER SIMON  
CLOSURE: 0.00 : 10.000  
MAP PAGE(S): 14-00-124-a  
APPROVED BY: JAH     DATE: 8-19-05  
SCALE: 1" = 200     PRIOR INSTRUMENT: 20000694132