

PARENT PARCEL: 02-01-006-111-037

10-01951-D

CHILD PARCEL: \_\_\_\_\_

STARTING POINT: INTERSECTION NORTH R.O.W. LINE OF W. 8TH ST. WITH THE WEST R.O.W. LINE OF HAMILTON AVE.

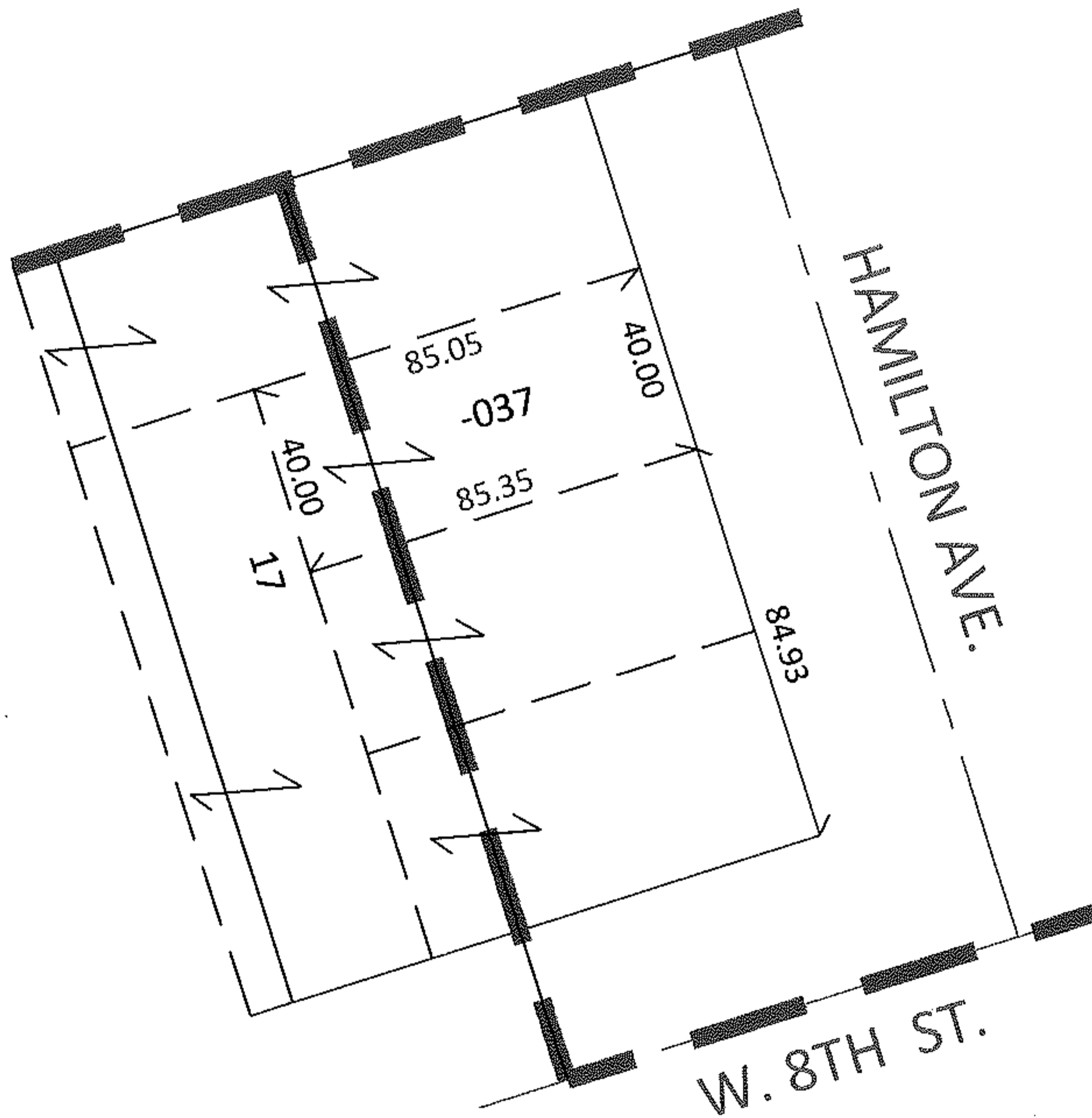
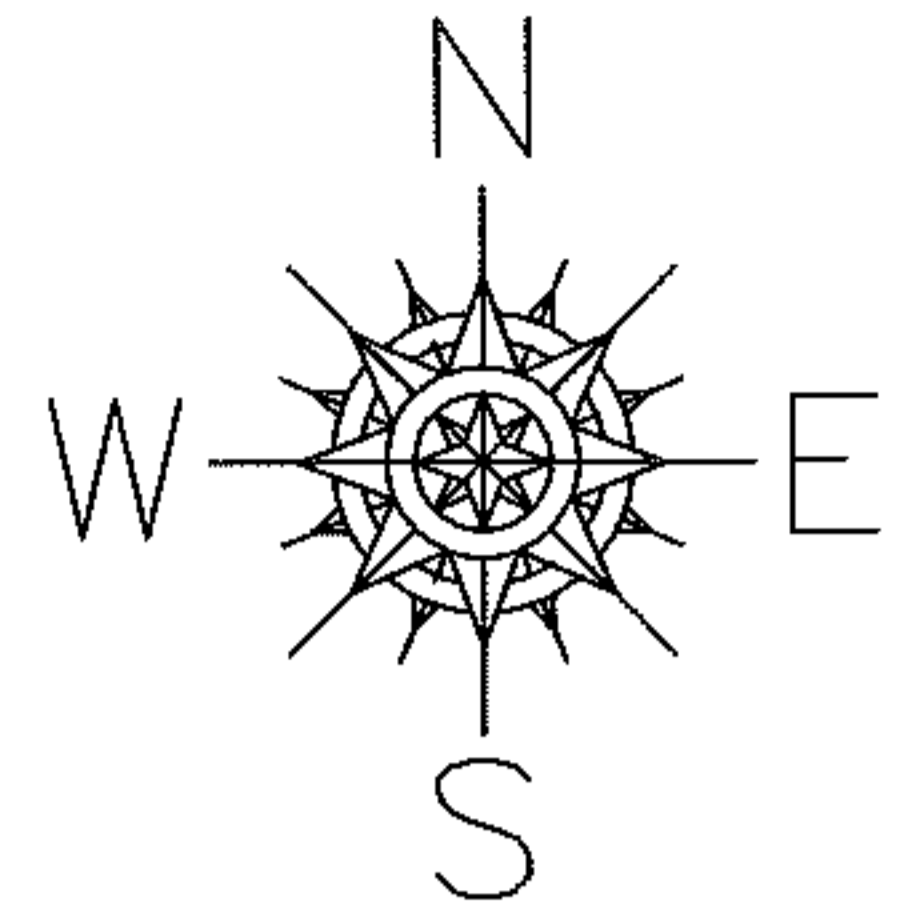

02-01-006-111-037  
REMOVE UPDATE LEGAL  
DEPTH CORRECTION  
40.00 X 85.35  
~~40.00 X 86.00~~

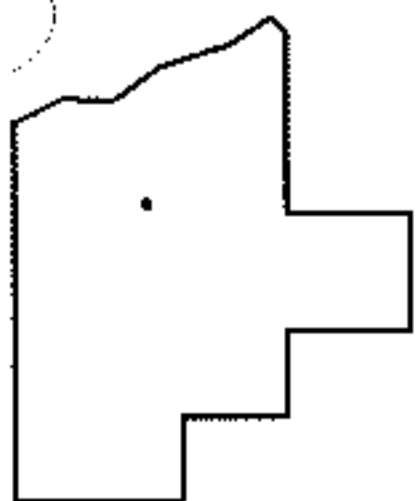

**SPLITS/DEEDS PROCESSED**

LORAIN COUNTY TAX MAP DEPARTMENT  
226 MIDDLE AVE. ELYRIA, OHIO

SURVEYED BY: N/A

CLOSURE: N/A

MAP PAGE(S): 2-01-006-B

APPROVED BY: RRM DATE: 1-26-10

SCALE: 1" = 50' PRIOR INST.: 20090318525