

RASTER

PARENT PARCEL: 07-00-046-108-046

CHILD PARCEL:

STARTING POINT: NORTHEAST CORNER OF 07-00-046-108-018

09-01888-D

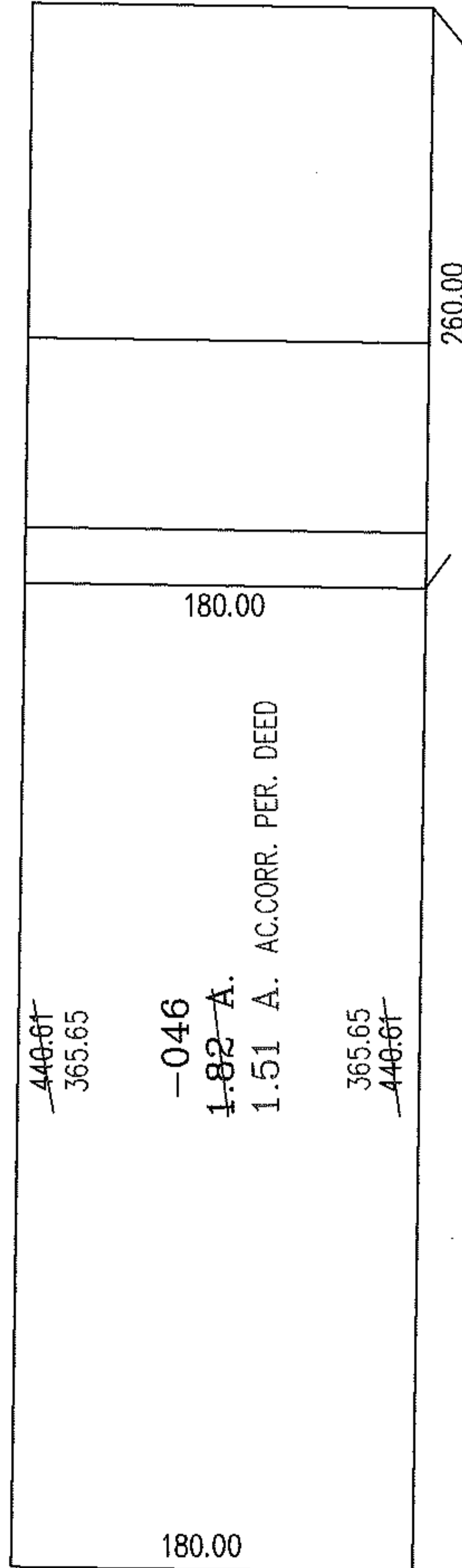
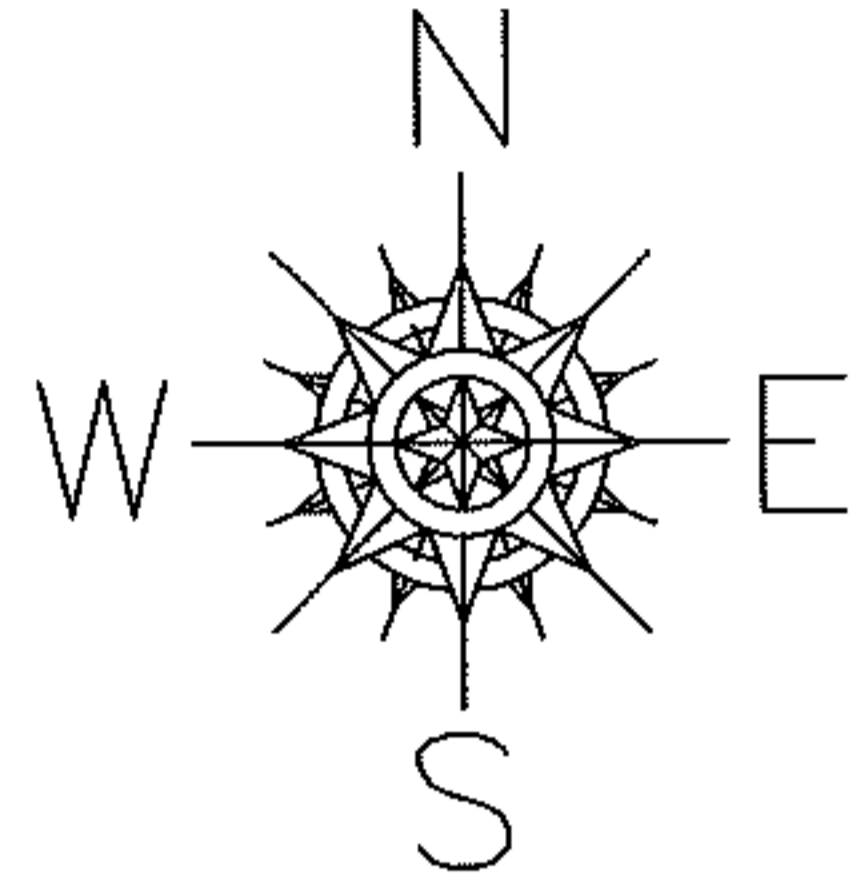

03-00805-A WAS INCORRECT IN ACREAGE AND DIMENSIONS DUE TO DEED

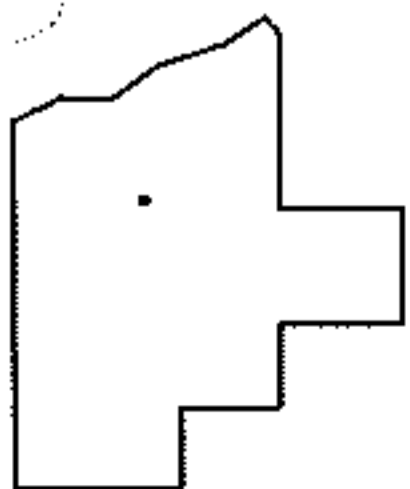

SPLITS/DEEDS PROCESSED

LORAIN COUNTY TAX MAP DEPARTMENT
226 MIDDLE AVE. ELYRIA, OHIO

SURVEYED BY: DEED
 CLOSURE: .00:10.000
 MAP PAGE(S): 7-00-046-D
 APPROVED BY: DRH DATE: 9/25/2009
 SCALE: 1" = 100 PRIOR INSTRUMENT: DV 997/522