

PARENT PARCEL: 02-02-025-101-003

CHILD PARCEL: 02-02-025-101-011, -012

STARTING POINT: SIDELINE OF ASHLAND AVE AND S/L 45

NO. 01837

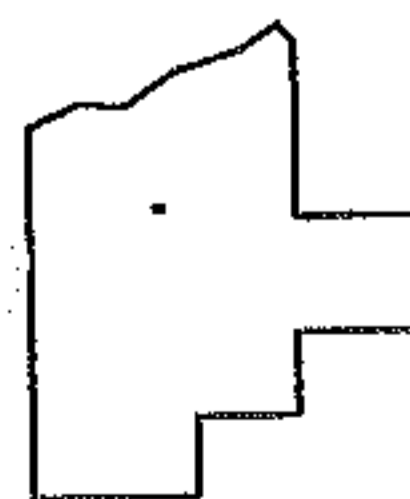
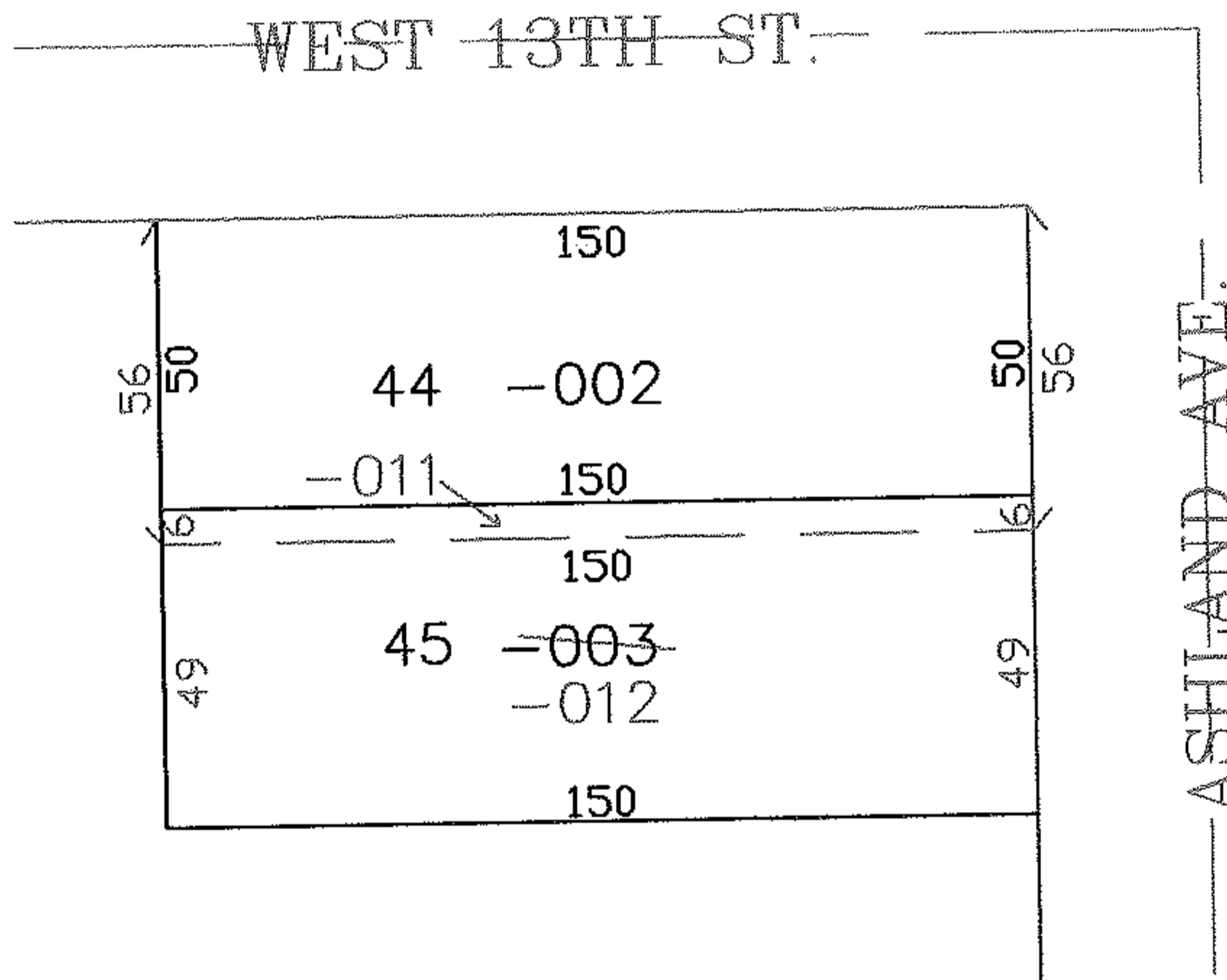
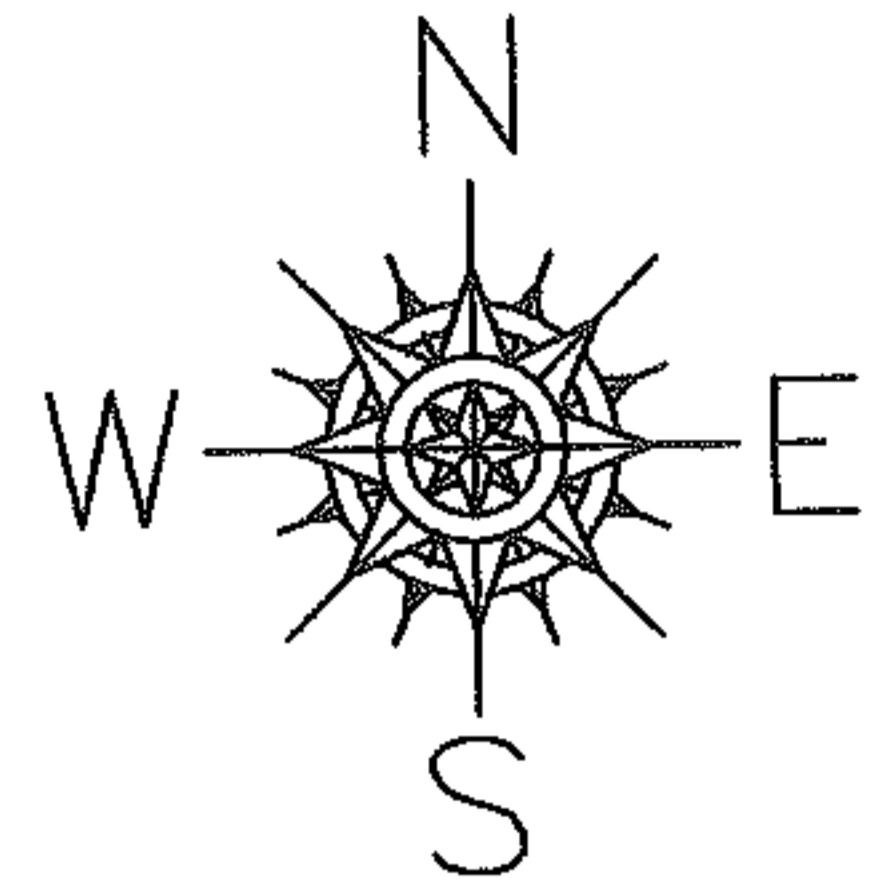

SPLITS/DEEDS PROCESSED

LORAIN COUNTY TAX MAP DEPARTMENT
226 MIDDLE AVE. ELYRIA, OHIO

SURVEYED BY: DANE HAPONEK

CLOSURE: 0.00 : 10.000

MAP PAGE(S): 02-02-025-A

APPROVED BY: JAH DATE: 1-18-05

SCALE: 1" = 100' PRIOR INSTRUMENT: PL VL 4/1