

MASTER

PARENT PARCEL: ADD TO DUPLICATE

CHILD PARCEL: 02-01-006-137-040

STARTING POINT: S/L 7 IN W.B. THOMPSON'S 2ND ADDITION P.V. 5/27

NO. 09-01837-C

DRAWING NOT TO SCALE

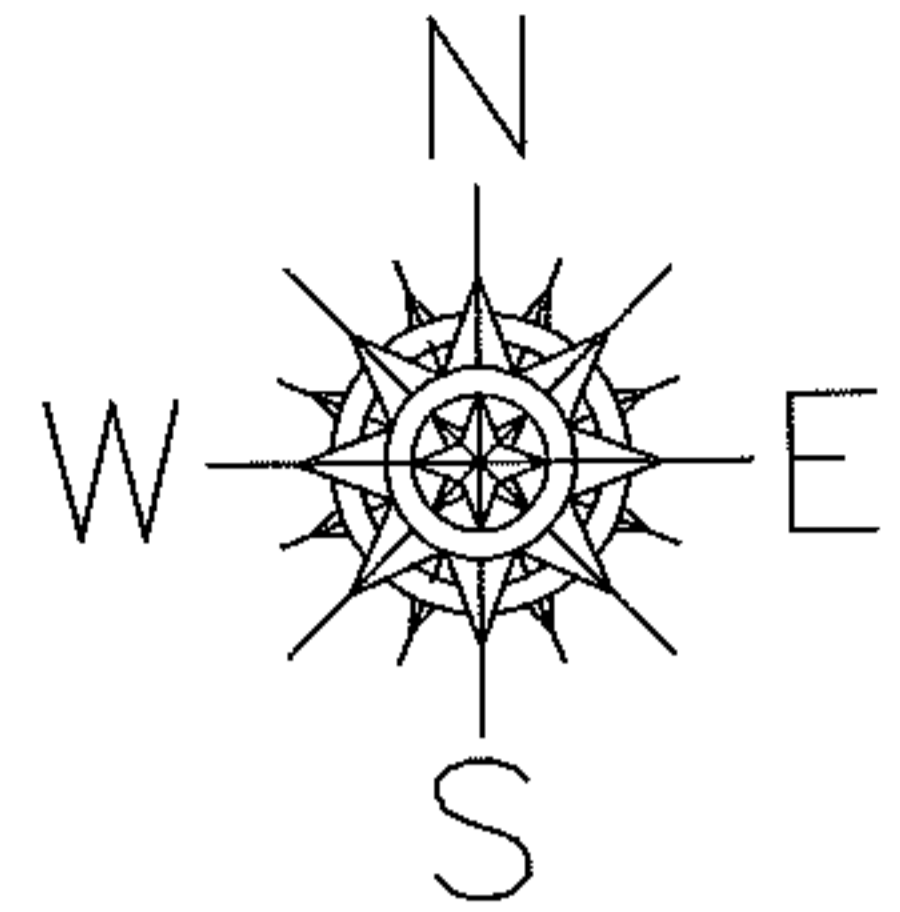

PER ORDINANCE 54-61

VACATED ALLEY ORD 54-61

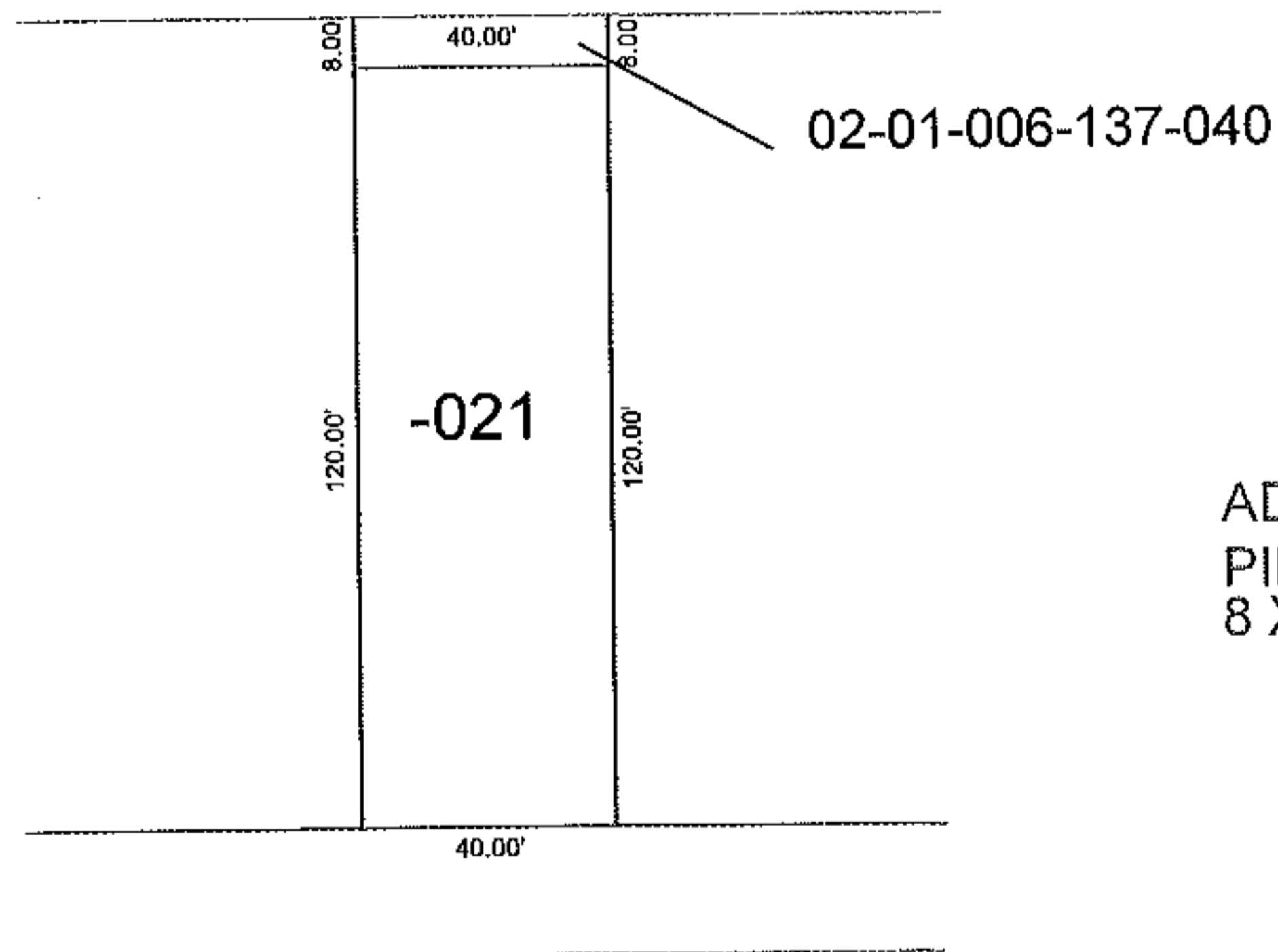

ADD TO DUP
PIECE VACATED
8 X 40

WEST 19TH STREET

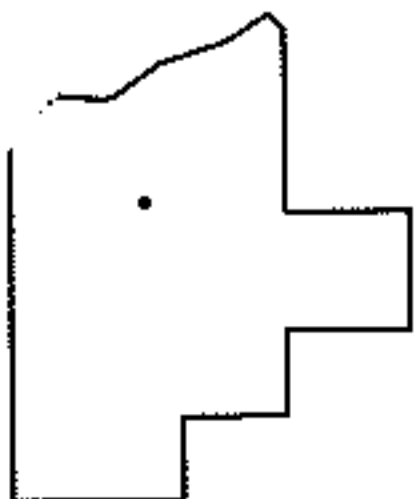

SPLITS/DEEDS PROCESSED

LORAIN COUNTY TAX MAP DEPARTMENT
226 MIDDLE AVE. ELYRIA, OHIO

SURVEYED BY: ORD 54-61

CLOSURE: N/A

MAP PAGE (S) : 02-01-006-C

APPROVED BY: MBK DATE: 6/2/2009

SCALE: N/A PRIOR INST. 2007-0188709