

RASTER

PARENT PARCEL: 03-00-042-104-025

CHILD PARCEL: N/A

STARTING POINT: Southwest corner of parcel 673 and Tennyson Ave

09-01815-C

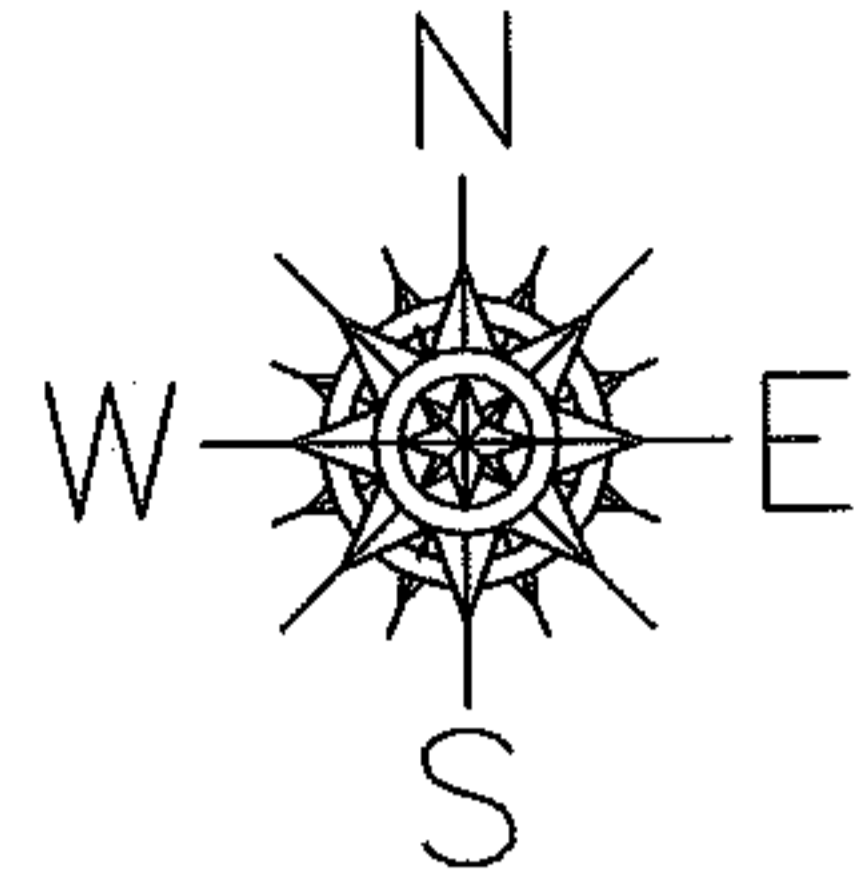

Frontage and Depth Correction

03-00-042-104-025

~~40.69x123.00~~

40.69x123.24

Correction per Deed

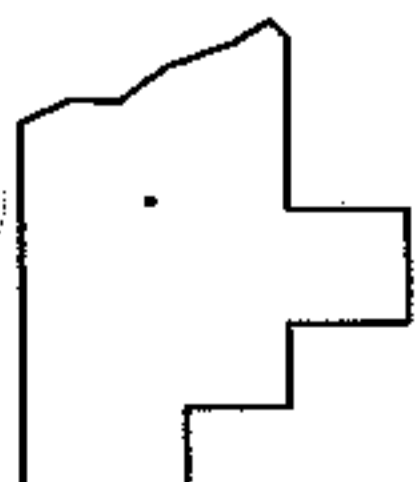
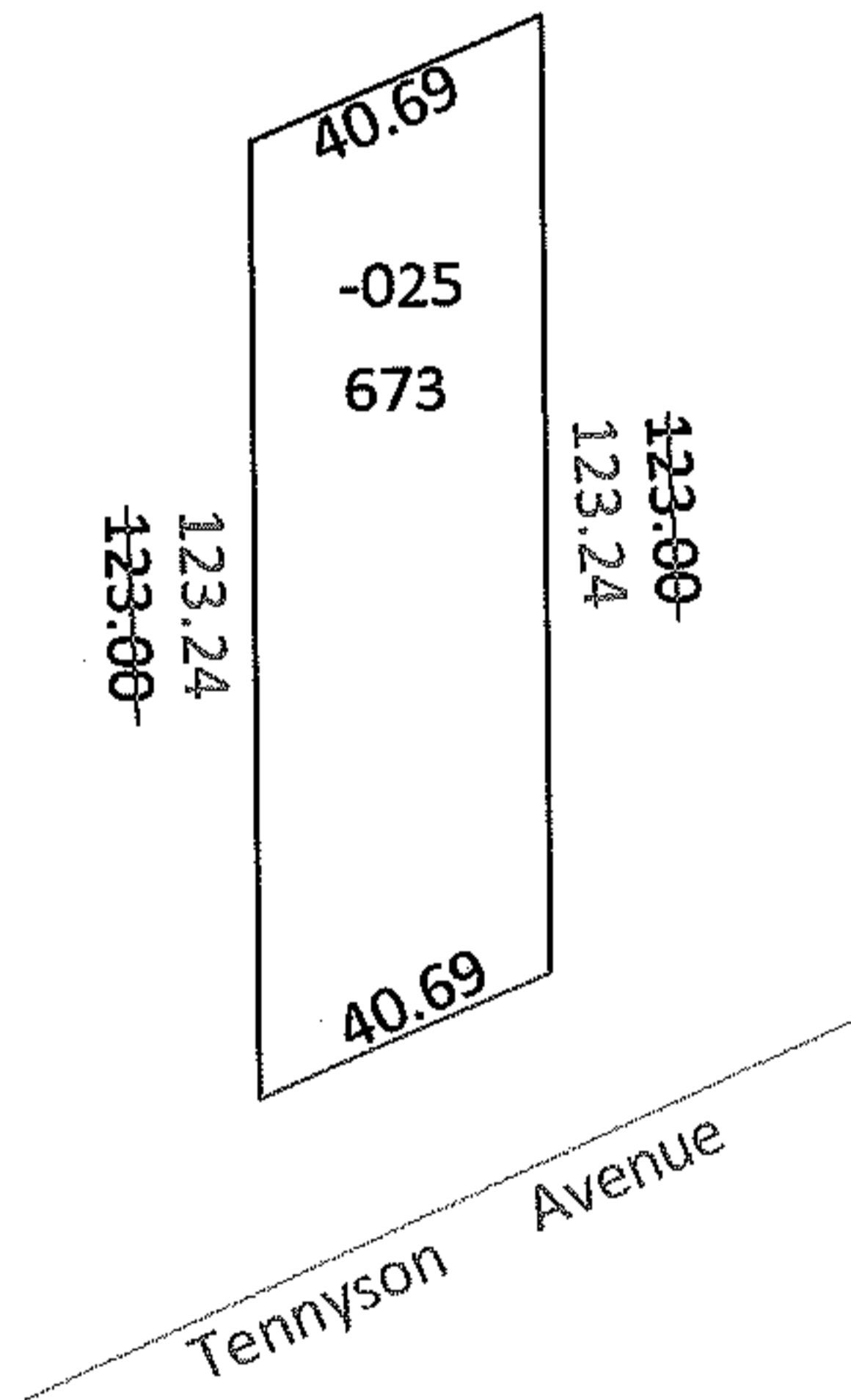

SPLITS/DEEDS PROCESSED

LORAIN COUNTY TAX MAP DEPARTMENT
226 MIDDLE AVE. ELYRIA, OHIO

SURVEYED BY: N/A

CLOSURE: 1: 327,860,000

MAP PAGE(S): 03-00-042A

APPROVED BY: CJB DATE: 5/7/09

SCALE: 1"= 50' PRIOR INST.: 20080242818