

RASTER

PARENT PARCEL: 04-00-022-101-016

CHILD PARCEL: N/A

STARTING POINT: 1047.19 ft. southerly from intersection of Jaycox and north line of OL22

09-01801-C

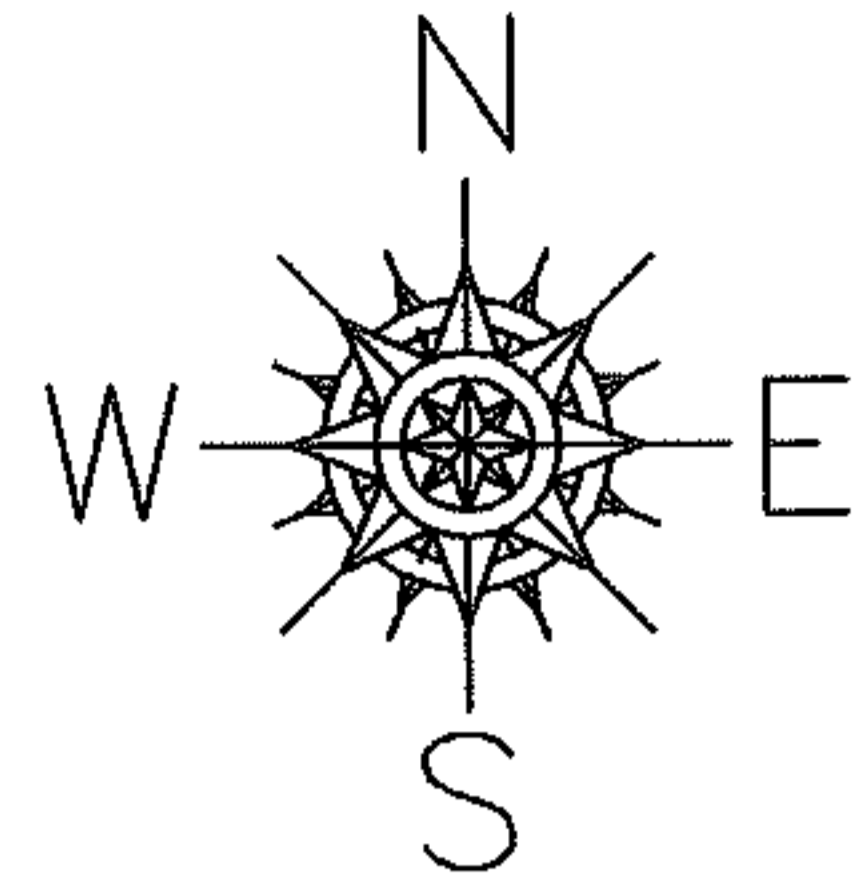

Frontage and Depth Correction

04-00-022-101-016
~~130.73x333.00~~
130.73x333.25
Correction per Deed

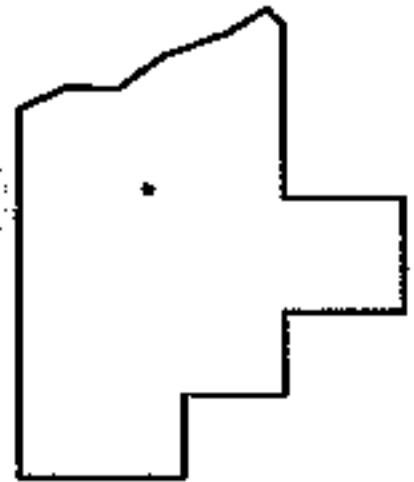
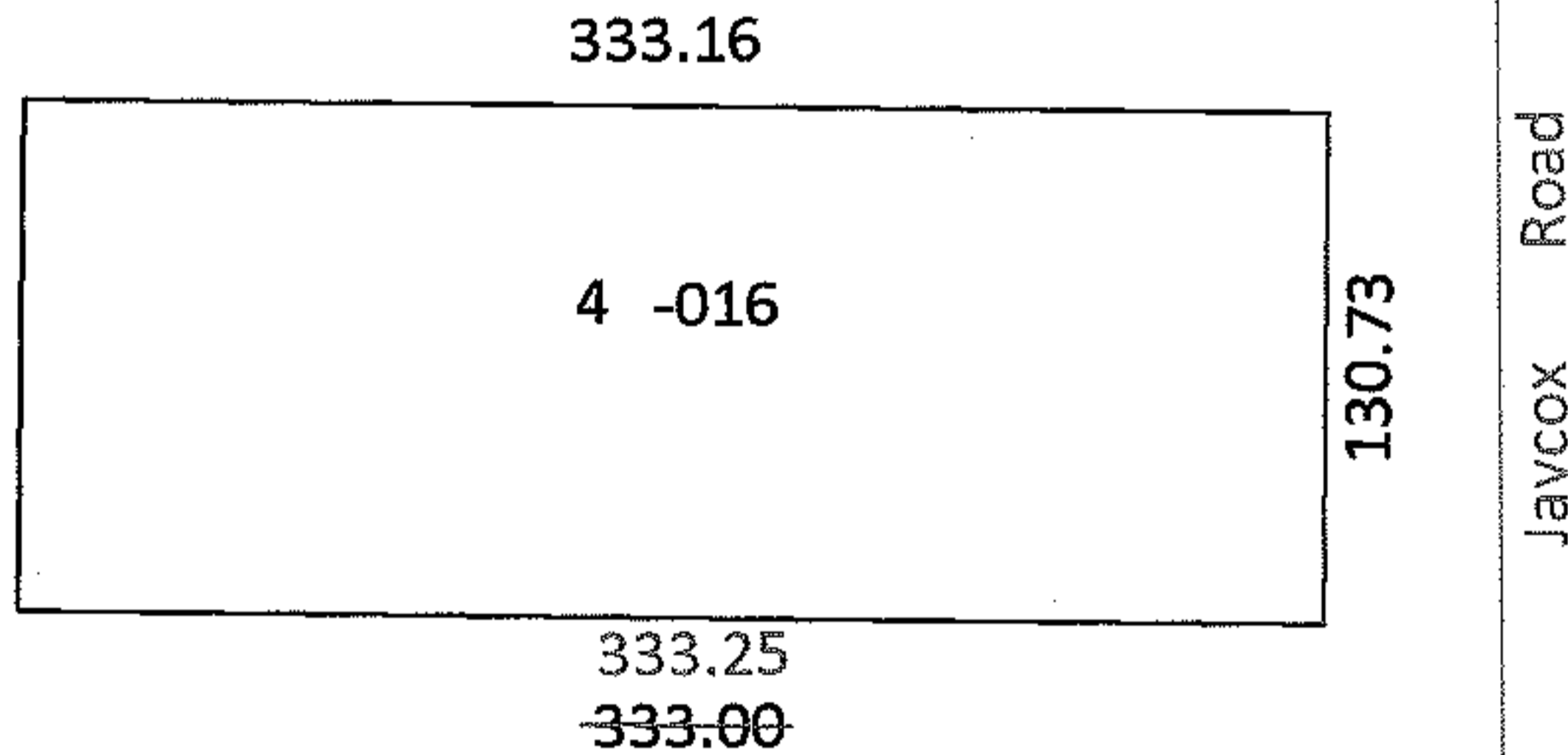

SPLITS/DEEDS PROCESSED

LORAIN COUNTY TAX MAP DEPARTMENT
226 MIDDLE AVE. ELYRIA, OHIO

SURVEYED BY: N/A
CLOSURE: 1: 183024.53
MAP PAGE(S): 04-00-022-B
APPROVED BY: CJB DATE: 5/11/09
SCALE: 1"= 100 PRIOR INST.: DV1290/0588