

PARENT PARCEL: 03-00-108-104-008

09-01781-C

CHILD PARCEL: --SAME--

STARTING POINT: S/L 33 IN INDUSTRIAL SAVINGS REALTY COMPANY'S BROADWAY GARDENS ALLOT. PV 9 P22

DEPTH CORR PER MAP & PLAT

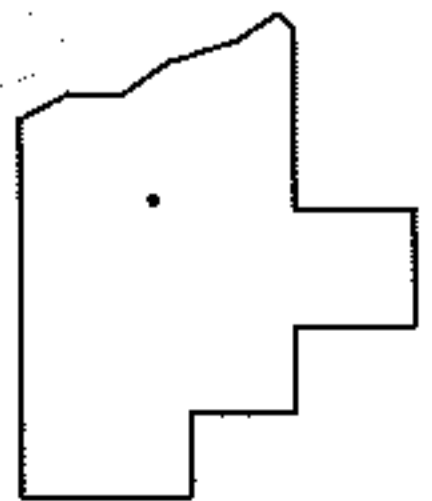
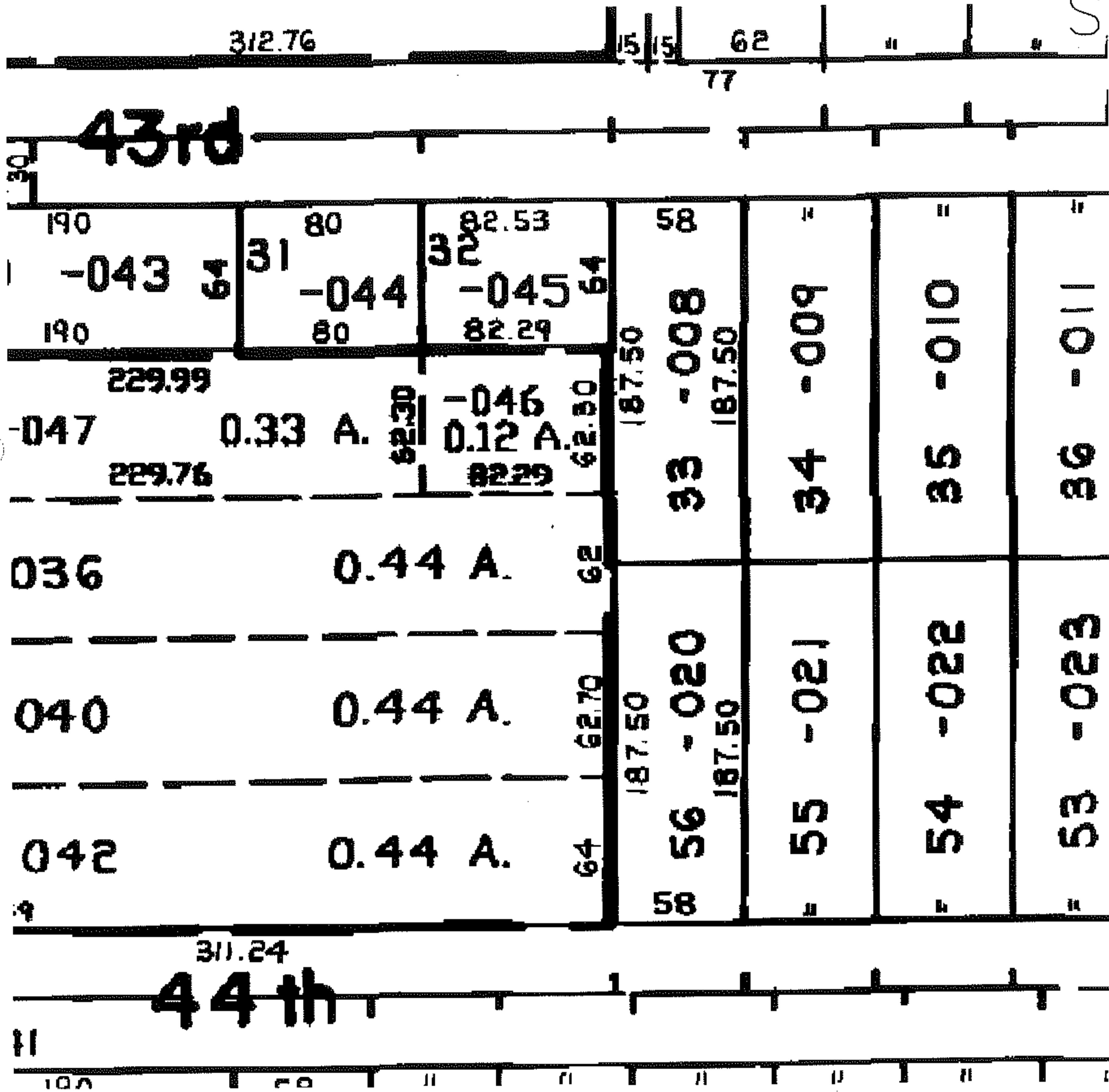
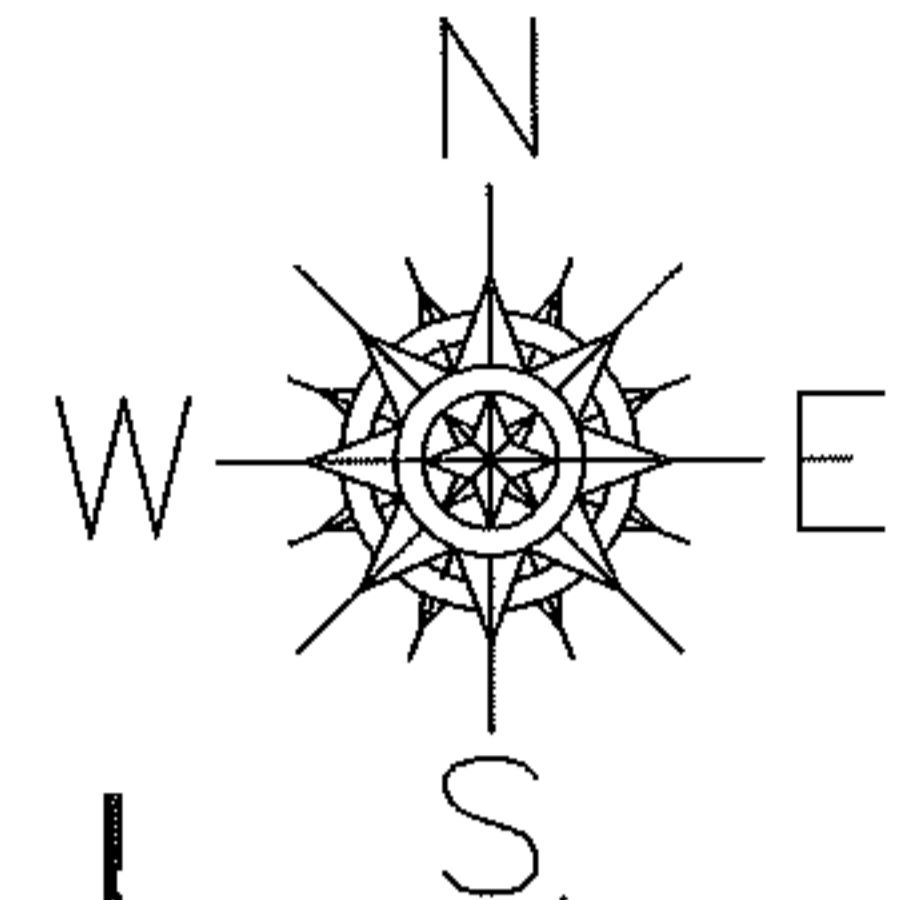

SPLITS/DEEDS PROCESSED

LORAIN COUNTY TAX MAP DEPARTMENT  
226 MIDDLE AVE. ELYRIA, OHIO

SURVEYED BY: N/A

CLOSURE: N/A

MAP PAGE(S): 03-00-108-A

APPROVED BY: DRH DATE: 6/15/2009

SCALE: NOT TO SCALE PRIOR INST.: 20090295799