

PARENT PARCEL: 04-00-030-131-032

CHILD PARCEL: --SAME--

STARTING POINT: S/L 103 IN AVON DOVER LAND COMPANY'S AVONDOVER BEACH SUB

09-01780-C

NO MAP CORRECTION
DEPTH CORR PER MAP AND DEED

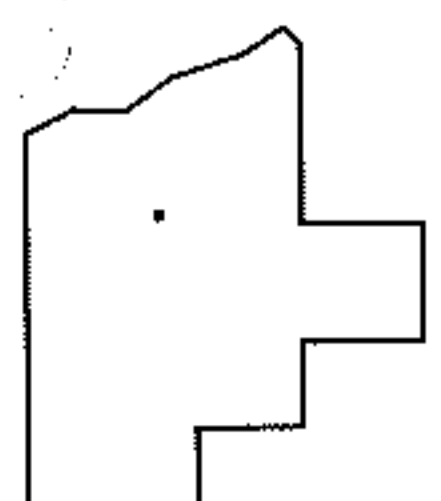
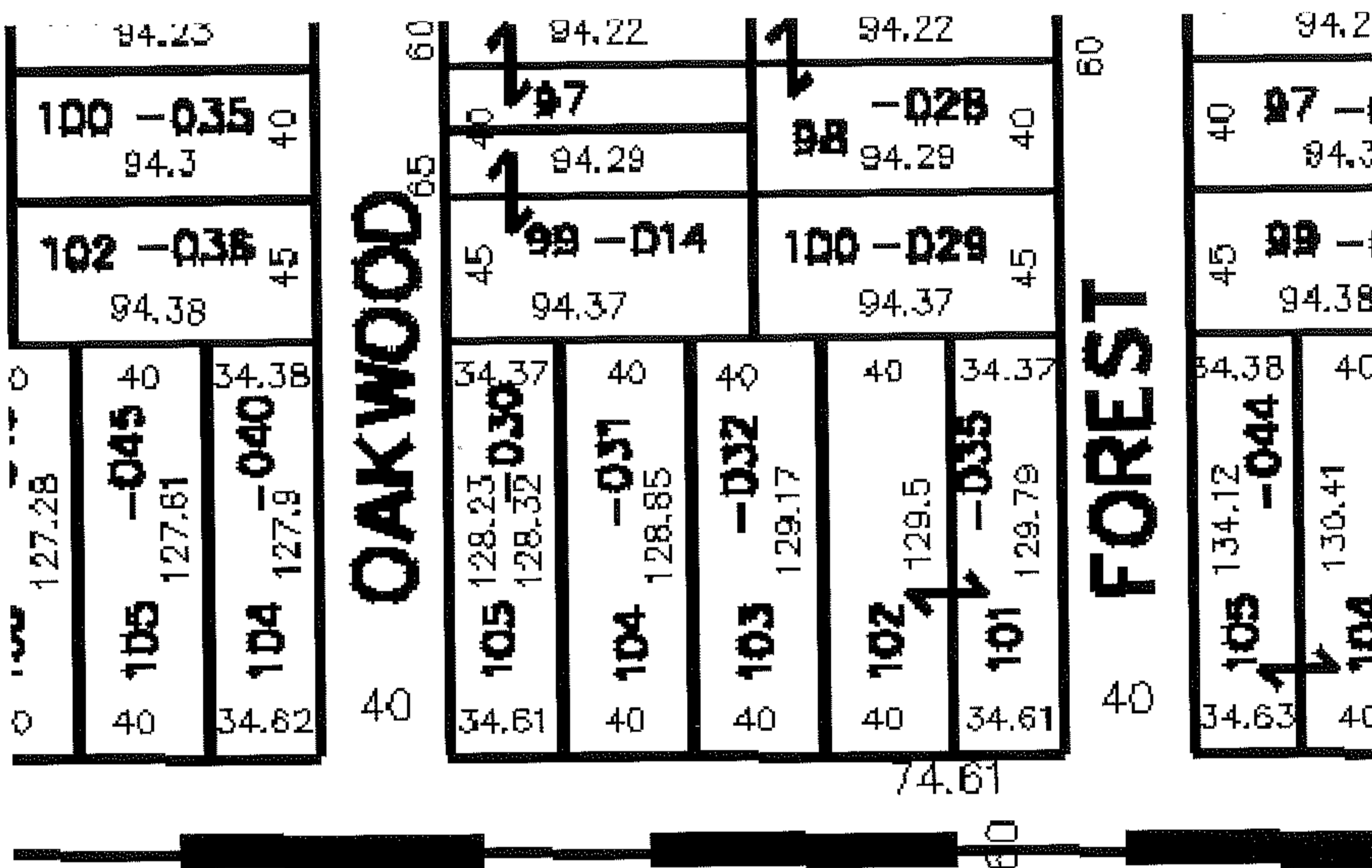
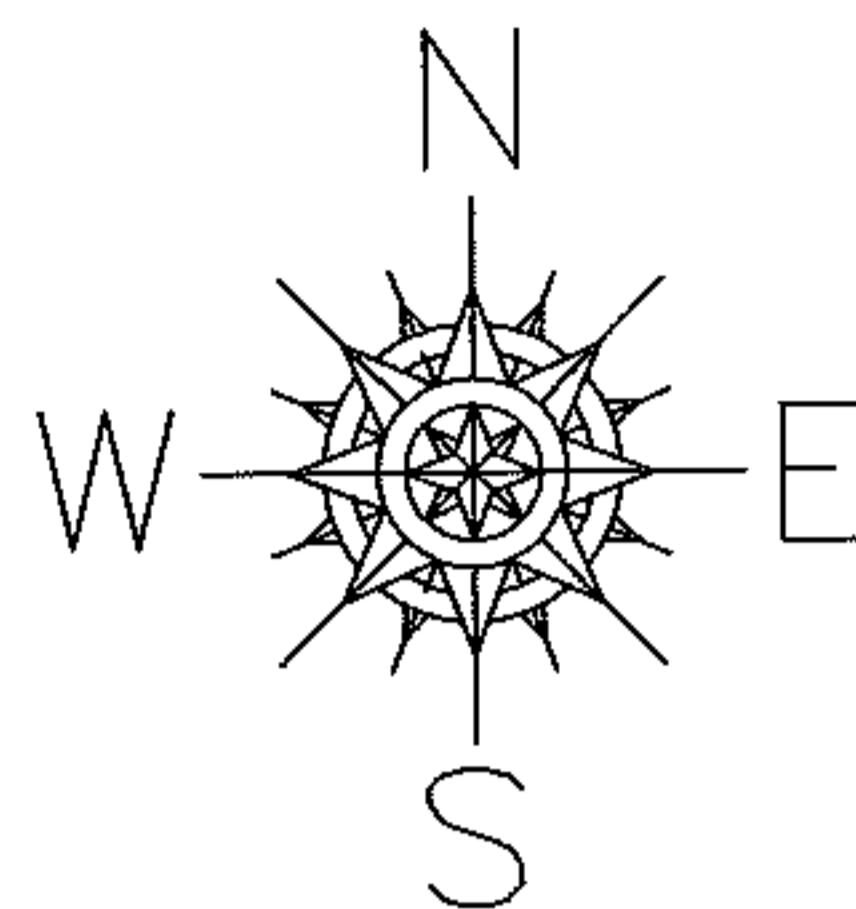

SPLITS/DEEDS PROCESSED

LORAIN COUNTY TAX MAP DEPARTMENT
226 MIDDLE AVE. ELYRIA, OHIO

SURVEYED BY: N/A
 CLOSURE: N/A
 MAP PAGE(S): 04-00-030-A
 APPROVED BY: DRH DATE: 6/15/2009
 SCALE: NOT TO SCALE PRIOR INST.: 20090287241