

RASTER

PARENT PARCEL: 09-00-086-105-008

08-01662-D

CHILD PARCEL: --SAME--

STARTING POINT: INT CL COLLEGE ST AND PLEASANT ST

# DEPTH CORR PER SURVEY RICHARD FREDRICKSON

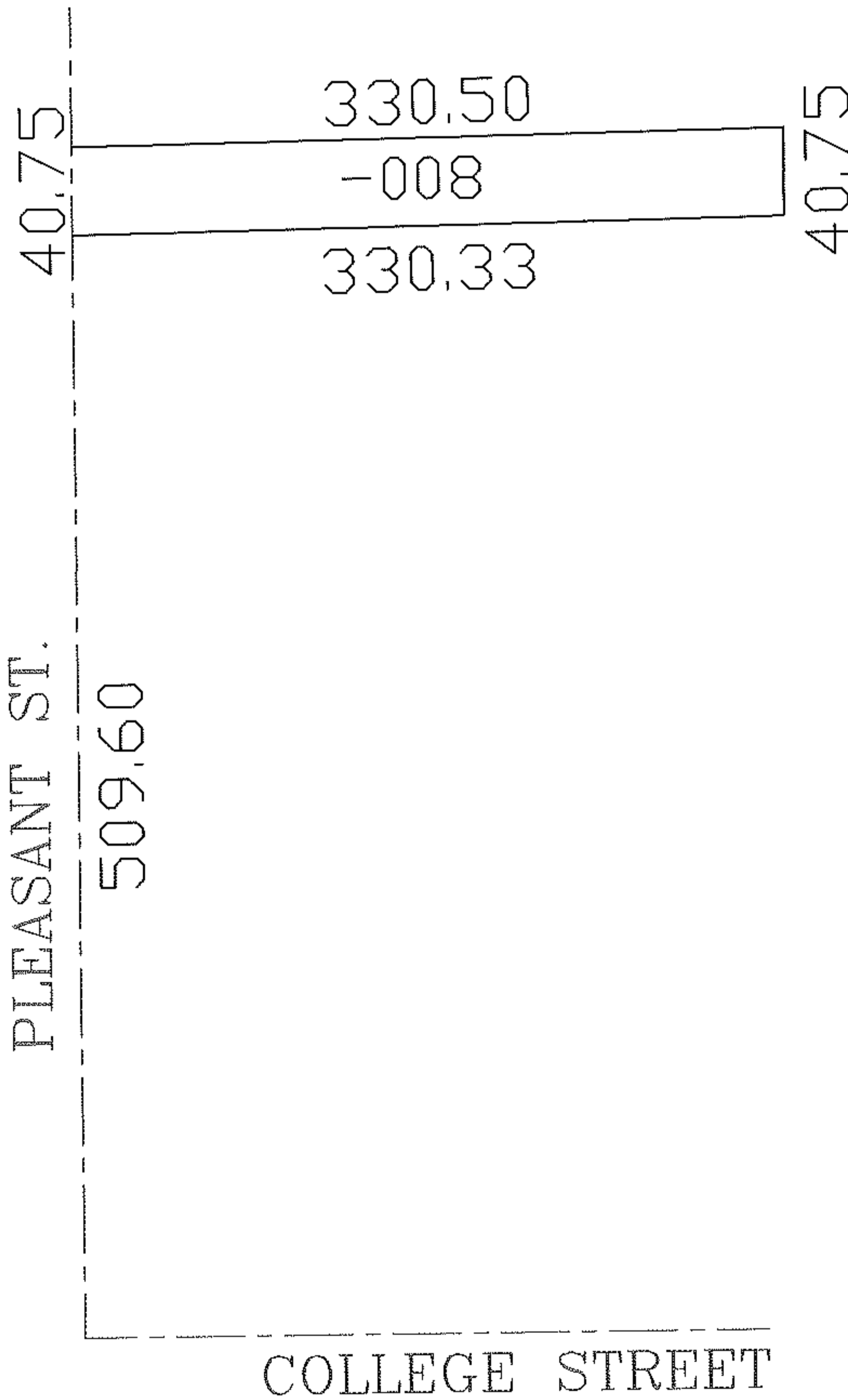
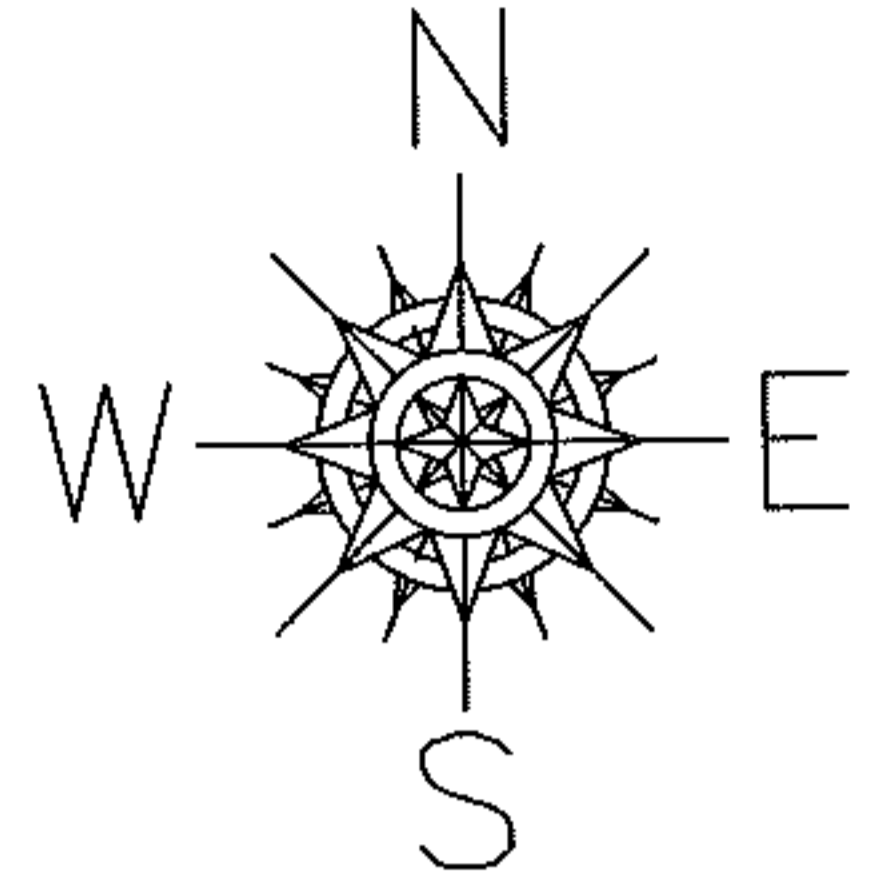

## SPLITS/DEEDS PROCESSED

LORAIN COUNTY TAX MAP DEPARTMENT  
226 MIDDLE AVE. ELYRIA, OHIO

SURVEYED BY: RICHARD FREDRICKSON

CLOSURE: 1:10,000

MAP PAGE(S): 09-00-086-A

APPROVED BY: DRH DATE: 6/10/2008

SCALE: 1" = 100' PRIOR INSTRUMENT: 19980549197