

RASTER

PARENT PARCEL: 09-00-075-104-064

08-01619-C

CHILD PARCEL: --SAME--

STARTING POINT: SW CORNER OF SL 16

DEPTH CORR  
PER PLAT & Deed

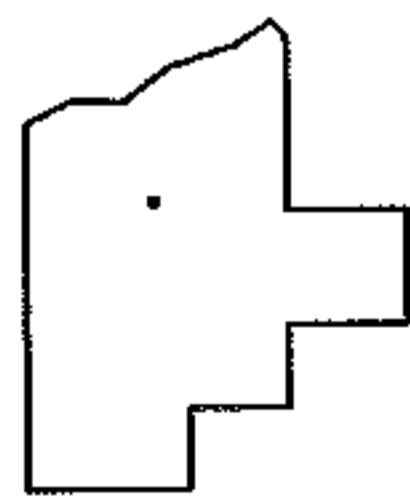
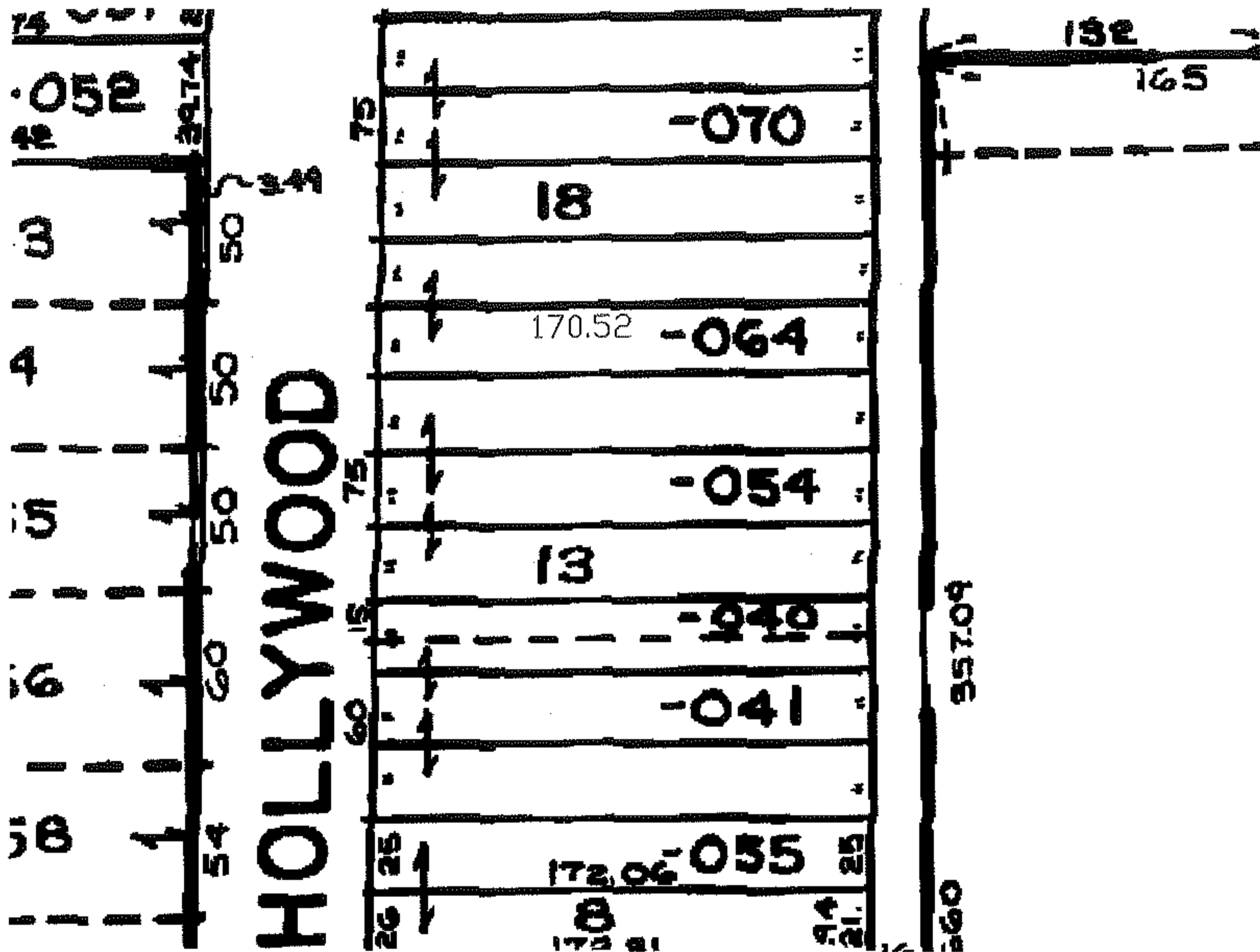
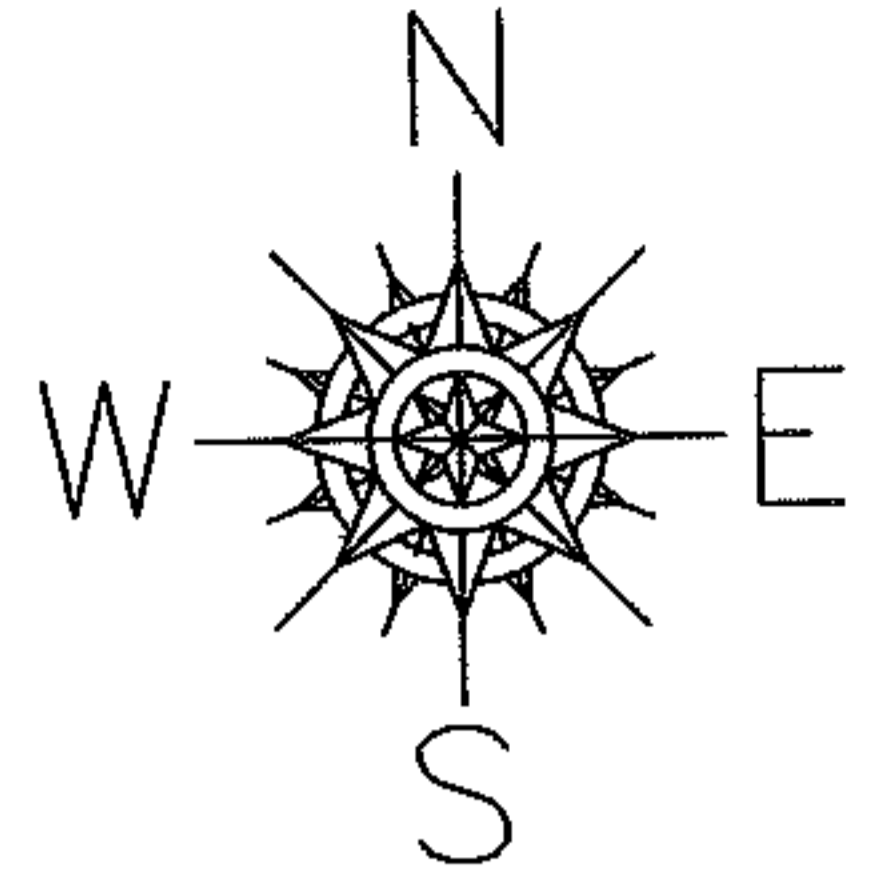

SPLITS/DEEDS PROCESSED

LORAIN COUNTY TAX MAP DEPARTMENT  
226 MIDDLE AVE. ELYRIA, OHIO

SURVEYED BY: N/A  
 CLOSURE: N/A  
 MAP PAGE(S): 09-00-075-A  
 APPROVED BY: DRH DATE: 3/27/2008  
 SCALE: NOT TO SCALE PRIOR INSTRUMENT: