

RASTER

PARENT PARCEL: 09-00-105-000-017

CHILD PARCEL: --SAME--

STARTING POINT: MON BOX AT INT CL OF HAMILTON ST AND S.R. 58

08-01590-C

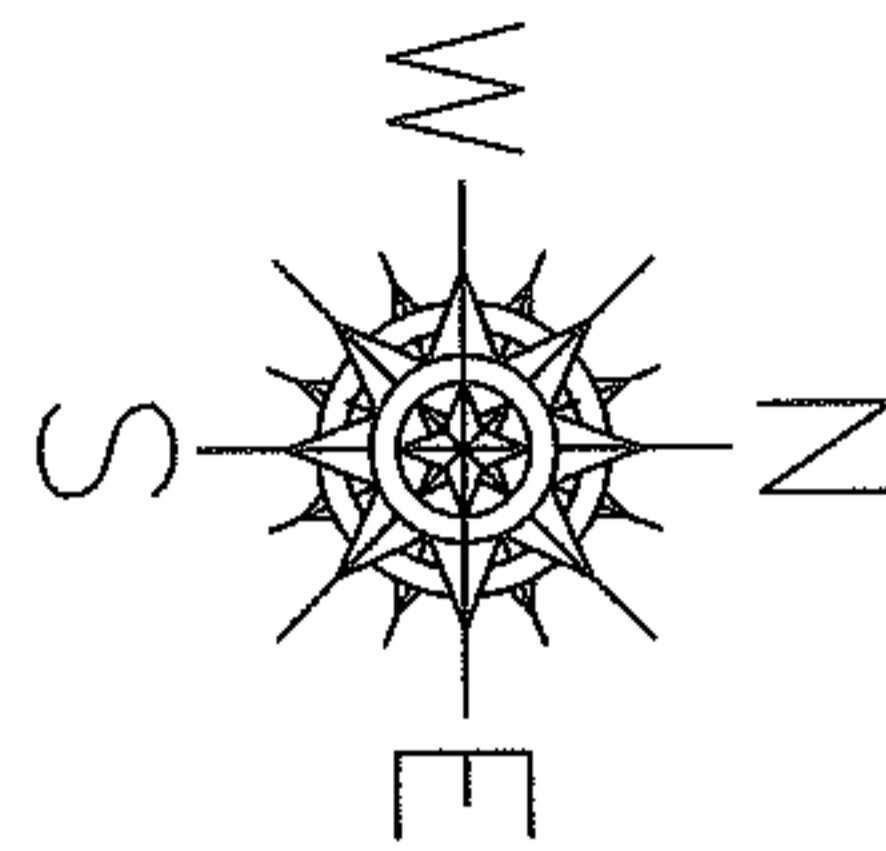

AC. CORR.
PER SURVEY
DOUGLAS H. MOSLEY

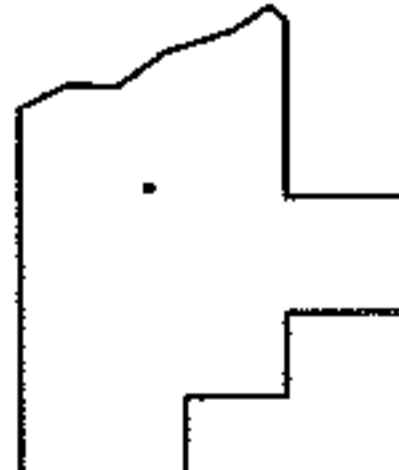
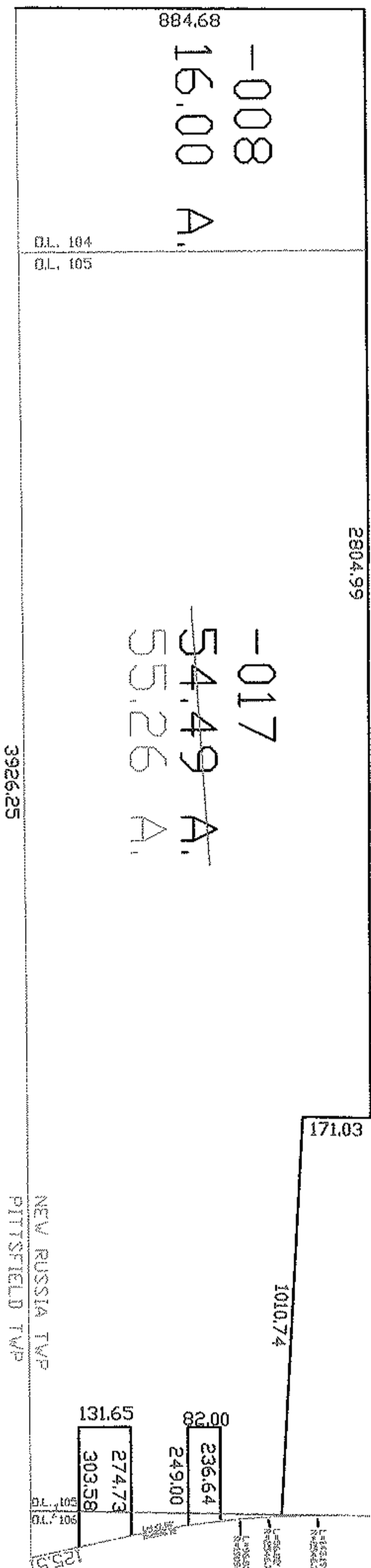

SPLITS/DEEDS PROCESSED

LORAIN COUNTY TAX MAP DEPARTMENT
226 MIDDLE AVE. ELYRIA, OHIO

SURVEYED BY: DOUGLAS H. MOSLEY

CLOSURE: 1:10.000

MAP PAGE(S): 09-00-104-B, 09-00-105-A

APPROVED BY: DRH DATE: 1/18/2008

SCALE: 1" = 500 PRIOR INSTRUMENT: 20070219135