

RASTER

PARENT PARCEL: 03-00-062-000-006

07-01542-A

CHILD PARCEL: --SAME--

STARTING POINT: INT 611 AND ELYRIA SHEFFIELD LAKE RD

AC. CORR.
PER SURVEY
TIMOTHY FELLER

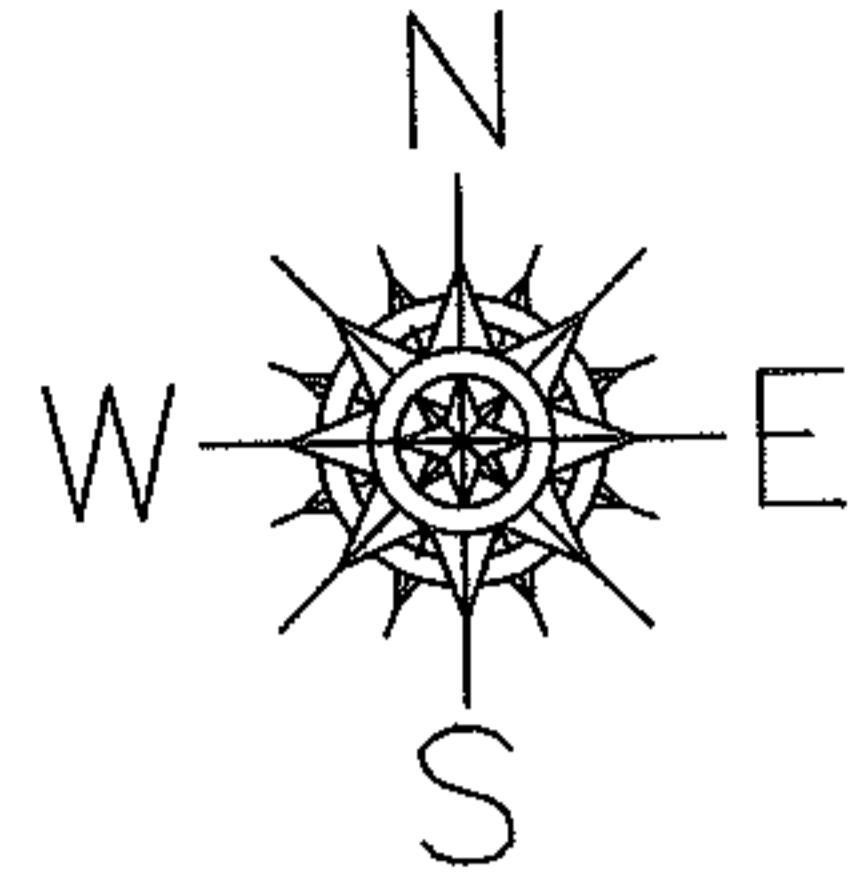

ELYRIA SHEFFIELD

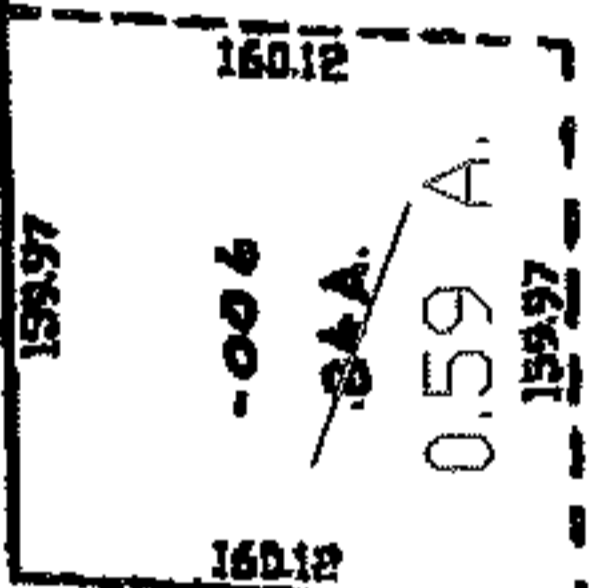

903.49

LORAIN AVON

SEE 3-00-064-A

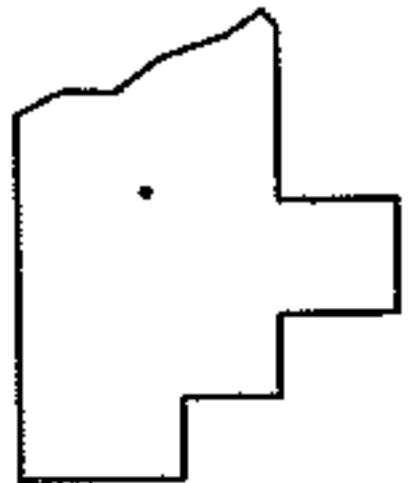

SPLITS/DEEDS PROCESSED
LORAIN COUNTY TAX MAP DEPARTMENT
226 MIDDLE AVE. ELYRIA, OHIO

SURVEYED BY: TIMOTHY FELLER
CLOSURE: 1:10,000
MAP PAGE(S): 03-00-062
APPROVED BY: DRH DATE: 10/4/2007
SCALE: NOT TO SCALE PRIOR INSTRUMENT: 20000682064