

PARENT PARCEL: _____
CHILD PARCEL: 05-00-018-104-067 THRU -070
STARTING POINT: NORTHWEST CORNER OF S/L 12 OF CG ZIMMERMAN SUBD.

06-01319-C

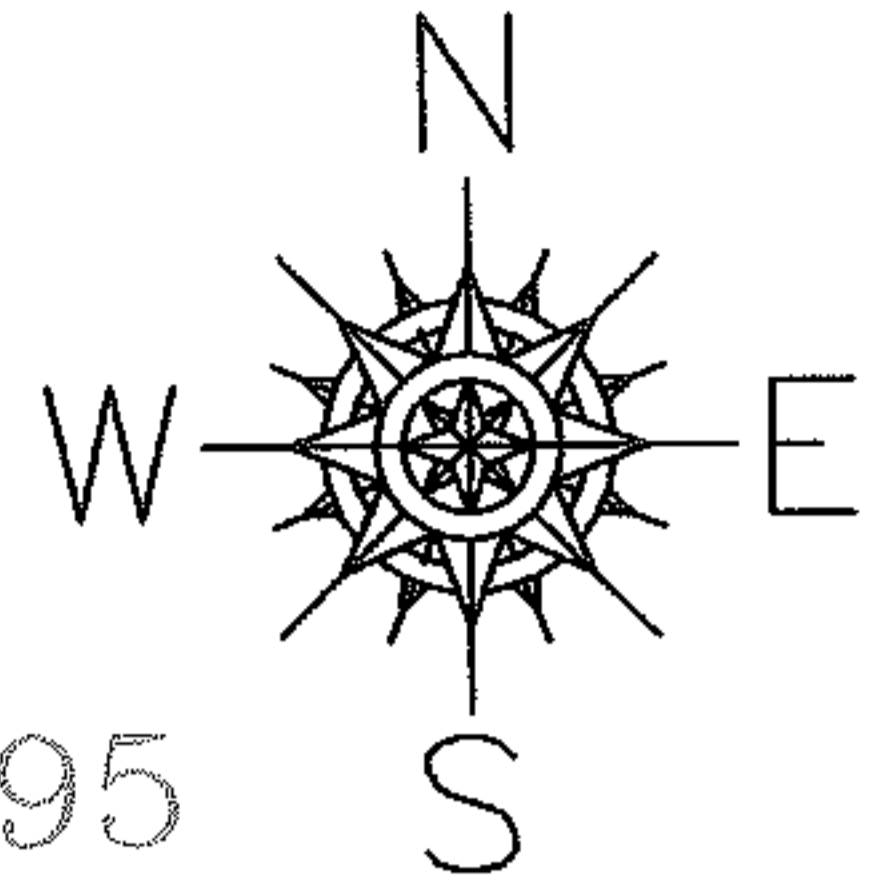

CORRECTION TO SPLIT #06-02095

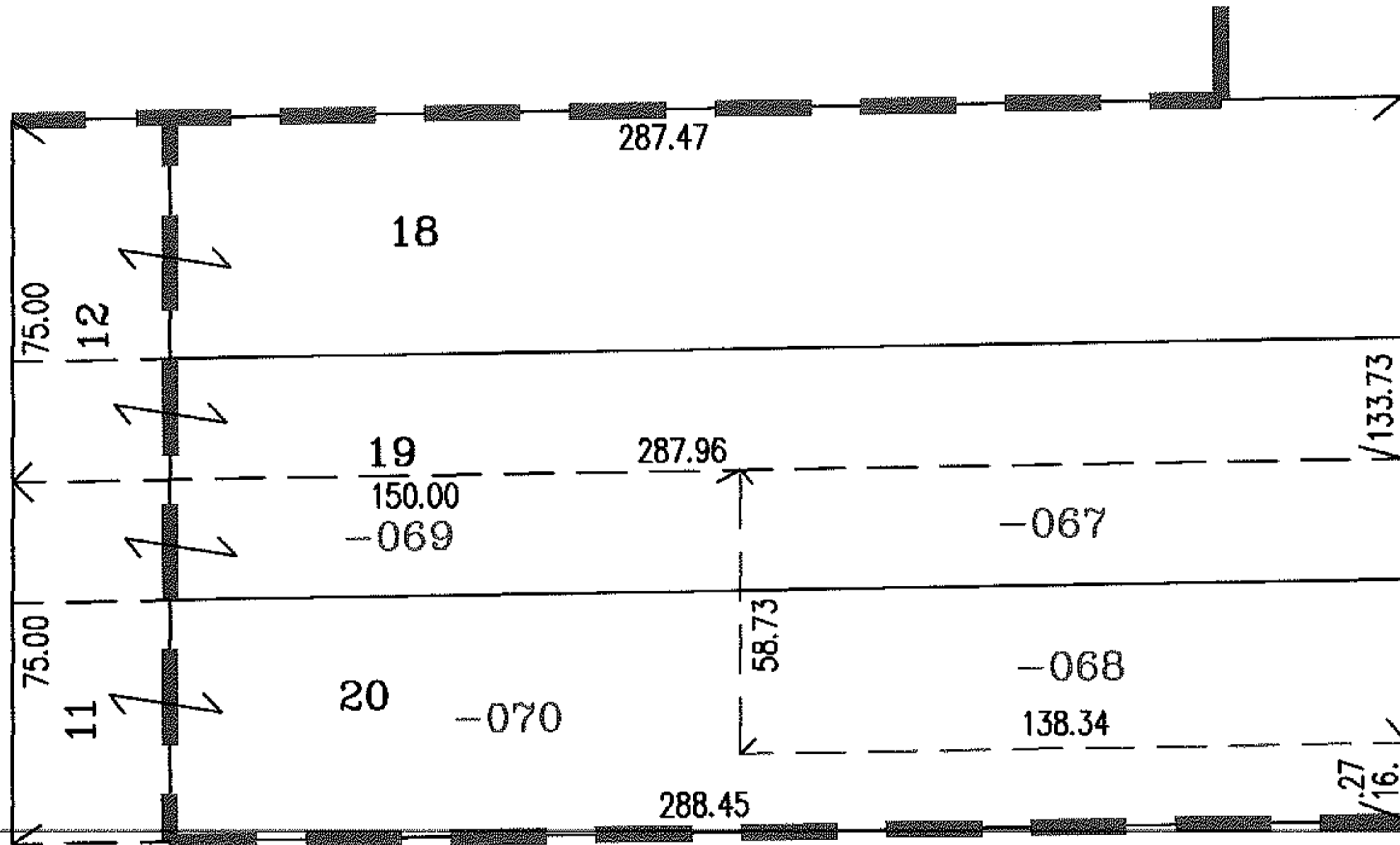

FRONTAGE AND DEPTH CORR.

05-00-018-104-067	16 X 288	25 X 137.96
05-00-018-104-068	138.34 X 58.73	33.73 X 138.34
05-00-018-104-069	9 X 150	25 X 150
05-00-018-104-070	50 X 150	50 X 288.45

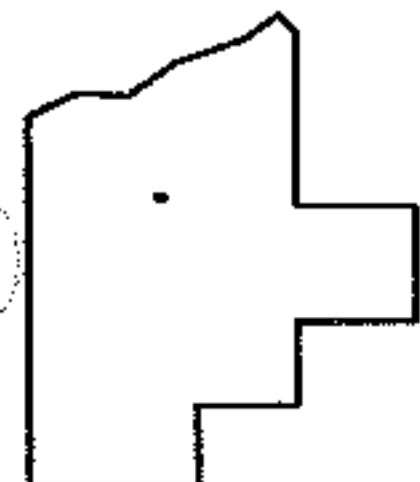

SPLITS/DEEDS PROCESSED

LORAIN COUNTY TAX MAP DEPARTMENT
226 MIDDLE AVE. ELYRIA, OHIO

SURVEYED BY: TIMOTHY REILY
CLOSURE: 0.00 : 10.000
MAP PAGE(S): 05-00-018-B
APPROVED BY: RRM DATE: 4/5/06
SCALE: 1" = 50' PRIOR INSTRUMENT: 20050097187