

RASTER

PARENT PARCEL: 06-25-015-109-032 & -036

CHILD PARCEL: --SAME--

STARTING POINT:

06-01295-C

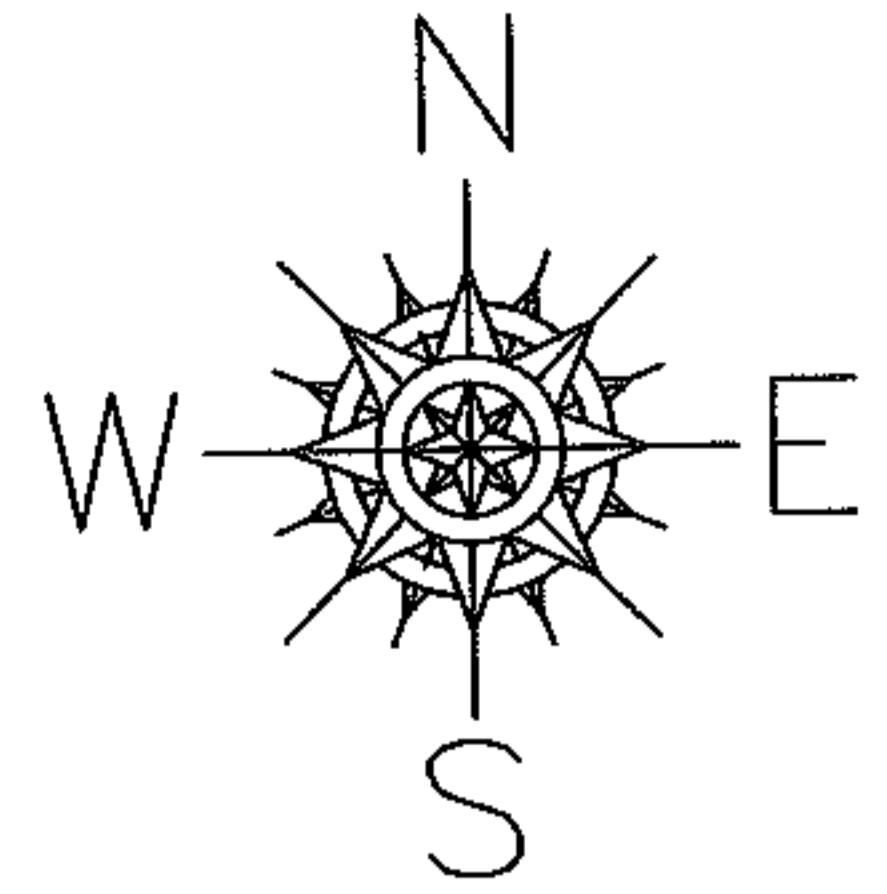

SEE 6-105

DEPTH  
CORR  
PER  
PLAT

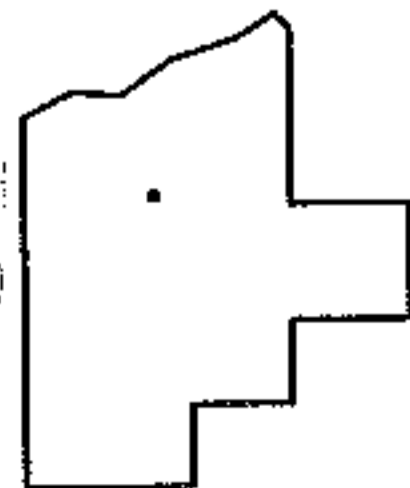
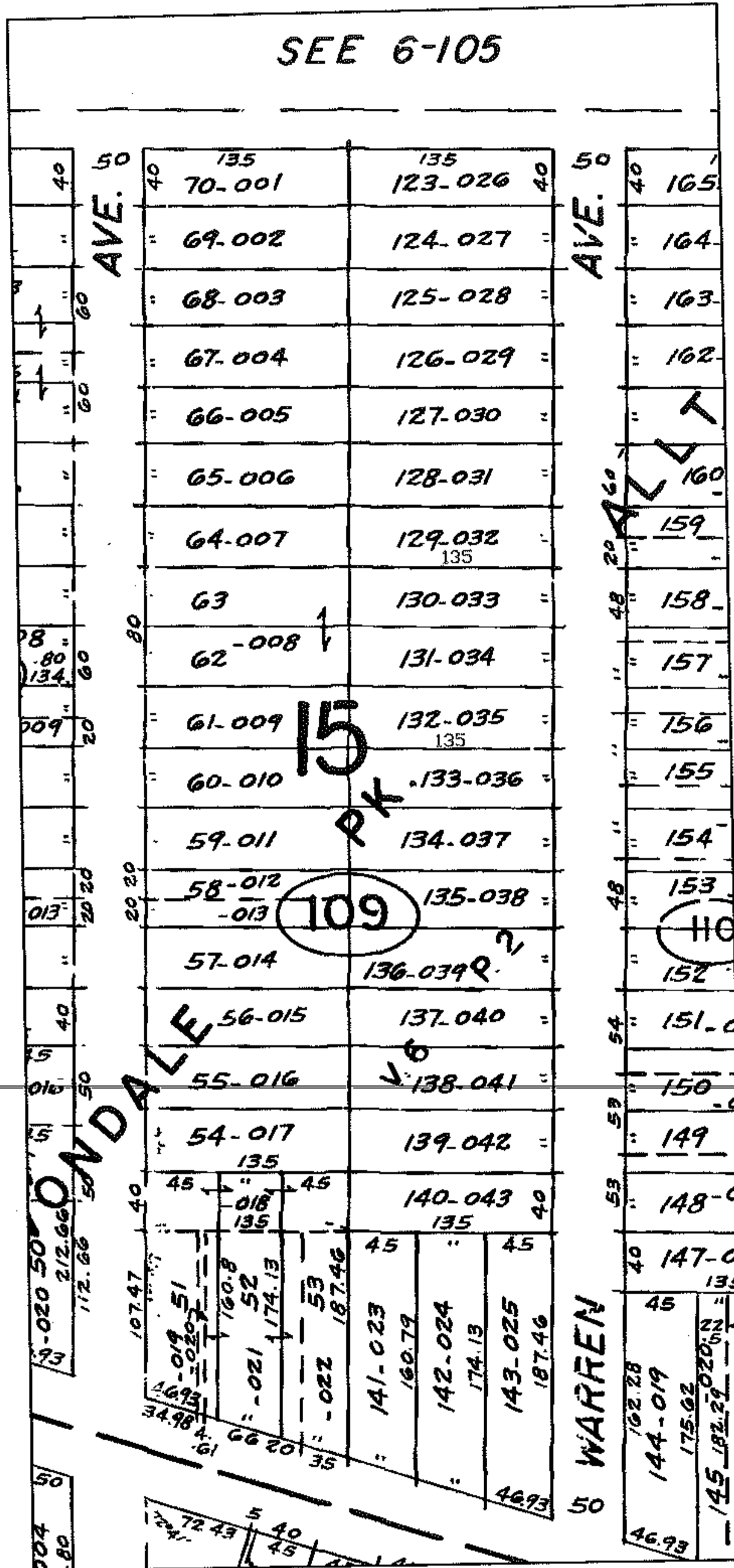

SPLITS/DEEDS PROCESSED  
LORAIN COUNTY TAX MAP DEPARTMENT  
226 MIDDLE AVE. ELYRIA, OHIO

SURVEYED BY: N/A  
CLOSURE: N/A  
MAP PAGE(S): 06-123  
APPROVED BY: DRH DATE: 6/13/2006  
SCALE: 1" = 200 PRIOR INSTRUMENT: