

RASTER

PARENT PARCEL: 02-01-005-113-017 & -022

NO. 01134-C

CHILD PARCEL: --SAME--

STARTING POINT: INT CL CORNELL PLACE AND SIXTH CT

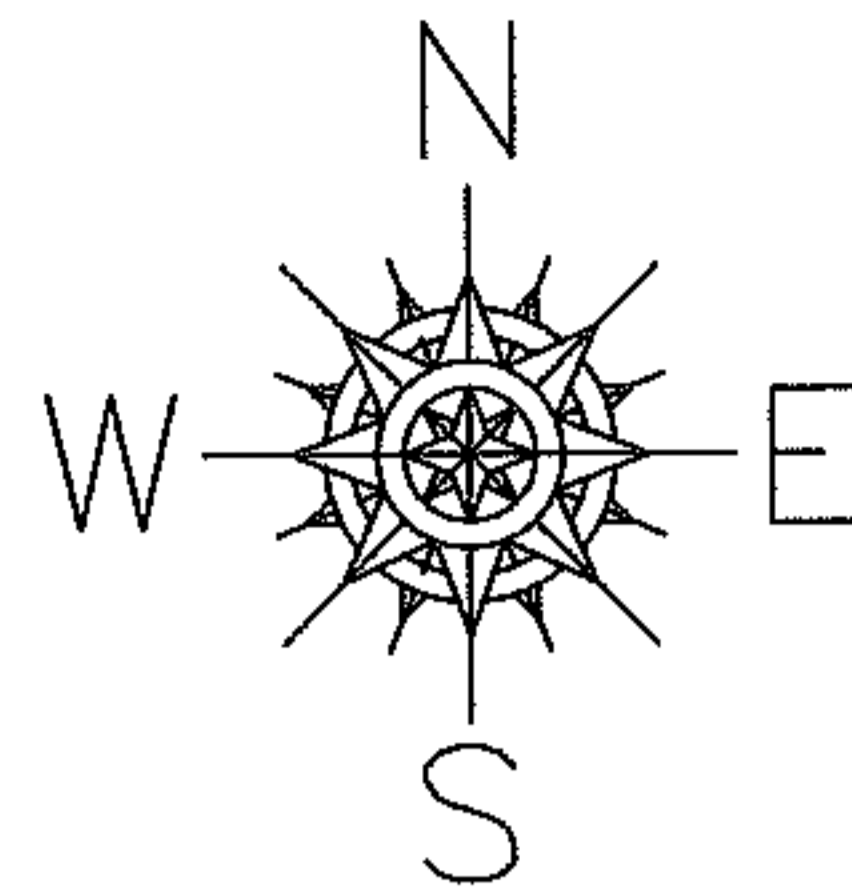

AVE.

60

ST.

50

221.72

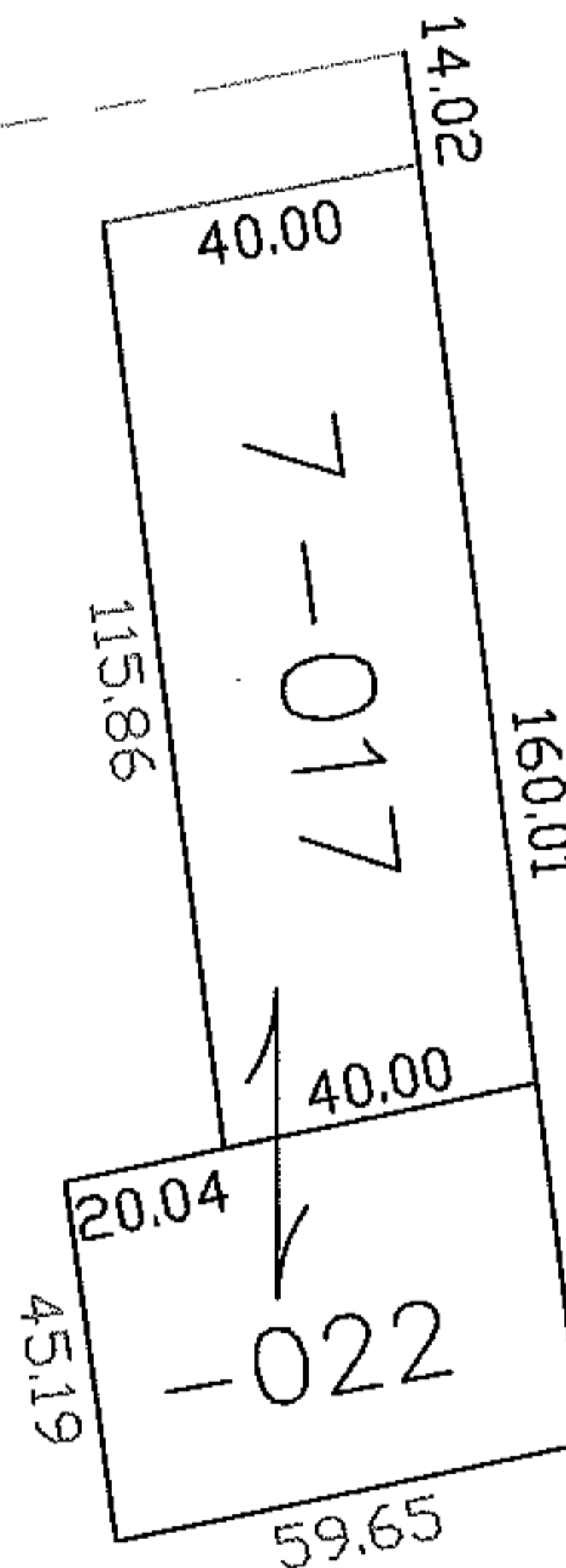

CORR

PER SURVEY

THOMAS SIMON

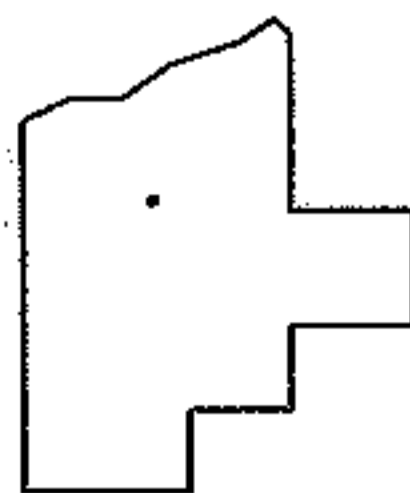

SPLITS/DEEDS PROCESSED

LORAIN COUNTY TAX MAP DEPARTMENT
226 MIDDLE AVE. ELYRIA, OHIO

SURVEYED BY: THOMAS SIMON
 CLOSURE: 1:10,000
 MAP PAGE(S): 02-00-014-B
 APPROVED BY: DRH DATE: 4/14/2005
 SCALE: 1" = 50' PRIOR INSTRUMENT: 20040048210