

MASTER

NO. 00931

PARENT PARCEL: 14-00-004-000-004, 14-00-017-000-002  
CHILD PARCEL: 14-00-004-000-007, -008 & 14-00-017-000-053, -054  
STARTING POINT: CENTERLINE IF KIPTON-NICKEL PLATE RD. & O.L. 17

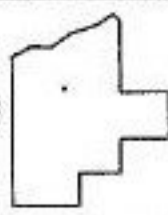

**SPLITS/DEEDS PROCESSED**  
LORAIN COUNTY TAX MAP DEPARTMENT  
226 MIDDLE AVE. ELYRIA, OHIO

SURVEYED BY: THOMAS M. SNEZEK  
CLOSURE: 0.00 ; 10.000  
MAP PAGE(S): 14-C  
APPROVED BY: JAH DATE: 12-6-01  
SCALE: 1" = 300 PRIOR INSTRUMENT: 20000690111