

RASTER

PARENT PARCEL: 13-09-029-000-008
CHILD PARCEL: 13-09-029-000-009, -010
STARTING POINT: CENTERLINE OF ROWELL RD. & O.L. 29

NO. 00706



~~-008~~
~~34.00 A.~~

-010
31.34 A.

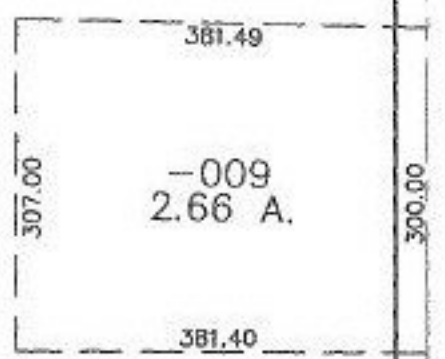

O.L. 29
O.L. 44

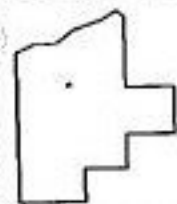

SPLITS/DEEDS PROCESSED
LORAIN COUNTY TAX MAP DEPARTMENT
226 MIDDLE AVE. ELYRIA, OHIO

SURVEYED BY: JOHN POZYWAK
CLOSURE: 0.01 : 10,000
MAP PAGE(S): 13-H
APPROVED BY: JAH DATE: 4-05-01
SCALE: 1" = 200' PRIOR INSTRUMENT: 99067972