

PT. 01-00-061-000
PT. 38.22 A.

#00 337

APPROVED LORAIN CO. MAP DEPT
DATE 1-31-2000
PAGE 1-K
BY <i>Hollist</i>
337

21.58

3.46

660.25

2122.54

285.12

60

CLAUS

1416.99

(50)

1440.15

-032

7.92 A.

307.16
316.55

839.13

1086.56

255.6
-007
1.75 A.
470.12
559.77

-021
7.89 A

-040
-034 24.59A.

25.52 A.

-041
1.50A

610.5
698.47

642.78
610.50

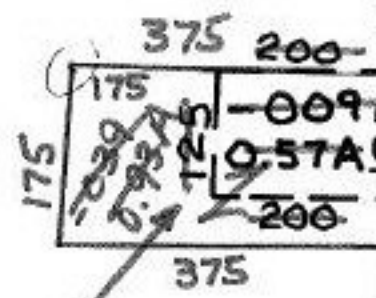

285.12

215

25

228.43

-016

202.70

228.15

50

210.50

1035.

118

201.3

329.10

199.67

208.20

116.7

116.7

116.7

116.7

116.7

116.7

116.7

116.7

116.7

116.7