

PARENT PARCEL: 02-01-003-180-012  
CHILD PARCEL: 02-01-003-180-024, -025  
STARTING POINT: INT CL W 25TH AND LIVINGSTON

NO. 00257

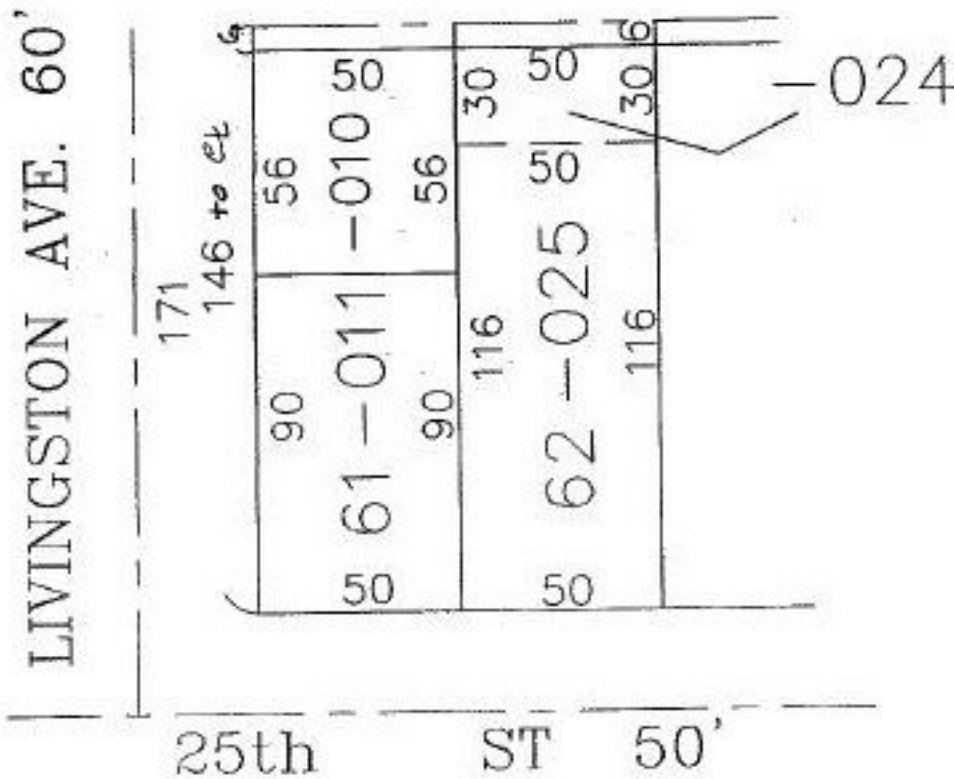

**SPLITS/DEEDS PROCESSED**  
LORAIN COUNTY TAX MAP DEPARTMENT  
226 MIDDLE AVE. ELYRIA, OHIO

SURVEYED BY: JOHN POZYWAK  
CLOSURE: 0.00 : 10.000  
MAP PAGE(S): 02-01-003-H  
APPROVED BY: DRH DATE: 11-5-99  
SCALE: 1" = 50' PRIOR INSTRUMENT: OR 565/431