

LORAIN COUNTY



COMMISSIONERS

20996-X

FROM MAIL ROOM
MAY 18 1994

LORAIN COUNTY RES. 94-360 5/5/94
CITY OF ELYRIA ORD 94-180 2/15/94

Commissioners

Herbert J. Jacoby
Mary Jo Vasi
Elizabeth C. Blair

May 17, 1994

Mr. Jack Lesnick, 322-7269
Clerk of Council
City of Elyria
Elyria City Hall
328 Broad Street
Elyria, Ohio 44035

NECL

Dear Mr. Lesnick:

We are enclosing a complete record of transcript from the Board of Commissioners, granting Annexation of approximately 26.11 acres of land in Elyria Township to the City of Elyria, Ohio.

This documentation is being forwarded for your information and files. Should you have any questions regarding this correspondence, or its enclosures, please feel free to contact this office.

Yours truly,

Roxann Blair

Roxann Blair, Clerk

RB/dw
Enclosures

cc: Attorney Bessick, Solicitor's Office
Kenneth P. Carney, Sr., County Engineer
Julian A. Pijor, County Auditor
Elyria Township Trustees Clerk
Mary Ann Jamison, County Recorder
Board of Elections
Tax Map
Mark Stewart, Appraisal Department
9-1-1
File

OSKINS

COLINS

May 05, 1994

RESOLUTION NO. 94-360

In the matter of the public hearing)
on the proposed Annexation of approx-)
imately 26.11 acres of land in Elyria)
Township to the City of Elyria, Ohio)
Michelle Nedwick, Elyria City)
Solicitor's Office-Agent, represent-)
ing Petitioners)

WHEREAS, Petition was submitted to this office on January 12, 1994 for the proposed annexation of 26.11 acres of land in Elyria Township to the City of Elyria.

WHEREAS, after due and legal notice, a public hearing was held on March 31, 1994 at 11:00 A.M. in the Commissioners Public Hearing Room, on the proposed annexation and due to Commissioner Jacoby's absence, the Board could not render a decision at that time:

WHEREAS, the Lorain County Engineer by letter dated January 19, 1994 submitted the following report:

"In answer to a letter dated January 12, 1994 from the Board this office has reviewed the description and map submitted by Michelle D. Nedwick, agent for the petitioners, to annex 26.11 acres of land in Original Lots 13 and 24 in Elyria Township to the City of Elyria.

We find the description correctly follows the outline of the area proposed for annexation as shown on the map prepared by Lonny Shippy, P.S.

<u>Permanent Parcel No.</u>	<u>Owner</u>	<u>Acres</u>
06-24-013-000-003	Joseph Zavala	0.07
06-24-013-000-004	Joseph Zavala	0.02
06-24-013-000-005	Gloria L. Krajieski	0.08
06-24-024-109-016	Gloria L. Krajieski	12.64
06-24-024-109-021	Gloria L. Krajieski	0.41
06-24-024-109-022	City of Elyria	10.63
06-24-024-109-023	City of Elyria	0.69
06-24-024-109-024	Gloria L. Krajieski	<u>1.13</u>
Total area for annexation =		26.11 acres

If you have any questions please contact this office.

Sincerely yours,
S/Kenneth P. Carney, Sr.
Lorain County Engineer"; and

WHEREAS, the City of Elyria filed Ordinance No. 94-38 indicating the services the City of Elyria would provide to the territory sought to be annexed, if granted.

WHEREAS, as suggested by Commissioner Vasi, at the hearing on March 31, 1994 a Revenue Sharing Agreement was not obtained by the Elyria Trustees with the City of Elyria, Ohio.

NOW, THEREFORE, BE IT RESOLVED by the Board of Commissioners of Lorain County, Ohio that based upon the Annexation Petition provided and report from the County Engineer's Department which stated there were no discrepancies, we do and hereby grant said petition for annexation for the premises as follows:

Situated in the Township of Elyria, County of Lorain and State of Ohio and known as being part of Original Lot Nos. 24 and 13, West of Black River bounded and described as follows:

Beginning at an iron pin found in the Northerly line of Lowell Street and the present Westerly corporation line of Elyria City.

Thence Northerly, along the Westerly Lot line of Original Elyria Township Lot No. 25; which is also a present corporation line between the City of Elyria and Elyria Township; a distance of 2119.99 feet to an iron pin found, said point is also North-East corner of present Elyria Township boundary.

Thence Westerly; along the present corporation line between the City of Elyria and Elyria Township a distance of 714 feet to an iron pin, said point is also North-West corner of land owned by Krajewski, Gloria L. per Lorain County Deed Vol. 715 page 111.

Thence Southerly, along the present corporation line between the City of Elyria and Elyria Township a distance of 1520.69 feet to an iron pin.

Thence Easterly, along the present corporation line between City of Elyria, and Elyria Township a distance of 217.48 feet.

Thence Southerly, along the present corporation line between City of Elyria and Elyria Township a distance of 594.25 feet to an iron pin, said pin also lies on the Northerly line of Lowell Street.

Thence Westerly, along the Southerly line of Lowell Street to a point, said point also lies on the Northerly property line of New York-Central Rail-Road.

Thence South-Easterly along the Northerly line of New York-Central Rail-Road, a distance of 330.29 feet to a point, said point also lies on corporation line between City of Elyria and Elyria Township.

Thence Northerly along the present corporation line between City of Elyria and Elyria Township a distance of 91.32 feet to a point, said point also lies on Southerly line of Lowell Street.

Thence continuing Northerly along the present corporation line between City of Elyria and Elyria Township a distance of 33.00 feet to a point, said point lies on center line of Lowell Street.

Thence Easterly along center line of Lowell Street to a point, said point is also a point of intersection of center line of Lowell Street and Westerly line of original Lot No. 25.

Thence Northerly along the Westerly lot line of original Elyria Township Lot No. 25 to the place of beginning.

Containing within said boundaries the area of land is 26.11 acres.

The above-described territory is adjacent to the said City of Elyria, Ohio.

A certified copy of the final transcript of this Board of County Commissioners relating to the findings and orders of this Board, together with the accompanying map and petition and all other papers pertaining thereto shall be delivered to the City of Elyria, Ohio.

The foregoing resolution was introduced upon a motion by Commissioner Elizabeth C. Blair, seconded by Commissioner Mary Jo Vasi and upon roll call, the vote taken thereon resulted as follows: Mrs. Blair, "aye"; Mrs. Vasi, "aye", Mr. Jacoby, "aye".

Motion carried.

I, Roxann Blair, Clerk to the Board of Commissioners of Lorain County, Ohio, hereby certify that this is a true copy of Resolution No. 94-360 as it appears in Journal No. 94 on the date of May 05, 1994.



LORAIN COUNTY
SUN

To: Board of County Commissioners of Lorain County, Ohio.

94 JAN 12 P2: 23

PETITION FOR ANNEXATION

We, the undersigned, being competent adult individuals seized of a freehold estate in the within described territory, and being a majority of the owners of real estate as hereinafter more fully described, do hereby petition for the annexation of said territory to the City of Elyria, Lorain County, Ohio, to wit:

Situated in the Township of Elyria, County of Lorain and State of Ohio and known as being part of Original Lot Nos. 24 and 13, West of Black River bounded and described as follows:

Beginning at an iron pin found in the Northerly line of Lowell Street and the present Westerly corporation line of Elyria City.

Thence Northerly, along the Westerly Lot line of Original Elyria Township Lot no. 25; which is also a present corporation line between the City of Elyria and Elyria Township; a distance of 2119.99 feet to an iron pin found, said point is also North-East corner of present Elyria Township boundary.

Thence Westerly; along the present corporation line between the City of Elyria and Elyria Township a distance of 714 feet to an iron pin, said point is also North-West corner of land owned by Krajewski, Gloria L. per Lorain County Deed Vol. 715 page 111.

Thence Southerly, along the present corporation line between the City of Elyria and Elyria Township a distance of 1520.69 feet to an iron pin.

Thence Easterly, along the present corporation line between City of Elyria and Elyria Township a distance of 217.48 feet.

Thence Southerly, along the present corporation line between City of Elyria and Elyria Township a distance of 594.25 feet to an iron pin, said pin also lies on the Northerly line of Lowell Street.

Thence continuing Southerly, along the present corporation line between City of Elyria and Elyria Township a distance of 66.00 feet to a point, said point lies on Southerly line of Lowell Street.

Thence Westerly, along the Southerly line of Lowell Street to a point, said point also lies on the Northerly property line of New York-Central Rail-Road.

Thence South-Easterly along the Northerly line of New York-Central Rail-Road, a distance of 330.29 feet to a point, said

point also lies on corporation line between City of Elyria and Elyria Township.

Thence Northerly along the present corporation line between City of Elyria and Elyria Township a distance of 91.32 feet to a point, said point also lies on Southerly line of Lowell Street.

Thence continuing Northerly along the present corporation line between City of Elyria and Elyria Township a distance of 33.00 feet to a point, said point also lies on center line of Lowell Street.

Thence Easterly along center line of Lowell Street to a point, said point is also a point of intersection of center line of Lowell Street and Westerly line of original Lot no. 25.

Thence Northerly along the Westerly lot line of original Elyria Township Lot no. 25 to the place of beginning.

Containing within said boundaries the area of land is 26.11 acres.

The above-described territory is adjacent to the said City of Elyria, Ohio.

Petitioners have attached hereto and made a part of this Petition, an accurate map showing the boundaries of the territory sought to be annexed, marked "Map of Territory to be Annexed to the City of Elyria."

Petitioners state there are five (5) owners of real estate in the above-described territory which is sought to be annexed to the City of Elyria.

Michelle D. Nedwick, Legal Intern, Solicitor's Office, 328 Broad Street, Elyria, Ohio 44035 is hereby appointed agent for the undersigned petitioners as required by R.C. 709.02, with full power and authority hereby granted to said agent to amend, alter, change, correct, withdraw, refile, substitute, compromise, increase, decrease or delete the area; to do any and all things essential thereto or to take any action necessary for obtaining the granting of this Petition without further expressed consent of the Petitioners.

Cynthia M. Andrzejczyk
Cynthia M. Andrzejczyk

Joseph C. Zavala
Joseph C. Zavala

Gloria L. Krajcski
Gloria L. Krajcski

Marsha A. Andrzejczyk
Marsha A. Andrzejczyk

Michael B. Keys
City of Elyria
Michael B. Keys, Mayor

STATE OF OHIO)
) SS:
COUNTY OF LORAIN)

Sworn to before me and subscribed in my presence this 11th
day of January 1993
1994

Mary E. Szwierka
Notary Public

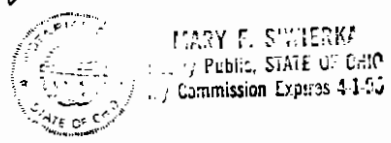

Approved as to form:
Terry S. Shilling
Terry S. Shilling, Solicitor

ANNEXATION: FROM ELYRIA TWP.
TO ELYRIA CITY

RES NO. 94-360

MAY 5 1994

016 ✓
 12.64A

- 022
 10.63A

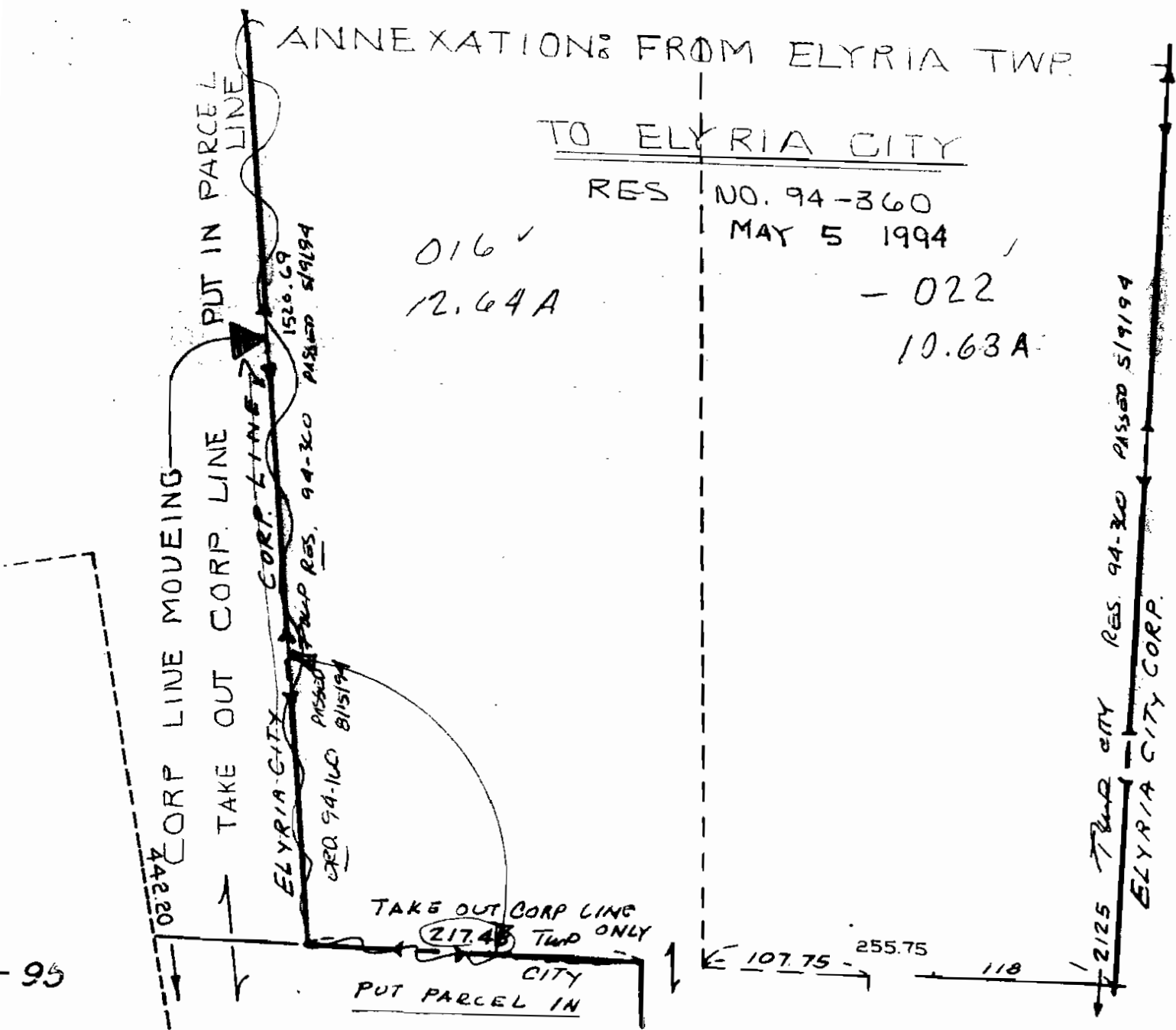

WEST OF
 NE ly PT.
 N ly PT. L

20996 X

APPROVED LORAIN CO. MAP DEPT
DATE 10-7-94
PAGE 6-77
BY CAROLYN FRANCIS
20996X

