

THE COMMONS OF FIELDSTONE LAKES TOWN HOMES PH. 10

BEING A RE-SUBDIVISION OF BLOCK "H" OF THE COMMONS OF FIELDSTONE LAKES TOWN HOMES PH. 9 AS SHOWN BY THE PLAT RECORDED IN VOLUME 98, PAGE 28 OF PLATS, BEING PART OF ORIGINAL EATON TOWNSHIP LOT NO. 90 & LOT NO. 91, NOW IN THE CITY OF ELYRIA, LORAIN COUNTY, OHIO

ACCEPTANCE:

FIELDSTONE LAKES, LTD. by its president Thomas G. Simon, owner of the hereon platted lands, does hereby acknowledge that this plat was made per its request and does hereby accept this plat as its free act and deed.

FIELDSTONE LAKES, LTD.

Thomas G. Simon
Thomas G. Simon, President

State of Ohio, County of Cuyahoga: SS
Before me, a Notary Public in and for said county and state, did personally appear the above-signed Thomas G. Simon, who did acknowledge the making of the foregoing instrument, in witness whereof I have hereunto set my hand and official seal at Berea, Ohio, this 9TH day of AUGUST, 2013.

John M. S.
Notary Public

No Exp. DATE
my commission expires

John M. Cooney, Attorney
Notary Public - State of Ohio
My commission has no expiration date.
Section 147.03 R.C.

LAND DISTRIBUTION:

SINGLE FAMILY LOT = 0.0351 ACRE
BLOCK "H" = 7.7898 ACRES

TOTAL THIS PHASE = 7.8249 ACRES

CURVE DATA:

C 1 R = 250.00' D = 27° 32' 18" L = 120.16' T = 61.26' C = 119.01' N 77° 04' 27" E	C 2 R = 250.00' D = 27° 07' 42" L = 118.37' T = 60.32' C = 117.27' S 76° 52' 09" W	C 3 R = 250.00' D = 11° 21' 33" L = 49.56' T = 24.86' C = 49.48' S 84° 45' 14" W	C 4 R = 280.00' D = 27° 07' 42" L = 132.57' T = 67.55' C = 131.34' S 76° 52' 09" W
--	--	--	--

C 5 R = 220.00' D = 27° 32' 18" L = 105.74' T = 53.91' C = 104.73' S 77° 04' 27" W	C 6 R = 20.00' D = 90° 00' 00" L = 31.42' T = 20.00' C = 28.28' N 44° 09' 24" W	C 7 R = 100.00' D = 17° 33' 01" L = 30.63' T = 15.44' C = 30.51' S 07° 55' 54" E	C 8 R = 100.00' D = 17° 46' 58" L = 31.04' T = 15.64' C = 30.91' S 07° 48' 56" E
--	---	--	--

SHORT LINES:

L 1 = S 00° 50' 36" W 29.93'	L 2 = S 43° 55' 27" E 2.83'
L 3 = S 01° 04' 33" W 4.67'	L 4 = S 46° 04' 33" W 2.83'
L 5 = S 01° 04' 33" W 1.33'	

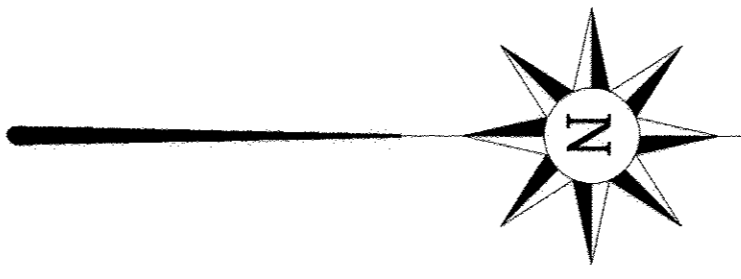
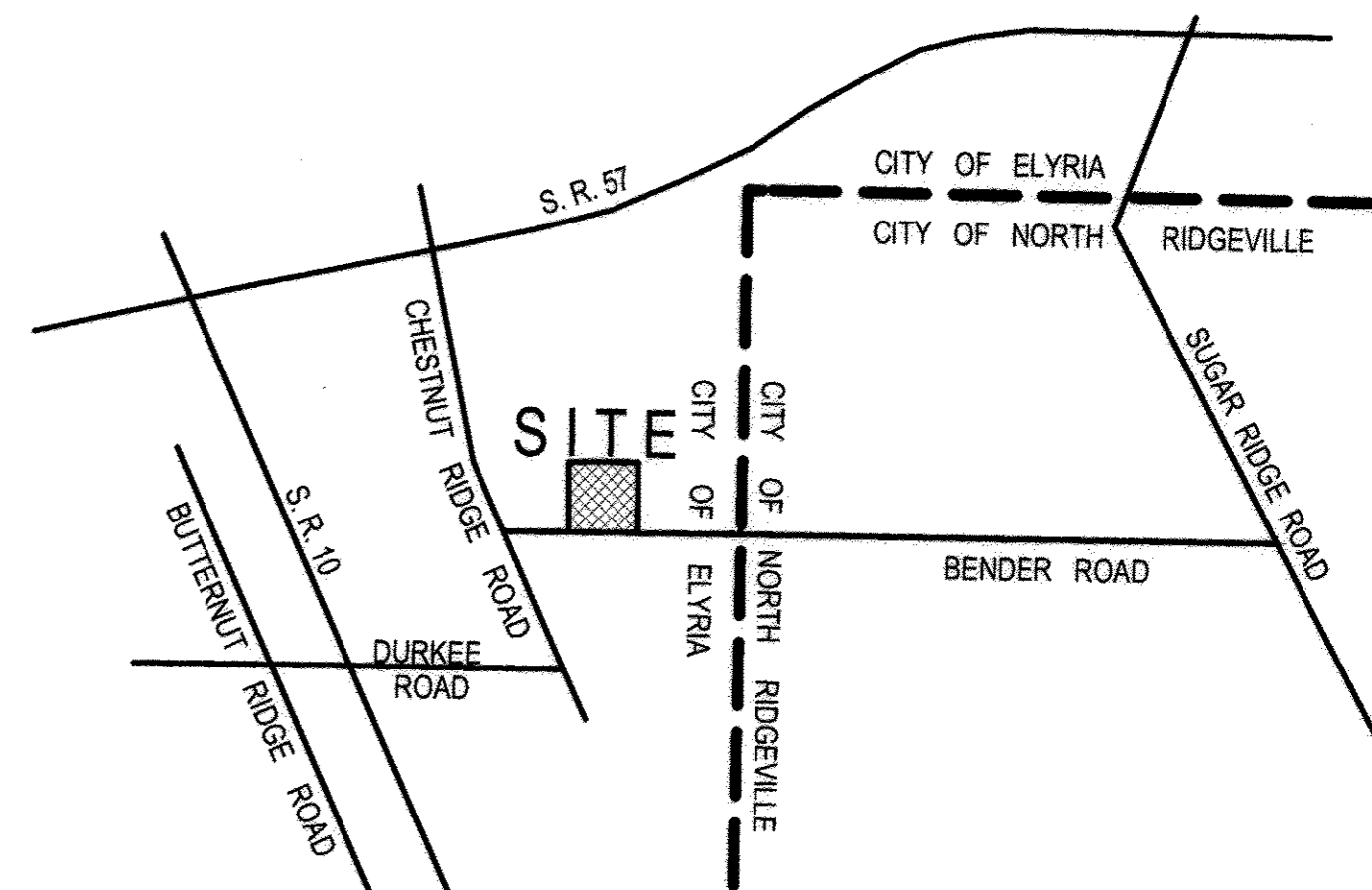

CARDINAL HOPE EXAM CO.
708 PARK AVE
ELYRIA, OH 44035

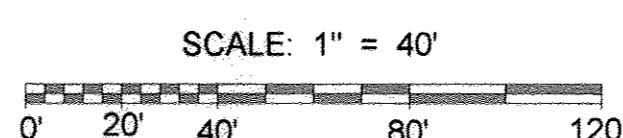

SCALE: 1" = 40'

- LEGEND:**
- - iron pin monument found & used
 - - 5/8-inch diameter iron pin found

NOTE:
ALL SUBLOTS SHOWN HEREON SHALL HAVE THE FOLLOWING BEARINGS:

north & south direction = N 01° 04' 33" E
east & west direction = N 88° 55' 27" W

NOTE: THE SUBLOTS SHOWN HEREON ARE SUBJECT TO THE "DECLARATION OF COVENANTS AND RESTRICTIONS" filed for record in Instrument No. 20060144904 and Instrument No. 20060144906 of the LORAIN COUNTY RECORDS.

PREPARED BY:
ZWICK ASSOCIATES, INC.
Engineers - Surveyors - Planners
8750 Stearns Road, Olmsted Township, Ohio 44138
Tel: (440) 235-2729 Fax: (440) 235-0604
E-mail: ZWICK@eng.ohiocxmail.com

I declare the boundary of this plat to be a true representation of BLOCK "B" of FIELDSTONE LAKES SUBDIVISION No. 1 (Plat Volume 88, Pages 5-7) and a subdivision thereof. Distances are given in feet and decimal parts thereof. North datum used is the bearing of record for the centerline of Bender Road as shown on said plat. Property corners were found or set as indicated. All iron pins set are 5/8-inch diameter, 30 inches long, with "ZWICK" cap.

Peter D. Zwick
Peter D. Zwick, P. S. No. 7429 August 09, 2013



TRANSFERRED
IN COMPLIANCE WITH SEC. 319-22
OHIO REV. CODE
AUG 16 2013
J. CRAIG SNODGRASS, CPA, CGFM
LORAIN COUNTY AUDITOR

O. L. 91
O. L. 90

O. L. 91
O. L. 90

BLOCK "C" of FIELDSTONE LAKES SUBDIVISION No. 1

N 01° 00' 01" E 574.06' record & used

BLOCK "H"

CARRINGTON COURT (private roadway)

BRECKENRIDGE OVAL (private roadway)

BRECKENRIDGE OVAL (private roadway)

BENDER ROAD 50'

BLOCK "A" of FIELDSTONE LAKES SUBDIVISION No. 1

FIELDSTONE DRIVE 60'

1.7898 ACRES

Edward Krecic & Anthony Krecic DEED Vol. 862, Pg. 531 PPN 11-00-090-000-030