

THE COMMONS OF FIELDSTONE LAKES TOWN HOMES PH. 8

BEING A RE-SUBDIVISION OF BLOCK "F" OF THE COMMONS OF FIELDSTONE LAKES TOWN HOMES PH. 7 AS SHOWN BY THE PLAT RECORDED IN VOLUME 97, PAGE 63 OF PLATS, BEING PART OF ORIGINAL EATON TOWNSHIP LOT NO. 90 & LOT NO. 91, NOW IN THE CITY OF ELYRIA, LORAIN COUNTY, OHIO

ACCEPTANCE:

FIELDSTONE LAKES, LTD. by its president Thomas G. Simon, owner of the hereon platted lands, does hereby acknowledge that this plat was made per its request and does hereby accept this plat as its free act and deed.

FIELDSTONE LAKES, LTD.

Thomas G. Simon
Thomas G. Simon, President

State of Ohio, County of Cuyahoga: SS
Before me, a Notary Public in and for said county and state, did personally appear the above-signed Thomas G. Simon, who did acknowledge the making of the foregoing instrument, in witness whereof I have hereunto set my hand and official seal at Berea, Ohio, this 15 day of June, 2012.

Thomas M. Burke 2/23/15
Notary Public my commission expires

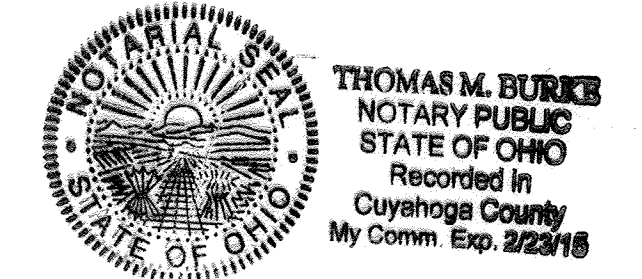

LAND DISTRIBUTION:

SINGLE FAMILY LOT = 0.0394 ACRE
BLOCK "G" = 7.8643 ACRES

TOTAL THIS PHASE = 7.9037 ACRES

CURVE DATA:

C1 R = 250.00' D = 27° 32' 18" L = 120.16' T = 61.26' C = 119.01' N 77° 04' 27" E	C2 R = 250.00' D = 27° 07' 42" L = 118.37' T = 60.32' C = 117.27' S 76° 52' 09" W	C3 R = 250.00' D = 11° 21' 33" L = 49.56' T = 24.86' C = 49.48' S 84° 45' 14" W	C4 R = 280.00' D = 27° 07' 42" L = 132.57' T = 67.55' C = 131.34' S 76° 52' 09" W
---	---	---	---

C5 R = 220.00' D = 27° 32' 18" L = 105.74' T = 53.91' C = 104.73' S 77° 04' 27" W	C6 R = 20.00' D = 90° 00' 00" L = 31.42' T = 20.00' C = 28.28' N 44° 09' 24" W	C7 R = 100.00' D = 17° 33' 01" L = 30.63' T = 15.44' C = 30.51' S 07° 55' 54" E	C8 R = 100.00' D = 17° 46' 58" L = 31.04' T = 15.64' C = 30.91' S 07° 48' 56" E
---	--	---	---

C9 R = 35.00' D = 89° 50' 43" L = 54.88' T = 34.91' C = 49.43' N 45° 59' 55" E	SHORT LINES: L1 = S 00° 50' 36" W 29.93' L2 = S 43° 55' 27" E 2.83' L3 = S 01° 04' 33" W 4.67' L4 = S 46° 04' 33" W 2.83' L5 = S 01° 04' 33" W 1.33'
--	--

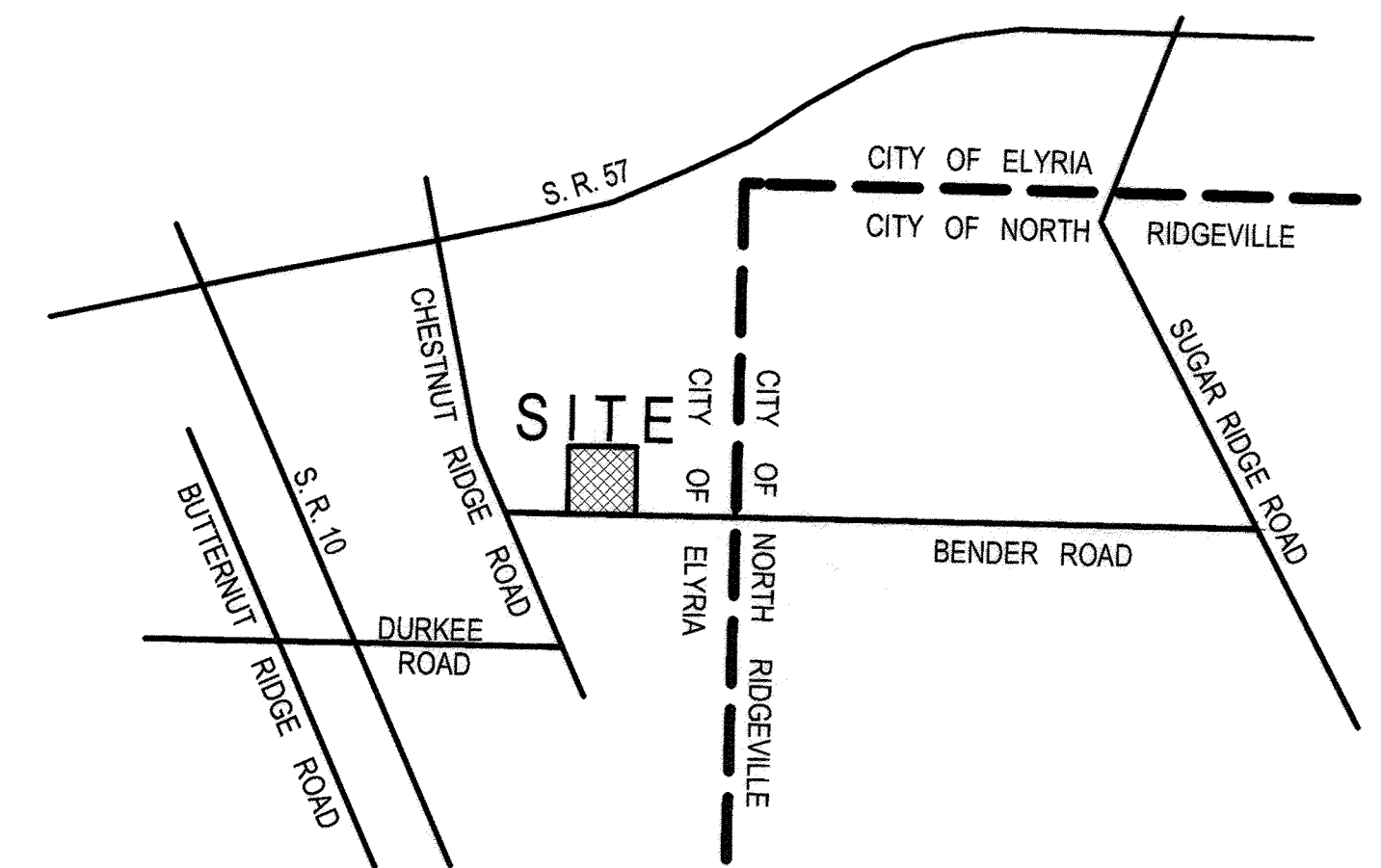

VICINITY MAP

NOT TO SCALE

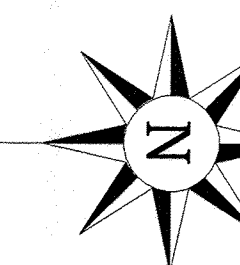

SCALE: 1" = 40'



LEGEND:

- - iron pin monument found & used
- - 5/8-inch diameter iron pin found

NOTE:
ALL SUBLOTS SHOWN HEREON SHALL HAVE THE FOLLOWING BEARINGS:

north & south direction = N 01° 04' 33" E
east & west direction = N 88° 55' 27" W

NOTE: THE SUBLOTS SHOWN HEREON ARE SUBJECT TO THE "DECLARATION OF COVENANTS AND RESTRICTIONS" filed for record in Instrument No. 20060144904 and Instrument No. 20060144906 of the LORAIN COUNTY RECORDS.



Doc ID: 0169990001 Type: OFF
Kind: PLAT
Recorded: 06/22/2012 at 03:44:54 PM
Fee Amt: \$90.40 Page 1 of 1
Lorain County, Ohio
Judith M. Hedrick, County Recorder
File: 2012-0417929

STEWART TITLE 216-771-2100

Vol 97
Pg 67

PREPARED BY:
ZWICK ASSOCIATES, INC.

Engineers - Surveyors - Planners

8750 Stearns Road, Olmsted Township, Ohio 44138
Tel: (440) 235 - 2729 Fax: (440) 235 - 0604
E-mail: ZWICK@eng.ohiocoxmail.com

I declare the boundary of this plat to be a true representation of BLOCK "B" of FIELDSTONE LAKES SUBDIVISION No. 1 (Plat Volume 88, Pages 5-7) and a subdivision thereof. Distances are given in feet and decimal parts thereof. North datum used is the bearing of record for the centerline of Bender Road as shown on said plat. Property corners were found or set as indicated. All iron pins set are 5/8-inch diameter, 30 inches long, with "ZWICK" cap.

Peter D. Zwick
Peter D. Zwick, P. S. No. 7429 June 14, 2012



TRANSFERRED
IN COMPLIANCE WITH SEC. 319-207
OHIO REV. CODE

JUN 22 2012 *Stewart*

MARK R. STEWART
LORAIN COUNTY AUDITOR

Edward Krecic & Anthony Krecic DEED Vol. 862, Pg. 531 PPN 11 - 00 - 090 - 000 - 030

