

MARTIN'S RUN DRIVE DEDICATION PLAT

BEING PART OF
BLACK RIVER TOWNSHIP ORIGINAL LOT 1, TRACT 3 & ORIGINAL LOT 11, TRACT 2
CITY OF LORAIN, COUNTY OF LORAIN, STATE OF OHIO

OWNER'S CERTIFICATE

THIS IS TO CERTIFY THAT THE UNDERSIGNED, OSTER CONSTRUCTION, INC. BY THOMAS J. OSTER, ITS PRESIDENT, OWNER OF LAND CONTAINED WITHIN THIS DEDICATION PLAT OF MARTIN'S RUN DRIVE, DOES HEREBY ACCEPT IT TO BE CORRECT AND DEDICATES FOREVER TO PUBLIC USE THE STREETS AND EASEMENTS AS SHOWN HEREON.

OSTER CONSTRUCTION INC.

BY: Thomas J. Oster, President
THOMAS J. OSTER PRESIDENT

WITNESS BY: _____
WITNESS BY: _____

NOTARY CERTIFICATE

STATE OF OHIO SS
LORAIN COUNTY
BEFORE ME, A NOTARY PUBLIC, IN AND FOR SAID COUNTY AND STATE DID PERSONALLY APPEAR THOMAS J. OSTER, REPRESENTING OSTER CONSTRUCTION INC., OWNER OF THE LAND CONTAINED WITHIN THIS DEDICATION PLAT, WHO ACKNOWLEDGED THAT HE DID SIGN THIS FOREGOING PLAT AND THAT IT WAS HIS OWN FREE ACT AND DEED. IN TESTIMONY WHEREOF, I HAVE SET MY HAND AND OFFICIAL SEAL ON THIS 21st DAY OF May, 2005.

Rebecca Rodriguez
NOTARY PUBLIC
MY COMMISSION EXPIRES 3/28/09

UNDERGROUND UTILITIES

THE OWNER OF THE WITHIN PLATTED LAND DOES HEREBY GRANT UNTO THE OHIO EDISON CO., CENTURY TELEPHONE OF OHIO, AND ADELPHIA CABLE COMMUNICATION, INC. THEIR SUCCESSORS AND ASSIGNEES, (HEREINAFTER REFERRED TO AS THE GRANTEE), A PERMANENT RIGHT OF WAY EASEMENT TWELVE FEET (12') IN WIDTH OVER, UNDER AND THROUGH ALL SUBLOTS AND ALL LANDS SHOWN HEREON AND PARALLEL WITH AND CONTIGUOUS TO ALL STREET LINES, EXCEPT WHERE SHOWN OTHERWISE, TO CONSTRUCT, PLACE, OPERATE, MAINTAIN, REPAIR, RECONSTRUCT AND RELOCATE SUCH UNDERGROUND ELECTRIC AND COMMUNICATION CABLES, DUCTS, CONDUITS SURFACE OR BELOW GROUND, MOUNTED TRANSFORMERS, PEDESTALS, CONCRETE PADS AND OTHER FACILITIES AS ARE NECESSARY AND CONVENIENT FOR THE GRANTEE TO DISTRIBUTE AND TRANSMIT ELECTRICITY AND COMMUNICATIONS SIGNALS FOR PUBLIC AND PRIVATE USE AT SUCH LOCATIONS AS GRANTEE MAY DETERMINE UPON, WITHIN AND ACROSS THE EASEMENT PREMISES. SAID EASEMENT SHALL INCLUDE THE RIGHT TO INSTALL, MAINTAIN, REPAIR AND AUGMENT ELECTRIC AND COMMUNICATIONS FACILITIES OUTSIDE THE ABOVE DESCRIBED PREMISES AND SHALL ALSO INCLUDE THE RIGHT OF ACCESS, INGRESS AND EGRESS TO AND FROM ANY OF THE WITHIN DESCRIBED PREMISES FOR THE PURPOSE OF EXERCISING ANY OF THE EASEMENT RIGHTS INDICATED HEREIN. GRANTEE SHALL AT THEIR EXPENSE RESTORE THE LAND TO ITS CONDITION AS IT EXISTED IMMEDIATELY PRIOR TO THE WORK PERFORMED BY GRANTEE, EXCEPT GRANTEE SHALL NOT BE RESPONSIBLE FOR REPLACING OR REPAIRING ANY PERMANENT STRUCTURES, TREES OR SHRUBS WHICH ARE LOCATED WITHIN THE EASEMENT BOUNDARIES AND ARE DAMAGED OR REMOVED AS A RESULT OF WORK PERFORMED AS PROVIDED FOR HEREIN BY GRANTEE. THE SUBLOTS SHALL BE RESTRICTED TO UNDERGROUND UTILITY SERVICE.

BY: Thomas J. Oster, President
OSTER CONSTRUCTION, INC.
6150 PARK SQUARE DRIVE
LORAIN, OH. 44053
(440) 985-7440

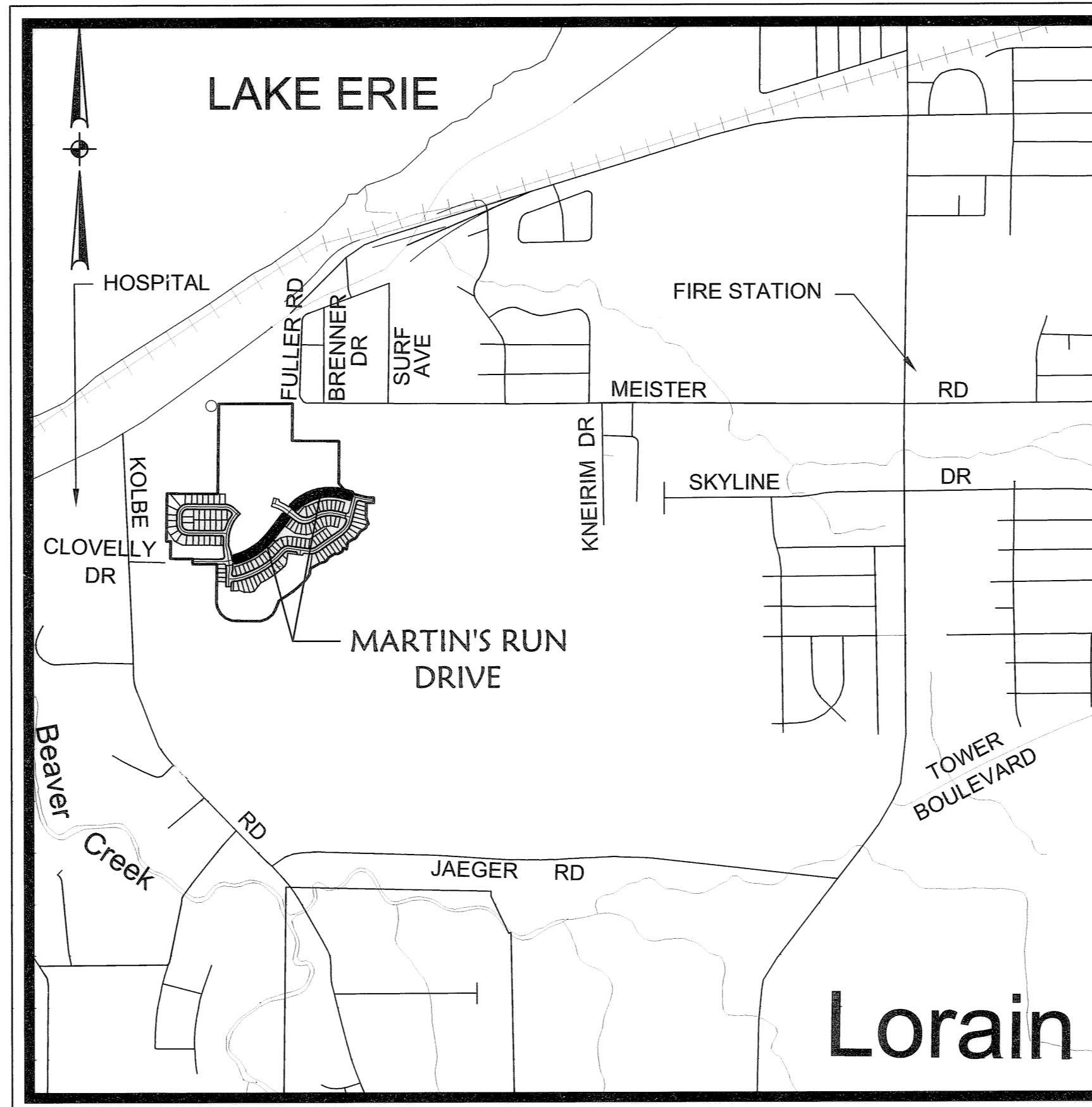

VICINITY MAP NO SCALE

SURVEYOR'S CERTIFICATE

THIS IS TO CERTIFY THAT AT THE REQUEST OF THE OWNERS I HAVE SURVEYED AND PLATTED "MARTIN'S RUN DRIVE" AS SHOWN HEREON AND CONTAINING 2.0892 ACRES OF LAND IN BLACK RIVER TOWNSHIP ORIGINAL LOT 1 IN TRACT 3 AND ORIGINAL LOT 11 IN TRACT 2 IN THE CITY OF LORAIN, COUNTY OF LORAIN, AND STATE OF OHIO. AT ALL POINTS THUSLY INDICATED, IRON PIN MONUMENTS WERE FOUND AND AT ALL POINTS THUSLY INDICATED, IRON PIN MONUMENTS WERE SET. DISTANCES ARE SHOWN IN FEET AND DECIMAL PARTS THEREOF. BEARINGS SHOWN ARE ASSUMED AND USED TO DESCRIBE ANGLES ONLY. THIS PLAT REPRESENTS A SURVEY IN WHICH THE TRAVERSE OF THE EXTERIOR BOUNDARIES OF THE TRACT AND OF EACH BLOCK WHEN COMPUTED FROM FIELD MEASUREMENTS OF THE GROUND CLOSED WITHIN A LIMIT OF ERROR OF ONE (1) FOOT TO TEN THOUSAND (10,000) FEET OF THE PERIMETER BEFORE BALANCING THE SURVEY. THE SURVEY MEETS THE MINIMUM STANDARDS FOR LAND SURVEYS, IN SECTION 4733-37 OF THE OHIO ADMINISTRATIVE CODE AND ADJACENT PROPERTY DESCRIPTIONS HAVE BEEN CONSIDERED IN PERFORMING THIS SURVEY. ALL OF WHICH I CERTIFY TO BE CORRECT.

AREA IN R/W 2.0892 ACRES
TOTAL AREA IN PROJECT 2.0892 ACRES

AREA IN O.L. 1, TRACT 3 1.1013 ACRES
AREA IN O.L. 11, TRACT 2 0.9879 ACRES
TOTAL AREA IN PROJECT 2.0892 ACRES

LEGEND

- ☒ EXISTING MONUMENT BOX
- ⊙ IRON PIPE/ IRON PIN/ 5/8"x30" KS CAPPED PIN FOUND LABELED "KS ASSOCS INC PROP MARKER"
- ☒ PROPOSED MONUMENT BOX
- 5/8"x30" KS CAPPED PIN SET LABELED "KS ASSOCS INC PROP MARKER"

David L. Elwell
DAVID L. ELWELL
REGISTERED SURVEYOR NO 6333

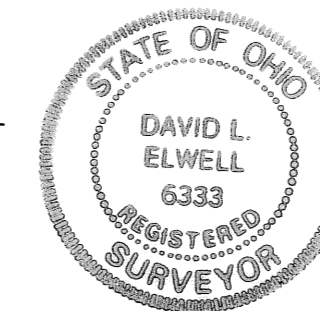

MORTGAGEES CERTIFICATE

THIS IS TO CERTIFY THAT THE UNDERSIGNED, REPRESENTING HUNTINGTON NATIONAL BANK MORTGAGEE OF LAND CONTAINED WITHIN THIS DEDICATION PLAT OF MARTIN'S RUN DRIVE, HAS EXAMINED THIS PLAT OF THE SAME, ACCEPTS IT TO BE CORRECT, AND DEDICATES FOREVER TO PUBLIC USE THE STREETS AND EASEMENTS AS SHOWN HEREON.

Marie Nagy Vice President
REPRESENTATIVE TITLE
WITNESS WITNESS

MORTGAGEE'S NOTARY CERTIFICATE

STATE OF OHIO SS
LORAIN COUNTY
BEFORE ME, A NOTARY PUBLIC IN AND FOR SAID COUNTY AND STATE DID PERSONALLY APPEAR Marie Nagy REPRESENTING Huntington National Bank WHO ACKNOWLEDGED THAT she DID SIGN THIS FOREGOING PLAT AND THAT IT WAS her OWN FREE ACT AND DEED, IN TESTIMONY WHEREOF, I HAVE HEREUNTO SET MY HAND AND OFFICIAL SEAL ON THIS 21st DAY OF May, 2005.

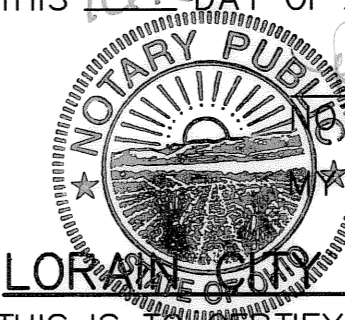

LORAIN CITY SURVEYOR CERTIFICATE

THIS IS TO CERTIFY THAT I HAVE EXAMINED THIS FOREGOING DEDICATION PLAT OF MARTIN'S RUN DRIVE AND FIND SUFFICIENT MONUMENTS SET TO DEFINE THE STREETS SHOWN HEREON AND APPROVE SAME.
Patrick A. McGannon 5-27-05
PATRICK A. MCGANNON, PS DATE
LORAIN CITY SURVEYOR

COUNCIL CERTIFICATE

THIS IS TO CERTIFY THAT THIS FOREGOING DEDICATION PLAT OF MARTIN'S RUN DRIVE WAS ACCEPTED BY THE COUNCIL OF THE CITY OF LORAIN
BY ORDINANCE NO. 76-05
PASSED THIS 26th DAY OF May, 2005.
Harvey Green
CLERK OF COUNCIL

PLANNING COMMISSION

THIS IS TO CERTIFY THAT THIS FOREGOING DEDICATION PLAT OF MARTIN'S RUN DRIVE IS HEREBY APPROVED BY THE PLANNING COMMISSION OF THE CITY OF LORAIN, OHIO.
Carol Foster 5/25/05
CHAIRMAN, CITY OF LORAIN DATE
PLANNING COMMISSION

LAW DIRECTOR'S CERTIFICATE

THIS IS TO CERTIFY THAT THIS FOREGOING DEDICATION PLAT OF MARTIN'S RUN DRIVE IS COVERED BY A PROPER CERTIFICATE OF TITLE AND THE PLAT IS HEREBY APPROVED AS TO FORM.
Mad R. Perenna 5-2-05
LAW DIRECTOR, CITY OF LORAIN DATE

PARK DEPARTMENT CERTIFICATE

THIS IS TO CERTIFY THAT THE REQUIREMENTS OF SECTION 1111.05 AS APPROVED BY ORDINANCE NO. 186-85 OF THE CODIFIED ORDINANCES OF THE CITY OF LORAIN HAVE BEEN MET; WHEREIN THE PARK DEDICATION HAS BEEN WAIVED AND OTHER CONSIDERATIONS ACCEPTED, IN LIEU THEREOF.
Craig Miller 5/15/05
DIRECTOR OF PUBLIC SERVICE DATE

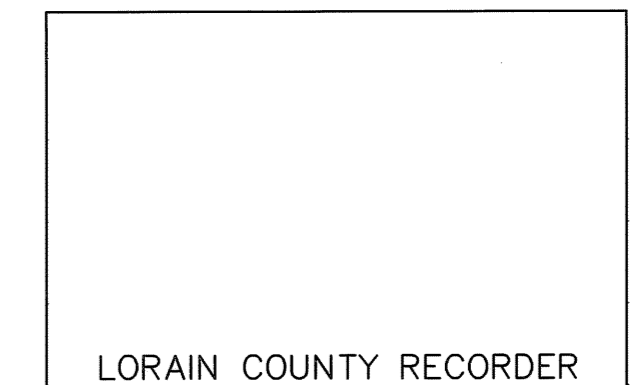
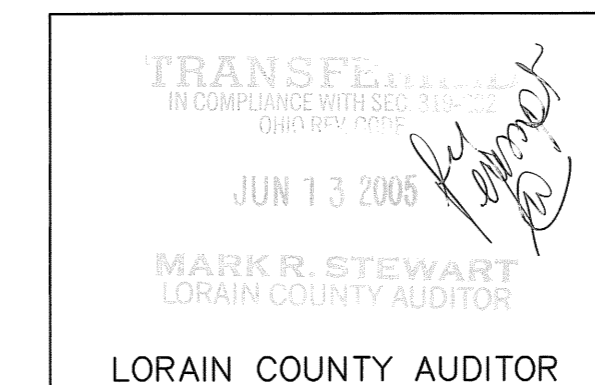

BY	
DESCRIPTION	
DATE	
REVISIONS	
DATE	
DRAWN BY	DAM
CHECKED BY	D.R. DUE
DWG. NAME	MRD-PLATS
PATH	E:\MORRIS\AUDIT\CONTROL
F.B.	
DATE	04-21-04
KS Associates, Inc.	100
260 Burns Rd., Suite 100	
Elvins, Ohio 44035	
Phone (440) 365-4730	
Fax (440) 365-4770	
mailroom@ksassoc.com	
www.ksassoc.com	
KS ASSOCIATES	
DEDICATION PLAT	
MARTIN'S RUN DRIVE	
OF PART OF	
BLACK RIVER TOWNSHIP ORIG. LOT 1, TRACT 3 & ORIG. LOT 11, TRACT 2	
CITY OF LORAIN COUNTY OF LORAIN STATE OF OHIO	
SHEET	1
OF	3
JOB NO.	04068

