

DEERFIELD ESTATES SUBDIVISION NO. 1

BEING PART OF ORIGINAL AMHERST TOWNSHIP
LOT NOS. 1 AND 100
CITY OF LORAIN, COUNTY OF LORAIN, STATE OF OHIO

THIS IS TO CERTIFY THAT AT THE REQUEST OF THE OWNER I HAVE SURVEYED AND PLATTED "DEERFIELD ESTATES SUBDIVISION NO. 1" AS SHOWN HEREON AND CONTAINING 34.5778 ACRES OF LAND IN ORIGINAL LOT NOS. 1 AND 100 OF AMHERST TOWNSHIP, CITY OF LORAIN, COUNTY OF LORAIN AND STATE OF OHIO. IRON PINS HAVE EITHER BEEN SET OR WILL BE SET AT ALL POINTS INDICATED ON THE PLAT. DISTANCES ARE SHOWN IN FEET AND IN DECIMAL PARTS THEREOF. BEARINGS SHOWN ARE ASSUMED AND USED TO DESCRIBE ANGLES ONLY. THE PLAN REPRESENTS A SURVEY IN WHICH THE TRAVERSE OF THE EXTERIOR BOUNDARIES WHEN COMPUTED FROM FIELD MEASUREMENTS OF THE GROUND CLOSED WITHIN A LIMIT OF ERROR OF ONE (1) FOOT TO TEN THOUSAND (10,000) FEET OF THE PERIMETER BEFORE BALANCING THE SURVEY.

AREA IN SUBLOTS - 15.9331 AC. (SUBLOTS 1 TO 59 INCLUSIVE)
 AREA IN BLOCKS A THRU H - 11.3090 AC.
 AREA IN R/W - 7.3357 AC.
 AREA IN SUBD. NO. 1 - 34.5778 AC.
 REMAINDER - 85.7830 AC.

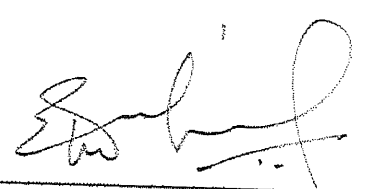

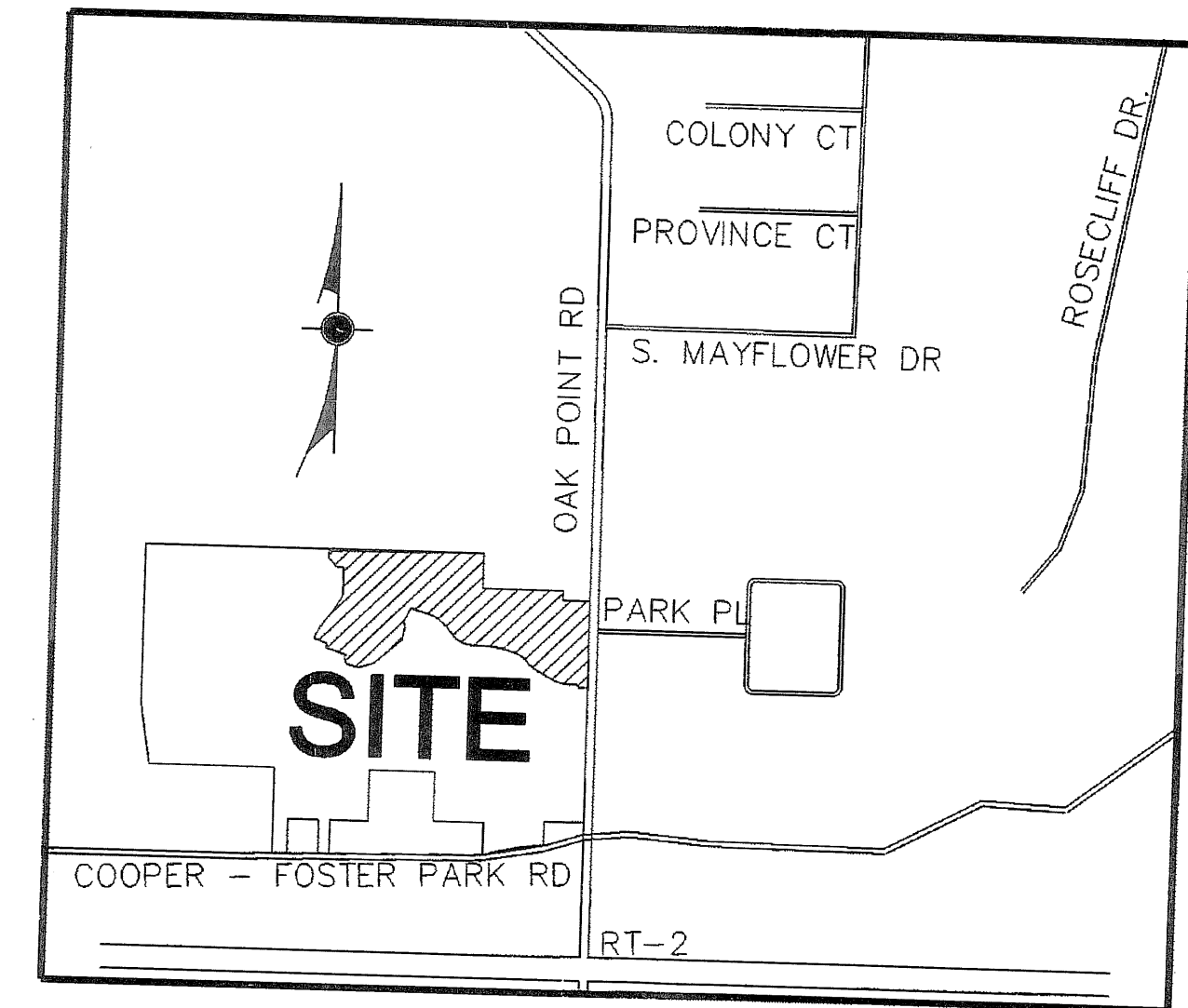
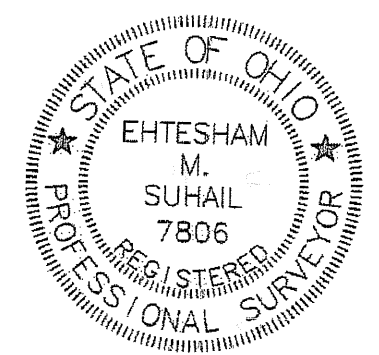
 EHTESHAM M. SUHAIL, P.E., P.S.



LOCATION MAP - NOT TO SCALE

OWNERS CERTIFICATE

THIS IS TO CERTIFY THAT THE UNDERSIGNED, JOHN MCGILL REPRESENTING AMHERST DEVELOPMENT, LLC OWNER OF LAND CONTAINED WITHIN THIS PLAT OF DEERFIELD ESTATES SUBDIVISION NO. 1, DOES HEREBY ACCEPT IT TO BE CORRECT AND DEDICATE FOREVER TO PUBLIC USE THE ROADWAYS AND EASEMENTS AS SHOWN HEREON, INCLUDING A STORM SEWER AND DRAINAGE EASEMENTS.

BY: 
 JOHN MCGILL, PRESIDENT
 AMHERST DEVELOPMENT, L.L.C.

STATE OF OHIO } SS
 LORAIN COUNTY }

BEFORE ME, A NOTARY PUBLIC IN AND FOR SAID COUNTY AND STATE, DID PERSONALLY APPEAR JOHN MCGILL, PRESIDENT, AMHERST DEVELOPMENT, LLC WHO ACKNOWLEDGED THE SIGNING OF THIS PLAT TO BE HIS OWN FREE ACT AND DEED INDIVIDUALLY AND AS SUCH OFFICER, AND THE FREE ACT AND DEED OF SAID ENTITY. IN TESTIMONY THEREOF I HAVE HEREUNTO SET MY HAND AND OFFICIAL SEAL THIS 19 DAY OF November 2004.



 DIANE B. DICARRO
 NOTARY PUBLIC

MY COMM. EXPIRES  FEB. 7, 2005

UTILITY EASEMENT

AMHERST DEVELOPMENT, LLC, THE OWNER OF THE WITHIN PLATTED LAND DO HEREBY GRANT INTO THE OHIO EDISON CO., COLUMBIA GAS OF OHIO, CENTURY TELEPHONE OF OHIO, AND ADELPHIA CABLE COMMUNICATION, INC., THEIR SUCCESSORS AND ASSIGNEES, (HEREINAFTER REFERRED TO AS THE GRANTEEES), A PERMANENT RIGHT OF WAY EASEMENT TWELVE FEET (12') IN WIDTH OVER, UNDER AND THROUGH ALL SUBLOTS AND ALL LANDS SHOWN HEREON AND PARALLEL WITH AND CONTIGUOUS TO ALL STREET LINES, EXCEPT WHERE SHOWN OTHERWISE, TO CONSTRUCT, PLACE, OPERATE, MAINTAIN, REPAIR, RECONSTRUCT AND RELOCATE SUCH UNDERGROUND ELECTRIC AND COMMUNICATION CABLES, DUCTS, CONDUITS SURFACE OR BELOW GROUND, MOUNTED TRANSFORMERS, PEDESTALS, CONCRETE PADS AND OTHER FACILITIES AS ARE NECESSARY AND CONVENIENT FOR THE GRANTEEES TO DISTRIBUTE AND TRANSMIT ELECTRICITY AND COMMUNICATIONS SIGNALS FOR PUBLIC AND PRIVATE USE AT SUCH LOCATIONS AS GRANTEEES MAY DETERMINE UPON, WITHIN AND ACROSS THE EASEMENT PREMISES. SAID EASEMENT SHALL INCLUDE THE RIGHT TO INSTALL, MAINTAIN, REPAIR AND AUGMENT ELECTRIC AND COMMUNICATIONS FACILITIES OUTSIDE THE ABOVE DESCRIBED PREMISES AND SHALL ALSO INCLUDE THE RIGHT OF ACCESS, INGRESS AND EGRESS TO AND FROM ANY OF THE WITHIN DESCRIBED PREMISES FOR THE PURPOSE OF EXERCISING ANY OF THE EASEMENT RIGHTS INDICATED HEREIN. GRANTEEES SHALL AT THEIR EXPENSE RESTORE THE LAND TO ITS CONDITION AS IT EXISTED IMMEDIATELY PRIOR TO THE WORK PERFORMED BY GRANTEEES, EXCEPT GRANTEEES SHALL NOT BE RESPONSIBLE FOR REPLACING OR REPAIRING ANY PERMANENT STRUCTURES, TREES OR SHRUBS WHICH ARE LOCATED WITHIN THE EASEMENT BOUNDARIES AND ARE DAMAGED OR REMOVED AS A RESULT OF WORK PERFORMED AS PROVIDED FOR HEREIN BY GRANTEEES. THE SUBLOTS SHALL BE RESTRICTED TO UNDERGROUND UTILITY SERVICE.

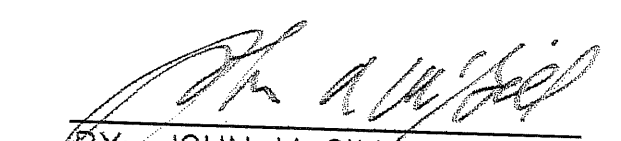
AMHERST DEVELOPMENT, L.L.C.

 JOHN MCGILL
 PRESIDENT

APPROVALS

CITY SURVEYOR'S CERTIFICATE

THIS IS TO CERTIFY THAT I HAVE EXAMINED THIS FOREGOING PLAT OF THE DEDICATION OF DEERFIELD ESTATES SUBDIVISION NO. 1 AND FIND SUFFICIENT MONUMENTS SET TO DEFINE THE STREET SHOWN HEREON AND APPROVE SAME.

 LORAIN CITY SURVEYOR
 PATRICK A. MCGANNON, P.S.

March 9, 2005
 DATE

COUNCIL CERTIFICATE

THIS IS TO CERTIFY THAT THIS FOREGOING PLAT OF THE DEDICATION OF DEERFIELD ESTATES SUBDIVISION NO. 1 WAS ACCEPTED BY THE COUNCIL OF THE CITY OF LORAIN BY ORDINANCE NO. 33-05 PASSED THIS 7th DAY OF March 2005.

 CLERK OF COUNCIL

PLANNING COMMISSION

THIS IS TO CERTIFY THAT THIS FOREGOING PLAT OF THE DEDICATION OF DEERFIELD ESTATES SUBDIVISION NO. 1 IS HEREBY APPROVED BY THE PLANNING COMMISSION OF THE CITY OF LORAIN, OHIO.

 CHAIRMAN, CITY OF LORAIN
 PLANNING COMMISSION

3-8-05
 DATE

LAW DIRECTOR CERTIFICATE

THIS IS TO CERTIFY THAT THIS FOREGOING PLAT OF THE DEDICATION OF DEERFIELD ESTATES SUBDIVISION NO. 1 IS COVERED BY A PROPER CERTIFICATE OF TITLE AND THE DEDICATION IS HEREBY APPROVED AS TO FORM.

 LAW DIRECTOR, CITY OF LORAIN

3-8-05
 DATE

PARK DEPARTMENT CERTIFICATE

THIS IS TO CERTIFY THAT THE REQUIREMENTS OF SECTION 1111.05 AS APPROVED BY ORDINANCE NO. 186-85 OF THE CODIFIED ORDINANCES OF THE CITY OF LORAIN HAVE BEEN MET; WHEREIN THE PARK DEDICATION HAS BEEN WAIVED AND OTHER CONSIDERATIONS ACCEPTED IN LIEU THEREOF.

 DIRECTOR OF PUBLIC SERVICE

3/8/05
 DATE

MORTGAGEE'S CERTIFICATION

THIS IS TO CERTIFY THAT THE UNDERSIGNED John M. Osbeck REPRESENTING National City Bank AS MORTGAGEE OF LANDS SHOWN HEREON, DOES HEREBY ACCEPT THIS PLAT OF "DEERFIELD ESTATES SUBDIVISION NO. 1" TO BE CORRECT AND DOES DEDICATE TO PUBLIC USE THE ROADWAYS AND EASEMENTS AS SHOWN HEREON.

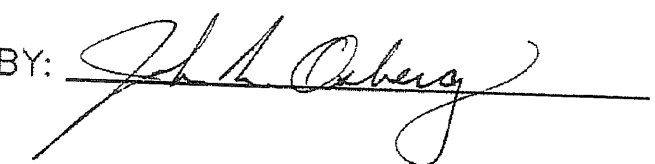
BY: 

STATE OF OHIO } SS
 LORAIN COUNTY }

BEFORE ME, A NOTARY PUBLIC IN AND FOR SAID COUNTY AND STATE, DID PERSONALLY APPEAR John M. Osbeck REPRESENTING National City Bank WHO ACKNOWLEDGED THE SIGNING OF THIS PLAT TO BE HIS OWN FREE ACT AND DEED.

IN TESTIMONY THEREOF I HAVE HEREUNTO SET MY HAND AND OFFICIAL SEAL THIS 13th DAY OF December 2004.

 NOTARY PUBLIC

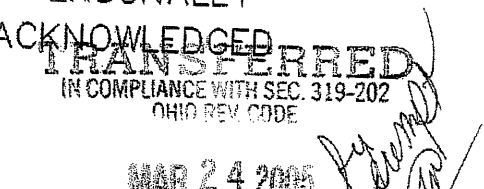

MY COMM. EXPIRES

NO.	DATE	BY	REVISIONS	REFERENCE DRAWINGS

Suhail & Suhail Inc.
 Consulting Engineers & Surveyors
 8401 Chagrin Road, Suite 17
 Chagrin Falls, Ohio 44023
 (440) 708-1330 Fax: (440) 708-1348

DR. BY HS
 CHK. BY EMS
 DATE NOV. 16, 2004
 SCALE N.T.S

**DEERFIELD ESTATES
SUBDIVISION NO. 1**
 BEING PART OF ORIGINAL AMHERST TOWNSHIP LOT NOS. 1 AND 100
 CITY OF LORAIN, COUNTY OF LORAIN, STATE OF OHIO

**COVER SHEET
FINAL PLAT**

PREPARED FOR
AMHERST DEVELOPMENT, LLC
 30575 Bainbridge Road, Suite 100
 Solon, Ohio 44139

S&S JOB NO. **03150**
 SHEET NO. **1 OF 3**

NUMBER	DELTA ANGLE	CHORD DIRECTION	TANGENT	RADIUS	ARC LENGTH	CHORD LENGTH
C116	29°30'09"	S 75°29'45" E	78.99	300.00	154.47	152.77
C117	89°45'11"	N 44°52'35" E	29.87	30.00	46.99	42.33
C118	96°22'46"	S 77°29'00" E	33.54	30.00	60.46	44.72
C119	78°41'24"	S 10°03'05" W	57.39	120.00	96.14	88.76
C120	59°29'46"	S 79°08'41" W	68.58	120.00	124.61	119.09
C121	11°42'52"	N 65°15'00" W	12.31	120.00	24.53	24.49
C122	90°50'10"	N 13°58'29" W	30.44	30.00	47.56	42.73
C123	09°59'06"	N 36°26'10" E	60.23	575.00	100.21	100.08
C124	09°14'09"	N 46°02'47" E	46.44	575.00	92.69	92.59
C125	03°39'46"	N 52°29'44" E	18.23	570.00	36.44	36.43

NUMBER	DELTA ANGLE	CHORD DIRECTION	TANGENT	RADIUS	ARC LENGTH	CHORD LENGTH
C126	180°00'00"	S 00°14'49" E	0.00	15.00	47.12	30.00
C127	12°01'20"	S 84°14'09" E	38.43	385.00	76.59	76.45
C128	180°00'00"	N 11°46'31" E	0.00	15.00	47.12	30.00
C129	12°01'20"	S 84°14'09" E	35.28	335.00	70.29	70.16
C130	180°00'00"	S 29°15'20" W	0.00	15.00	47.12	30.00
C131	07°58'15"	N 49°55'22" W	22.25	319.36	44.43	44.39
C132	165°49'40"	S 36°20'30" W	88.49	11.00	31.84	21.63
C133	130°54'00"	S 35°56'05" W	24.08	11.00	25.13	20.01
C134	114°04'47"	N 15°26'35" W	10.80	7.00	13.94	11.75
C135	16°01'23"	N 49°36'30" E	4.08	29.00	8.11	8.08

NUMBER	DELTA ANGLE	CHORD DIRECTION	TANGENT	RADIUS	ARC LENGTH	CHORD LENGTH
C136	00°36'57"	N 12°23'41" E	1.32	245.00	2.63	2.63
C137	11°01'42"	S 75°34'35" E	21.24	220.00	42.35	42.28
C138	08°54'34"	S 85°32'43" E	17.14	220.00	34.21	34.18

P.P. # 02-03-007-000-014
BITAR, SANDRA L.
INST. # 980633735
DRAINAGE EASEMENT
VOL. 1131, PG. 312

S 89°21'15" W 1000.06' REC. & OBS.

BLACK RIVER TWP
AMHERST TWP

IRON PIPE FD.
IN MON. BOX

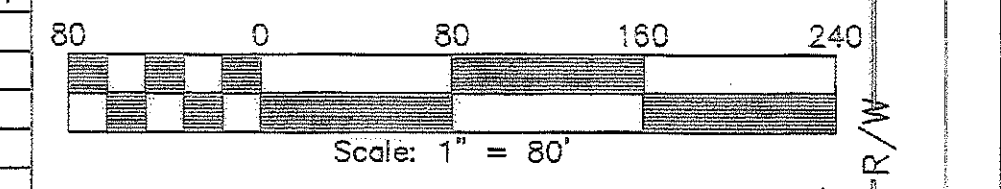

NUMBER	DELTA ANGLE	CHORD DIRECTION	TANGENT	RADIUS	ARC LENGTH	CHORD LENGTH
C1	29°30'09"	N 75°29'45" W	92.16	350.00	180.22	178.24
C2	15°32'31"	N 52°58'25" W	40.94	300.00	81.38	81.13
C3	22°30'03"	N 56°27'11" W	59.68	300.00	117.81	117.06
C4	22°17'47"	N 78°51'06" W	194.50	987.00	384.09	381.67
C5	50°19'22"	N 64°50'19" W	117.44	250.00	219.57	212.58
C6	24°00'47"	N 51°41'01" W	85.07	400.00	167.64	166.42
C7	09°47'08"	N 68°34'58" W	34.24	400.00	68.32	68.23
C8	16°25'24"	N 65°15'50" W	57.72	400.00	114.66	114.27
C9	11°48'44"	N 62°57'29" W	28.45	275.00	56.69	56.59
C10	41°42'20"	N 89°43'01" W	104.75	275.00	200.17	195.78
C11	08°43'26"	S 65°04'08" W	45.77	600.00	91.36	91.27
C12	10°02'31"	S 55°41'07" W	52.72	600.00	105.18	105.03
C13	20°03'25"	S 40°38'09" W	106.99	605.00	211.79	210.71
C14	17°52'17"	S 21°40'18" W	43.24	275.00	55.78	55.43
C15	08°17'06"	N 23°10'03" E	21.95	400.00	43.88	43.85
C16	30°45'55"	N 35°24'58" E	145.90	530.00	284.74	281.33
C17	16°04'05"	N 13°06'06" E	42.34	300.00	84.13	83.86
C18	42°37'48"	N 26°22'58" E	56.58	145.00	107.88	105.41
C19	78°41'24"	S 10°03'05" W	81.98	100.00	137.34	126.80
C20	71°2'39"	S 85°00'07" W	107.41	150.00	186.43	174.66
C21	10°21'37"	N 54°12'46" W	69.35	765.00	138.33	138.14

NUMBER	DELTA ANGLE	CHORD DIRECTION	TANGENT	RADIUS	ARC LENGTH	CHORD LENGTH
C22	90°14'49"	N 45°07'26" W	30.13	30.00	47.25	42.52
C23	29°30'09"	N 75°29'45" W	105.32	400.00	205.97	203.70
C24	21°28'35"	N 50°01'23" W	60.21	318.00	119.01	118.32
C25	28°42'02"	N 53°39'06" W	72.40	283.00	141.76	140.28
C26	21°59'53"	N 79°00'03" W	188.01	857.00	367.43	365.18
C27	50°19'22"	N 64°50'19" W	131.53	280.00	245.92	238.09
C28	33°47'54"	N 56°34'35" W	112.41	370.00	218.26	215.11
C29	07°24'28"	N 69°46'18" W	27.84	430.00	55.60	55.56
C30	09°00'51"	N 61°33'33" W	33.90	430.00	67.65	67.58
C31	44°36'55"	N 78°21'35" W	100.52	245.00	190.78	185.99
C32	08°54'09"	S 73°52'53" W	19.07	245.00	38.07	38.03
C33	02°20'40"	S 68°15'29" W	11.66	570.00	23.32	23.32
C34	96°22'46"	S 18°53'46" W	33.54	30.00	50.48	44.72
C35	13°10'59"	S 22°42'08" E	15.02	130.00	29.91	29.85
C36	20°14'09"	S 05°59'34" E	23.20	130.00	45.91	45.68
C37	22°10'30"	S 15°24'46" W	25.48	130.00	50.31	50.00
C38	23°05'48"	S 37°50'54" W	26.88	130.00	52.40	52.05
C39	08°55'31"	N 53°51'33" E	14.05	180.00	28.04	28.01
C40	19°10'59"	S 67°54'47" W	30.42	180.00	60.27	59.98
C41	20°34'23"	S 87°47'29" W	32.67	180.00	64.63	64.29
C42	21°00'55"	N 71°24'52" W	33.39	180.00	66.02	65.65
C43	01°30'51"	S 60°08'59" E	2.38	180.00	4.76	4.76
C44	92°53'00"	S 74°09'56" W	31.55	30.00	48.63	43.48
C45	15°36'13"	S 19°55'19" W	33.57	245.00	66.72	66.52

NUMBER	DIRECTION	DISTANCE
L1	S 30°36'26" W	52.05'
L2	S 30°36'26" W	49.18'
L3	S 59°23'34" E	26.13'
L4	N 21°08'09" E	49.54'
L5	N 05°04'04" E	45.62'
L6	N 47°41'51" E	9.89'
L7	N 12°16'03" E	43.85'
L8	N 32°35'44" E	66.45'
L9	N 40°58'03" E	80.00'

NUMBER	DIRECTION	DISTANCE
L45	N 89°45'11" E	81.89'
L46	S 89°45'11" W	81.89'
L47	N 60°44'40" W	165.73'
L48	S 60°44'40" E	206.64'
L49	S 11°57'45" E	59.43'

NUMBER	DIRECTION	DISTANCE
L50	S 12°01'17" W	127.75'
L51	S 49°27'04" W	357.88'
L52	S 73°04'25" W	154.04'
L53	N 78°31'12" W	124.79'
L54	N 21°46'24" W	61.19'
L55	N 72°28'58" W	33.80'

NOTE: SEE SHEET 3 FOR STORM SEWER EASEMENT DETAILS

NUMBER	DIRECTION	DISTANCE
L56	N 45°08'44" E	149.12'
L57	N 45°08'44" E	147.32'

NUMBER	DELTA ANGLE	CHORD DIRECTION	TANGENT	RADIUS	ARC LENGTH	CHORD LENGTH
C46	07°55'15"	N 16°41'47" E	21.12	305.00	42.16	42.13
C47	08°13'06"	N 24°45'58" E	21.91	305.00	43.75	43.71
C48	85°55'32"	N 14°05'16" W	27.94	30.00	44.99	40.89
C49	08°01'05"	N 53°02'29" W	55.72	795.00	111.25	111.16
C50	07°36'40"	S 52°50'17" E	48.89	735.00	97.64	97.57
C51	91°59'37"	N 77°21'34" E	31.06	30.00	48.17	43.16
C52	03°28'23"	N 33°05'57" E	19.25	635.00	38.49	38.49
C53	06°48'59"	N 38°13'38" E	37.63	635.00	76.18	75.13
C54	06°22'10"	N 44°48'12" E	35.33	635.00	70.59	70.56
C55	02°40'34"	N 49°19'34" E	14.83	635.00	29.56	29.66
C56	04°48'34"	N 53°04'39" E	28.55	630.00	53.07	53.05
C57	84°47'03"	N 13°05'54" E	27.39	30.00	44.39	40.45
C58	48°11'23"	N 53°23'19" W	13.42	30.00	25.23	24.49
C59	15°35'16"	S 69°41'22" E	8.21	60.00	16.32	16.27
C60	16°54'18"	N 31°26'35" W	35.28	60.00	63.78	60.82

NUMBER	DELTA ANGLE	CHORD DIRECTION	TANGENT	RADIUS	ARC LENGTH	CHORD LENGTH
C61	49°14'55"	N 23°38'01" E	27.50	60.00	51.57	60.00
C62	49°14'55"	N 72°52'56" E	27.50	60.00	51.57	60.00
C63	49°14'55"	S 57°52'09" E	27.50	60.00	51.57	60.00
C64	52°08'27"	S 07°10'28" E	29.36	60.00	54.60	62.74
C65	48°11'23"	S 05°11'56" E	13.42	30.00	25.23	24.49
C66	84°47'03"	S 71°41'08" E	27.39	30.00	44.39	40.45
C67	03°30'29"	N 67°40'34" E	19.29	630.00	38.57	38.57
C68	09°42'58"	N 74°17'18" E	29.92	305.00	51.72	51.66
C69	13°12'26"	N 85°45'00" E	35.31	305.00	70.31	70.15
C70	08°27'19"	S 83°25'07" E	22.55	305.00	45.01	44.97
C71	80°52'26"	N 60°22'20" E	25.57	30.00	42.35	38.82
C72	14°52'03"	N 12°30'05" E	35.23	270.00	70.05	69.86
C73	13°26'18"	N 11°47'13" E	20.62	175.00	41.04	40.95
C74	10°34'52"	N 23°47'48" E	16.21	175.00	32.32	32.27
C75	38°11'23"	N 09°59'33" E	10.39	30.00	20.00	19.83
C76	23°10'31"	N 02°29'07" E	12.30	60.00	24.27	24.10
C77	44°02'55"	N 36°05'50" E	24.27	60.00	45.13	45.00
C78	44°02'55"	N 80°08'45" E	24.27	60.00	45.13	45.00
C79	44°02'55"	S 55°48'20" E	24.27	60.00	45.13	45.00
C80	46°50'22"	S 10°21'41" E	25.99	60.00	49.05	47.70
C81	71°18'27"	S 48°42'44" W	43.04	60.00	74.67	89.95
C82	67°43'55"	S 60°29'59" W	20.13	30.00	35.46	33.44
C83	11°33'58"	S 10°51'03" W	11.65	115.00	23.21	23.18
C84	01°15'50"	N 05°41'59" E	3.84	330.00	7.28	7.28
C85	14°00'05"	S 13°19'56" W	40.52	330.00	80.64	80.44
C86	78°53'08"	S 19°08'36" E	24.68	30.00	41.30	38.12
C87	01°30'02"	N 57°48'09" W	3.99	305.00	7.99	7.99
C88	07°23'39"	S 60°44'57" E	23.91	370.00	47.75	47.72
C89	09°01'45"	S 68°57'40" E	29.21	370.00	58.31	58.25
C90	02°17'27"	S 72°19'49" E	8.60	430.00	17.19	17.19

NUMBER	DELTA ANGLE	CHORD DIRECTION	TANGENT	RADIUS	ARC LENGTH	CHORD LENGTH
C91	82°30'19"	N 67°33'45" E	26.31	30.00	43.20	39.58
C92	08°17'06"	N 23°10'03" E	20.31	370.00	40.59	40.57
C93	05°03'35"	N 22°33'17" E	24.74	560.00	49.45	49.44
C94	06°55'33"	N 28°32'51" E	33.89	560.00	67.69	67.65
C95	07°13'37"	N 35°37'26" E	35.36	560.00	70.64	70.59
C96	07°48'13"	N 43°07'21" E	38.03	560.00	75.94	75.89
C97	02°23'14"	N 48°12'05" E	11.67	560.00		

P.P. # 02-03-007-000-014
BITAR, SANDRA L.
INST. # 990633735

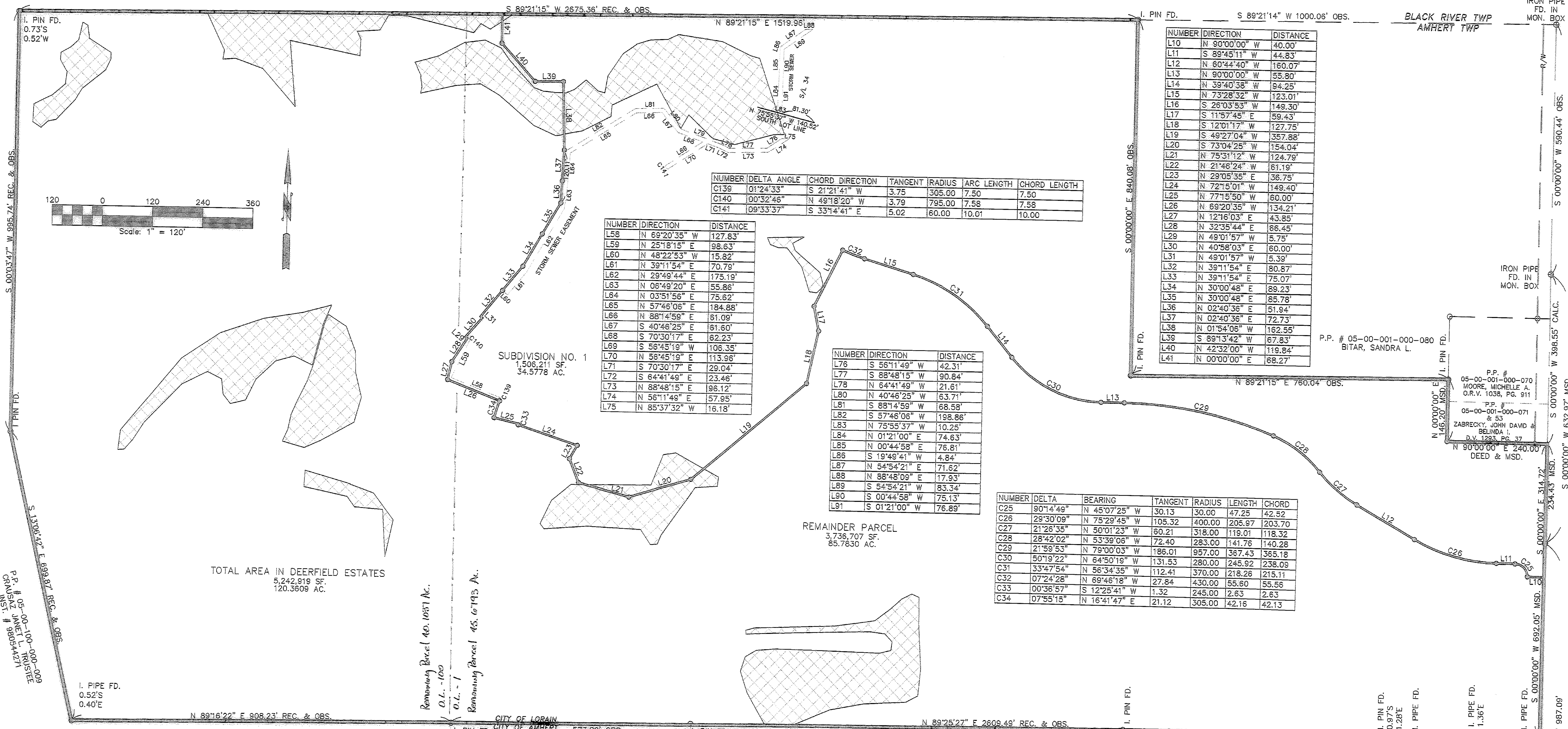

NUMBER	DELTA ANGLE	CHORD DIRECTION	TANGENT	RADIUS	ARC LENGTH	CHORD LENGTH
C139	01°24'33"	S 21°21'41" W	3.75	305.00	7.50	7.50
C140	00°32'46"	N 48°18'20" W	3.79	795.00	7.58	7.58
C141	09°33'37"	S 33°14'41" E	5.02	60.00	10.01	10.00

NUMBER	DIRECTION	DISTANCE
L58	N 60°20'35" W	127.83'
L59	N 25°18'15" E	98.63'
L60	N 48°22'53" W	15.82'
L61	N 39°11'54" E	70.79'
L62	N 29°49'44" E	175.19'
L63	N 06°49'20" E	55.86'
L64	N 03°51'56" E	75.62'
L65	N 57°45'06" E	184.88'
L66	N 88°14'58" E	61.09'
L67	S 40°46'25" E	61.60'
L68	S 70°30'17" E	62.23'
L69	S 56°45'19" W	106.35'
L70	N 56°45'19" E	113.96'
L71	S 70°30'17" E	29.04'
L72	S 64°41'49" E	23.48'
L73	N 88°48'15" E	96.12'
L74	N 56°11'49" E	57.95'
L75	N 85°37'32" W	16.18'

NUMBER	DIRECTION	DISTANCE
L76	S 56°11'49" W	42.31'
L77	S 88°48'15" W	90.84'
L78	N 64°41'49" W	21.61'
L80	N 40°46'25" W	63.71'
L81	S 88°14'58" W	66.58'
L82	S 57°46'06" W	198.86'
L83	N 75°55'37" W	10.25'
L84	N 01°21'00" E	74.63'
L85	N 00°44'58" E	76.81'
L86	S 19°49'41" W	4.84'
L87	N 54°54'21" E	71.62'
L88	N 88°48'09" E	17.93'
L89	S 54°54'21" W	83.34'
L90	S 00°44'58" W	75.13'
L91	S 01°21'00" W	76.89'

NUMBER	DELTA	BEARING	TANGENT	RADIUS	LENGTH	CHORD
C25	80°14'49"	N 45°07'25" W	30.13	30.00	47.25	42.52
C26	29°30'09"	N 75°29'45" W	105.32	400.00	205.97	203.70
C27	21°28'35"	N 50°01'23" W	60.21	318.00	119.01	118.32
C28	28°42'02"	N 53°39'06" W	72.40	283.00	141.76	140.28
C29	21°59'53"	N 79°00'03" W	186.01	957.00	367.43	365.18
C30	50°19'22"	N 64°50'19" W	131.53	280.00	245.92	238.09
C31	33°47'54"	N 56°34'35" W	112.41	370.00	218.26	215.11
C32	07°24'28"	N 69°46'18" W	27.84	430.00	55.60	55.58
C33	00°36'57"	S 12°25'41" W	1.32	245.00	2.63	2.63
C34	07°55'15"	N 16°41'47" E	21.12	305.00	42.16	42.13

NUMBER	DIRECTION	DISTANCE
L10	N 90°00'00" W	40.00'
L11	S 89°45'11" W	44.83'
L12	N 60°44'40" W	160.07'
L13	N 90°00'00" W	55.80'
L14	N 39°40'36" W	94.25'
L15	N 73°28'32" W	123.01'
L16	S 26°03'53" W	149.30'
L17	S 11°57'45" E	59.43'
L18	S 12°01'17" W	127.75'
L19	S 49°27'04" W	357.88'
L20	S 73°04'25" W	154.04'
L21	N 75°31'12" W	124.79'
L22	N 21°46'24" W	61.19'
L23	N 29°05'35" E	36.75'
L24	N 72°15'01" W	149.40'
L25	N 77°15'50" W	60.00'
L26	N 69°20'35" W	134.21'
L27	N 12°16'03" E	43.85'
L28	S 32°35'44" E	86.45'
L29	N 49°01'57" W	5.75'
L30	N 40°58'03" E	60.00'
L31	N 49°01'57" W	5.39'
L32	N 39°11'54" E	80.87'
L33	N 39°11'54" E	75.07'
L34	N 30°00'48" E	89.23'
L35	N 30°00'48" E	85.78'
L36	N 02°40'36" E	51.94'
L37	N 02°40'36" E	72.73'
L38	N 01°54'06" W	162.55'
L39	S 89°13'42" W	67.83'
L40	N 42°32'00" W	119.84'
L41	N 00°00'00" E	68.27'

TOTAL AREA IN DEERFIELD ESTATES
5,242,919 SF.
120.3609 AC.

SUBDIVISION NO. 1
1,506,211 SF.
34.5778 AC.

REMAINDER PARCEL
3,736,707 SF.
85.7630 AC.

P.P. # 05-00-100-000-009
GRUNWALD JANEL L. ROSS/STEELE
INST. # 980544271

P.P. # 05-00-100-000-016
AMHERST SPORTSMAN S. CLUB INC.

P.P. # 05-00-001-000-066
AMHERST DEVELOPMENT L.L.C.

P.P. # 05-00-001-000-069
BRAUN DENNIS EUGENE ETAL
INST. # 970470578

P.P. # 05-00-001-000-008
KIRKWOOD JACQUELINE A.
INST. # 20020848163

P.P. # 05-00-001-000-078
PARKER ROBERT J. & GAIL L.
INST. # 970473025

P.P. # 05-00-001-000-011
PACHECO MARIA
DEED VOL 1223, PG. 514

P.P. # 05-00-001-000-012
AMHERST DEVELOPMENT L.L.C.

P.P. # 05-00-001-000-048
AMHERST DEVELOPMENT L.L.C.
INST. # 20030890227

P.P. # 05-00-001-000-044
CLEVELAND CLINIC FOUNDATION
INST. # 20000694113

P.P. # 05-00-001-000-024
AMHERST DEVELOPMENT L.L.C.

P.P. # 05-00-001-000-025
AMHERST DEVELOPMENT L.L.C.
INST. # 20040023233

"THE FOLLOWING PROVISIONS APPLY TO WETLAND AREA WITHIN DEERFIELD ESTATES SUBDIVISION NO. 1

(A) THERE SHALL BE NO DREDGING, FILLING OR OTHER DISCHARGES WITHIN OR IMPACTING THE WETLAND AREAS EXCEPT IN COMPLIANCE WITH APPLICABLE STATUTES, RULES, AND ORDINANCES PERTAINING TO WETLANDS, INCLUDING STATUTES AND RULES ISSUED BY OR IMPLEMENTED BY THE U.S. ARMY CORPS OF ENGINEERS, THE U.S. ENVIRONMENTAL PROTECTION AGENCY, AND THE OHIO ENVIRONMENTAL PROTECTION AGENCY.

(B) THERE SHALL BE NO CONSTRUCTION, DEVELOPMENT OR IMPROVEMENT WORK WITHIN OR IMPACTING THE WETLAND AREAS EXCEPT AS PERMITTED BY THE U.S. ARMY CORPS OF ENGINEERS AND/OR THE OHIO ENVIRONMENTAL PROTECTION AGENCY;

(C) MOVING AND TRASH DISPOSAL, INCLUDING VEGETATION CLIPPINGS, SHALL BE PROHIBITED WITHIN THE BOUNDARIES OF THE WETLAND AREAS;

(D) EACH OWNERS OF LAND WITHIN THE SUBDIVISION SHALL INDEMNIFY AND HOLD AMHERST DEVELOPMENT LLC AND DEERFIELD ESTATES HOMEOWNERS ASSOCIATION, INC. HARMLESS FROM AND AGAINST ANY LIABILITY, COST, AND EXPENSE (INCLUDING REASONABLE ATTORNEY AND/OR ENVIRONMENTAL CONSULTANT FEES) ARISING OUT OF OR RELATING TO THE FAILURE BY AN OWNER TO COMPLY WITH THESE REQUIREMENTS;

(E) THESE REQUIREMENTS SHALL NOT BE AMENDED EXCEPT BY THE AMHERST DEVELOPMENT, LLC AND/OR EXCEPT IN ACCORDANCE WITH APPLICABLE STATUTES, RULES, AND ORDINANCES PERTAINING TO WETLANDS, INCLUDING STATUTES AND RULES ISSUED BY OR IMPLEMENTED BY THE U.S. ARMY CORPS OF ENGINEERS, THE U.S. ENVIRONMENTAL PROTECTION AGENCY, AND THE OHIO ENVIRONMENTAL PROTECTION AGENCY.

(F) AMHERST DEVELOPMENT, LLC AND DEERFIELD ESTATES HOMEOWNERS ASSOCIATION, INC., TOGETHER WITH GOVERNMENTAL AGENCIES REFERRED TO ABOVE, SHALL HAVE THE RIGHT TO ENFORCE THE ABOVE PROVISIONS."

"DEERFIELD ESTATES SUBDIVISION NO. 1 IS SUBJECT TO DECLARATION OF COVENANTS, CONDITION, RESTRICTIONS, RESERVATIONS AND EASEMENT FOR DEERFIELD ESTATES HOMEOWNERS ASSOCIATION, INC. AND CODE OF REGULATION FOR DEERFIELD ESTATES HOMEOWNERS ASSOCIATION, INC. RECORDED IN VOLUME _____ PAGE _____ OF LORAIN COUNTY RECORDS"

LEGEND

- WETLANDS AREA
- I.P. FD. IN MON. BOX
- I.P. SET IN MON. BOX
- I.P./PIPE FD.
- 5/8"x30" I.P. SET OR WILL BE SET (CAPPED SUHAIL-7806)

NO.	DATE	REVISIONS	BY	REFERENCE DRAWINGS

Suhail & Suhail, Inc.
Consulting Engineers & Surveyors

8401 Chagrin Road, Suite 17
Chagrin Falls, Ohio 44023
(440) 708-1330 Fax: (440) 708-1334

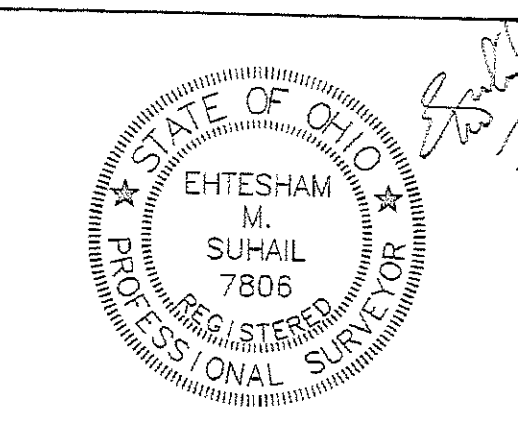

DR. BY: *HS*

CHK. BY: *EMS*

DATE: OCT. 25, 2004

SCALE: 1" = 120'

**DEERFIELD ESTATES
SUBDIVISION NO. 1**

BOUNDARY SURVEY

PREPARED FOR
AMHERST DEVELOPMENT, LLC
30575 BAINBRIDGE ROAD, SUITE 100
SOLOM, OH 44139

S&S JOB NO. **03150**

SHEET NO. **3 OF 3**