

ARLINGTON PLACE SUBDIVISION NO. 1

BEING PART OF
ORIGINAL AVON TOWNSHIP SECTION 2
CITY OF AVON, COUNTY OF LORAIN, STATE OF OHIO

OWNER'S CERTIFICATE

SITUATED IN AVON TOWNSHIP, COUNTY OF LORAIN, STATE OF OHIO, AND BEING PART OF ORIGINAL AVON TOWNSHIP SECTION NUMBER 2, CONTAINING 15.6781 ACRES.

THE UNDERSIGNED, OSTER CONSTRUCTION, INC., HEREBY CERTIFIES THE ATTACHED PLAT CORRECTLY REPRESENTS ITS "ARLINGTON PLACE SUBDIVISION NO. 1" A SUBDIVISION OF LOTS 1 TO 29 INCLUSIVE, DOES HEREBY ACKNOWLEDGE THIS PLAT OF SAME AND DEDICATES TO PUBLIC USE AS SUCH, ALL OR PART OF THE ROADS, BOULEVARDS, PLANTING STRIPS, ETCETERA SHOWN HEREIN AND NOT HERETOFORE DEDICATED.

THE UNDERSIGNED FURTHER AGREES THAT ANY USE OR IMPROVEMENTS MADE ON THIS LAND SHALL BE IN CONFORMITY WITH ALL EXISTING PLATTING, HEALTH OR OTHER LAWFUL RULES AND REGULATIONS INCLUDING THE APPLICABLE OFF-STREET PARKING AND LOADING REQUIREMENTS OF THE CITY OF AVON, OHIO, FOR THE BENEFIT OF THEMSELVES AND ALL OTHER SUBSEQUENT PARTIES TAKING TITLE FROM, UNDER OR THROUGH THE UNDERSIGNED.

THE DIMENSIONS OF THE LOTS AND STREET ARE SHOWN ON THE PLAT IN FEET AND DECIMAL PARTS THEREOF. EASEMENTS ARE RESERVED WHERE INDICATED ON THE PLAT FOR PUBLIC UTILITY PURPOSES ABOVE OR BENEATH THE GROUND.

IN WITNESS THEREOF THE UNDERSIGNED HAVE HEREUNTO SET HIS HAND THIS 30th DAY OF November, 2004.

OSTER CONSTRUCTION, INC.

Thomas H. Oster, President
THOMAS OSTER, PRESIDENT

Maria T. Pettit
WITNESS

John Evers
WITNESS

NOTARY PUBLIC

STATE OF OHIO
LORAIN COUNTY

BEFORE ME, A NOTARY PUBLIC, IN AND FOR SAID COUNTY AND STATE DID PERSONALLY APPEAR THE ABOVE SIGNED OFFICER OF West Palm I, LLC & West Palm II, LLC, WHO ACKNOWLEDGED THE SIGNING OF THIS PLAT TO BE HIS VOLUNTARY ACT AND DEED FOR THE PURPOSES THEREIN EXPRESSED. IN WITNESS THEREOF I HAVE HEREUNTO SET MY HAND AND OFFICIAL SEAL THIS 30th DAY OF November, 2004.

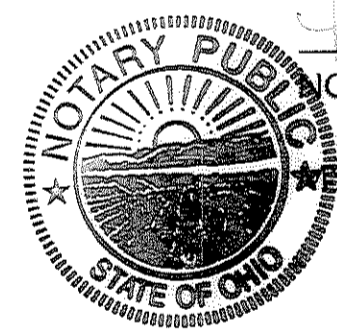

Rebecca Ondrejovic
NOTARY PUBLIC
COMMISSION EXPIRES: 3/28/09

MORTGAGEE'S CERTIFICATE

THIS IS TO CERTIFY THAT THE UNDERSIGNED OFFICERS OF Fifth Third Bank, MORTGAGEE OF LANDS EMBRACED WITHIN THIS PLAT OF ARLINGTON PLACE SUBDIVISION NO. 1 HEREBY ACCEPT THE SAME TO BE CORRECT AND DEDICATE TO PUBLIC USE THE STREETS AND EASEMENTS AS SHOWN HEREON

Timothy M. Brown
MORTGAGEE

BY: Timothy M. Brown
TITLE: Vice President

NOTARY PUBLIC

STATE OF OHIO
LORAIN COUNTY

BEFORE ME, A NOTARY PUBLIC, IN AND FOR SAID COUNTY AND STATE DID PERSONALLY APPEAR THE ABOVE SIGNED OFFICER OF THE MORTGAGEE, WHO ACKNOWLEDGED THE SIGNING OF THIS PLAT TO BE VOLUNTARY ACT AND DEED FOR THE PURPOSES THEREIN EXPRESSED. IN WITNESS THEREOF I HAVE HEREUNTO SET MY HAND AND OFFICIAL SEAL THIS 30th DAY OF November, 2004.

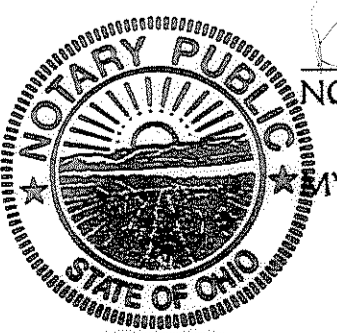

Rebecca Ondrejovic
NOTARY PUBLIC
COMMISSION EXPIRES: 3/28/09

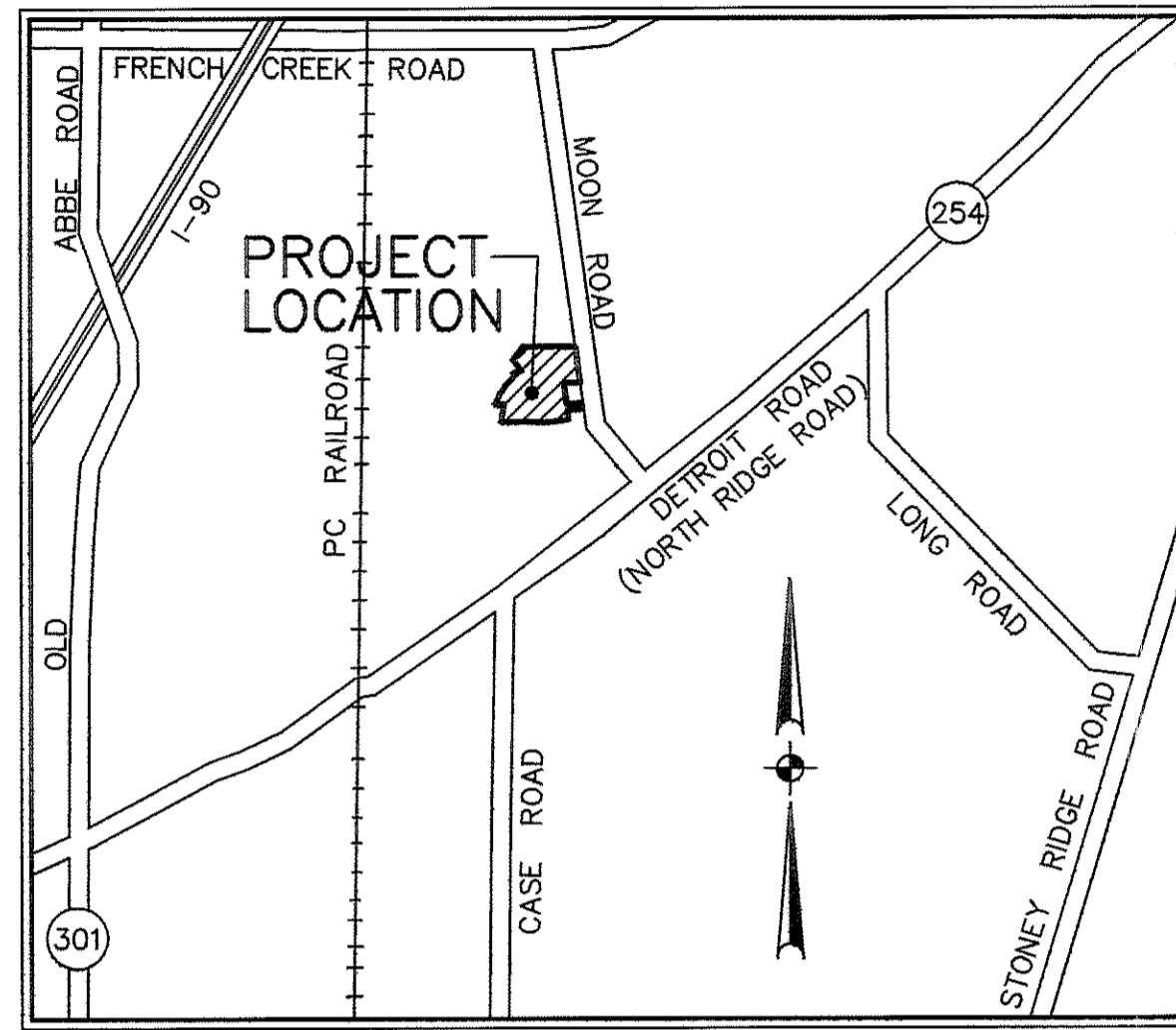

VICINITY MAP
NO SCALE

APPROVALS

THIS PLAT IS APPROVED FOR RECORDING PURPOSES ONLY
THIS 11 DAY OF JANUARY, 2004 - 2005

Michael C. Bramhall
CITY OF AVON CONSULTING ENGINEER, MICHAEL C. BRAMHALL, P.E., P.S.

THIS PLAT IS APPROVED FOR RECORDING PURPOSES ONLY
THIS 14th DAY OF January, 2004 - 2005

Carolyn Witherspoon
PLANNING COMMISSION CHAIRPERSON, CAROLYN WITHERSPOON

THIS PLAT IS APPROVED FOR RECORDING PURPOSES ONLY
THIS 14th DAY OF January, 2005. THIS APPROVAL DOES NOT CONSTITUTE AN ACCEPTANCE OF THE DEDICATION OF ANY PUBLIC STREET OR HIGHWAY DEDICATED HEREON.

Larry Hoekstra
COUNCIL PRESIDENT, LARRY HOEKSTRA

SURVEYOR'S CERTIFICATE

THIS IS TO CERTIFY THAT AT THE REQUEST OF THE OWNERS I HAVE SURVEYED AND PLATTED ARLINGTON PLACE SUBDIVISION NO. 1 AS SHOWN HEREON, EMBRACING 15.7139 ACRES OF LAND IN AVON TOWNSHIP SECTION 2, CITY OF AVON, COUNTY OF LORAIN, AND STATE OF OHIO OF WHICH 2.7352 ACRES LIE IN PUBLIC STREET DEDICATION, 4.9120 ACRES LIE IN BLOCKS, AND 8.0667 ACRES LIE IN LOTS NUMBERED 1 TO 29, INCLUSIVE.

IRON PIPES OR PINS WERE FOUND AT ALL POINTS INDICATED THUSLY ⊙, AND IRON PINS WERE SET AT ALL POINTS INDICATED AS ○. DISTANCES ARE GIVEN IN FEET AND DECIMAL PARTS THEREOF. BEARINGS ARE BASED ON AN ASSUMED MERIDIAN AND ARE GIVEN FOR THE PURPOSE OF DESCRIBING ANGLES ONLY. DIMENSION ON CURVES ARE ARC MEASUREMENTS. THIS PLAT REPRESENTS A SURVEY IN WHICH THE TRAVERSE OF THE EXTERIOR BOUNDARIES OF THE TRACT AND OF EACH BLOCK WHEN COMPUTED FROM FIELD MEASUREMENTS ON THE GROUND CLOSED WITHIN A LIMIT OF ERROR OF ONE FOOT IN TEN THOUSAND BEFORE BALANCING THE SURVEY ALL OF WHICH I CERTIFY TO BE CORRECT TO THE BEST OF MY PROFESSIONAL KNOWLEDGE AND BELIEF.

David L. Elwell
DAVID L. ELWELL, REGISTERED SURVEYOR NO. 6333

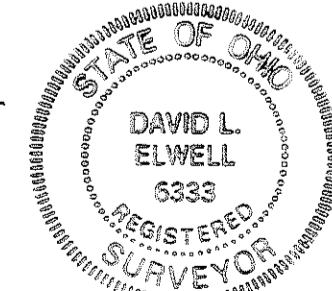

LEGEND

- ⊙ INDICATES IRON PIN FOUND
- INDICATES 5/8" X 30" CAPPED IRON PIN SET LABELED KS ASSOCS INC. PROP MARKER
- ⊠ INDICATES MONUMENT FOUND
- ⊡ INDICATES MONUMENT SET

AREA TABULATION:

AREA IN R/W	-	2.7352 Ac.	AREA IN SECTION 2	-	15.7139 Ac.
AREA IN LOTS	-	8.0667 Ac.	TOTAL AREA	-	15.7139 Ac.
AREA IN BLOCKS	-	4.9120 Ac.			
TOTAL AREA	-	15.7139 Ac.			

OWNER'S CERTIFICATE

SITUATED IN AVON TOWNSHIP, COUNTY OF LORAIN, STATE OF OHIO, AND BEING PART OF ORIGINAL AVON TOWNSHIP SECTION NUMBER 2, CONTAINING 0.0358 ACRES.

THE UNDERSIGNED, WEST PALM I, LLC AND WEST PALM II, LLC, HEREBY CERTIFIES THE ATTACHED PLAT CORRECTLY REPRESENTS ITS "ARLINGTON PLACE SUBDIVISION NO. 1" A SUBDIVISION OF LOTS 1 TO 29 INCLUSIVE, DOES HEREBY ACKNOWLEDGE THIS PLAT OF SAME AND DEDICATES TO PUBLIC USE AS SUCH, ALL OR PART OF THE ROADS, BOULEVARDS, PLANTING STRIPS, ETCETERA SHOWN HEREIN AND NOT HERETOFORE DEDICATED.

THE UNDERSIGNED FURTHER AGREES THAT ANY USE OR IMPROVEMENTS MADE ON THIS LAND SHALL BE IN CONFORMITY WITH ALL EXISTING PLATTING, HEALTH OR OTHER LAWFUL RULES AND REGULATIONS INCLUDING THE APPLICABLE OFF-STREET PARKING AND LOADING REQUIREMENTS OF THE CITY OF AVON, OHIO, FOR THE BENEFIT OF THEMSELVES AND ALL OTHER SUBSEQUENT PARTIES TAKING TITLE FROM, UNDER OR THROUGH THE UNDERSIGNED.

THE DIMENSIONS OF THE LOTS AND STREET ARE SHOWN ON THE PLAT IN FEET AND DECIMAL PARTS THEREOF. EASEMENTS ARE RESERVED WHERE INDICATED ON THE PLAT FOR PUBLIC UTILITY PURPOSES ABOVE OR BENEATH THE GROUND.

IN WITNESS THEREOF THE UNDERSIGNED HAVE HEREUNTO SET HIS HAND THIS 30th DAY OF November, 2004.

WEST PALM I, LLC
Laurence R. Kingston
MANAGING MEMBER

John Evers
WITNESS

WEST PALM II, LLC
John M. Kingston
MANAGING MEMBER

John Evers
WITNESS

NOTARY PUBLIC

STATE OF OHIO
LORAIN COUNTY

BEFORE ME, A NOTARY PUBLIC, IN AND FOR SAID COUNTY AND STATE DID PERSONALLY APPEAR THE ABOVE SIGNED OFFICER OF West Palm I, LLC & West Palm II, LLC, WHO ACKNOWLEDGED THE SIGNING OF THIS PLAT TO BE HIS VOLUNTARY ACT AND DEED FOR THE PURPOSES THEREIN EXPRESSED. IN WITNESS THEREOF I HAVE HEREUNTO SET MY HAND AND OFFICIAL SEAL THIS 30th DAY OF November, 2004.



Rebecca Ondrejovic
NOTARY PUBLIC
COMMISSION EXPIRES: 3/28/09

UTILITY EASEMENTS

WE THE UNDERSIGNED OWNER OF THE WITHIN PLATTED LAND, DO HEREBY GRANT UNTO THE CENTURYTEL OF OHIO, ADELPHIA CABLE, AND THE ILLUMINATING COMPANY, ALL OHIO CORPORATIONS, THEIR SUCCESSORS AND ASSIGNS (HEREIN AFTER REFERRED TO AS THE GRANTEE) A PERMANENT RIGHT-OF-WAY AND EASEMENT TWELVE (12) FEET IN WIDTH, UNDER, OVER, AND THROUGH ALL SUBLOTS AND ALL LANDS OWNED BY THE GRANTOR SHOWN HEREON AND PARALLEL WITH AND CONTIGUOUS TO THE PUBLIC THOROUGHFARES, AND ALSO UPON LANDS AS DEPICTED HEREON TO CONSTRUCT, PLACE, OPERATE, MAINTAIN, REPAIR, RECONSTRUCT, RELOCATE, RENEW, SUPPLEMENT, OR REMOVE SUCH UNDERGROUND ELECTRIC, AND COMMUNICATIONS CABLES, DUCTS, CONDUITS, PIPES, SURFACE OR BELOW GROUND MOUNTED TRANSFORMERS AND PEDESTALS, CONCRETE PADS AND OTHER FACILITIES AS ARE DEEMED NECESSARY OR CONVENIENT BY THE GRANTEE FOR DISTRIBUTING, TRANSPORTING, AND TRANSMITTING ELECTRICITY, AND COMMUNICATION SIGNALS FOR PUBLIC AND PRIVATE USE AT SUCH LOCATION AS THE GRANTEE MAY DETERMINE UPON, WITHIN AND ACROSS SAID EASEMENT PREMISES. SAID EASEMENT RIGHTS SHALL INCLUDE THE RIGHT, WITHOUT LIABILITY THEREFORE, TO REMOVE TREES AND LANDSCAPING, INCLUDING LAWNS WITHIN AND WITHOUT SAID EASEMENT PREMISES WHICH MAY INTERFERE WITH THE INSTALLATION, MAINTAINANCE, REPAIR OR OPERATION OF SAID ELECTRIC, AND COMMUNICATIONS FACILITIES THE RIGHT TO INSTALL, REPAIR, AUGMENT AND MAINTAIN SERVICE CABLES AND PIPE LINES OUTSIDE THE ABOVE DESCRIBED EASEMENT PREMISES OR THE RIGHT OF ACCESS, INGRESS AND EGRESS TO AND FROM ANY OF THE WITHIN DESCRIBED PREMISES FOR EXERCISING ANY OF THE PURPOSES OF THE RIGHT-OF-WAY AND EASEMENT GRANT.

GRANTOR:
OSTER CONSTRUCTION, INC.
Thomas H. Oster, President
THOMAS OSTER, PRESIDENT

GRANTEES:
Adelphia Cable
ADELPHIA CABLE
CenturyTel of Ohio
CENTURYTEL OF OHIO
Vin Decker
THE ILLUMINATING COMPANY

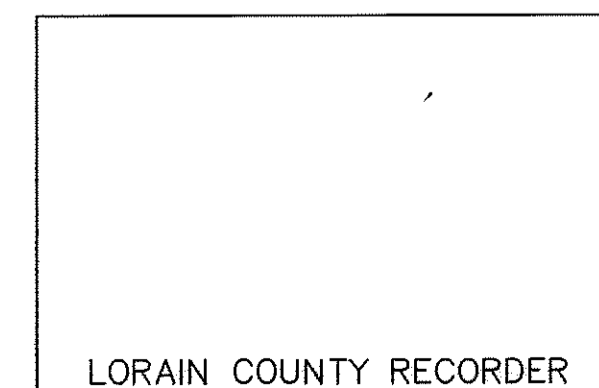
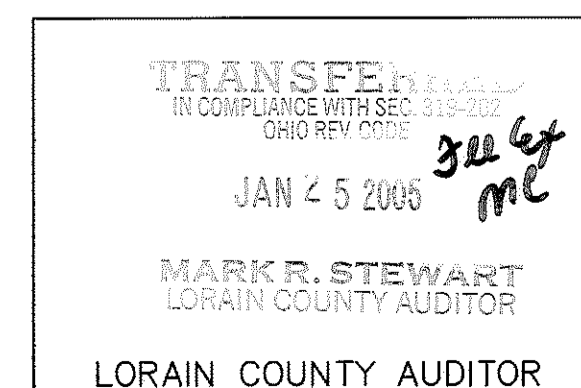

BY	DATE	DESCRIPTION
AUS	9-10-04	REVISED SUBLOTS 1, 2, 3 & BLOCK "A"
RRB	01-19-04	REVISED PER LOT SPLIT
JRK	11-26-03	REVISED LAYOUT
AUS	10-28-03	ORIGINAL ISSUE DATE

DATE:	10-15-03
DRAWN BY:	DAM
CHKD BY:	L-RELATES
DWG. NAME:	L-RELATES
PATH:	JE:USERS\ADMIN\CONTROL
P.F.:	

KS Associates, Inc. 260 Burns Rd., Suite 100 Elyria, Ohio 44035 Phone (440) 365-4730 Fax (440) 365-4790 mailto:info@ksassoc.com www.ksassoc.com

RECORD PLAT ARLINGTON PLACE SUBDIVISION NO. 1 OF PART OF AVON TOWNSHIP ORIGINAL SECTION NO. 2 CITY OF AVON COUNTY OF LORAIN STATE OF OHIO
--

SHEET 1 OF 3
JOB NO. 02191

R:\02000\02191\edit\control\dwg\1-PLATCS.dwg 10/21/2004 10:29:46 AM EDT

