

- LEGEND**
- 5/8" CAPPED REBAR SET
 - IRON PIN FOUND
 - ⊠ MONUMENT BOX FOUND

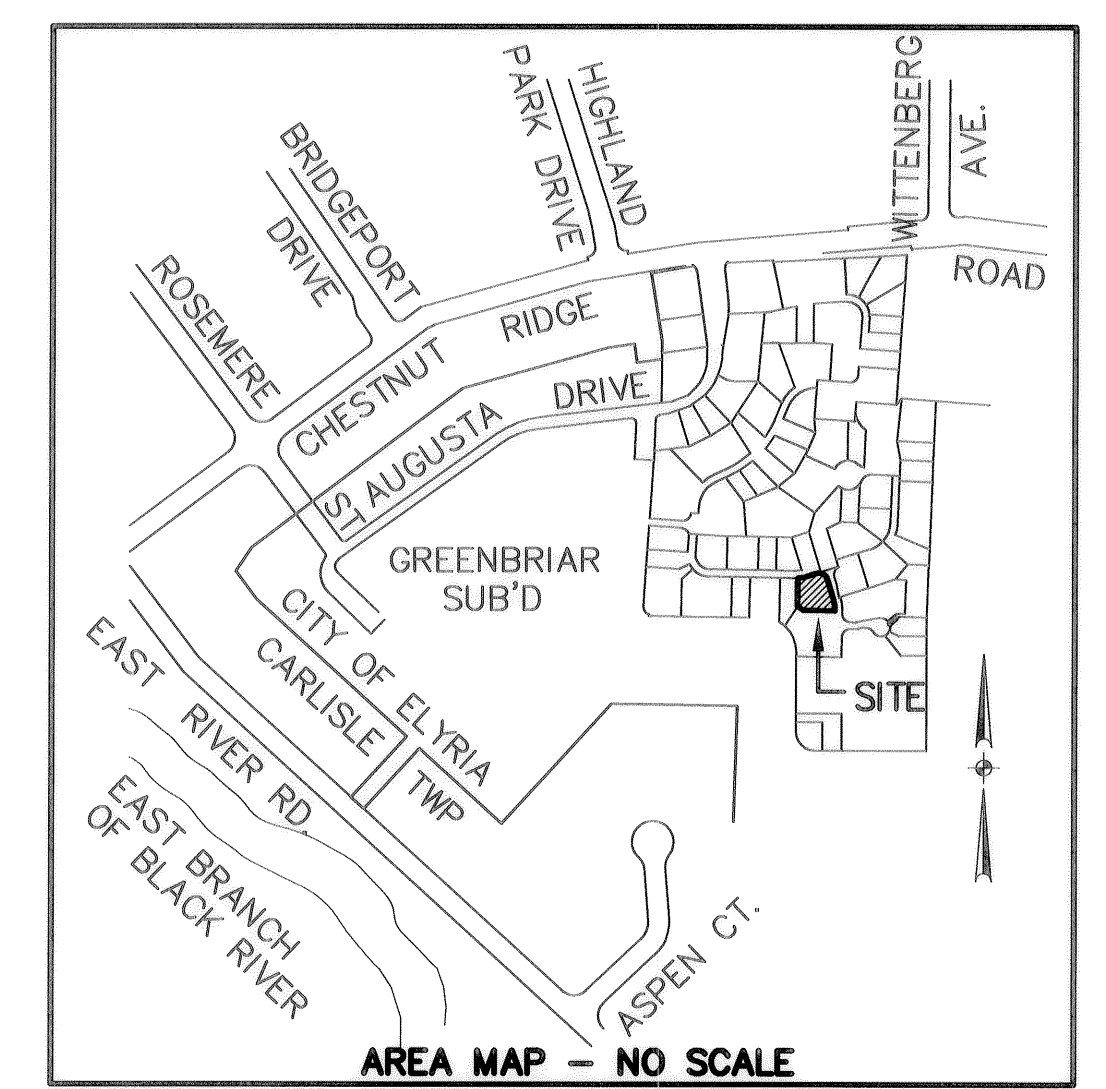

TOTAL AREA PHASE 22
0.2420 AC.

CURVE DATA						
CURVE	RADIUS	LENGTH	TANGENT	CHORD	BEARING	DELTA
C1	25.00'	39.27'	25.00'	35.36'	N48°54'17"E	90°00'00"
C2	89.00'	97.60'	54.36'	92.78'	S35°19'14"W	62°49'55"
C3	24.09'	28.52'	16.20'	26.88'	N52°10'47"W	67°49'53"
C4	111.00'	41.42'	20.95'	41.18'	S56°02'47"W	21°22'49"
C5	289.00'	92.98'	46.90'	92.58'	N57°31'10"E	18°26'05"
C6	289.00'	62.80'	31.52'	62.67'	N29°00'29"E	12°26'59"
C7	111.00'	61.91'	31.78'	61.11'	S38°45'42"W	31°57'26"
C8	89.00'	106.91'	60.97'	100.60'	N57°11'42"E	68°49'27"
C9	311.00'	48.48'	24.29'	48.43'	N35°46'40"E	8°55'51"
C10	311.00'	89.98'	45.31'	89.67'	N58°26'52"E	16°34'40"
C11	311.00'	47.79'	23.94'	47.74'	N54°33'40"E	8°48'16"
C12	311.00'	42.19'	21.13'	42.16'	N62°51'00"E	7°46'24"

CONTINUED ON SHEET 3

SHEET INDEX

- | SHEET NO. | DESCRIPTION |
|-----------|------------------------------|
| 1 | SURVEY MAP & MISC. |
| 2 | SURVEY MAP & MISC. CONTINUED |
| 3 | CURVE DATA & OWNERSHIP TABLE |
| 4 | FLOOR & FOUNDATION PLANS |
| 5 | ELEVATION VIEWS |

CERTIFICATION
THIS IS TO CERTIFY THAT THE ATTACHED DRAWINGS CORRECTLY REPRESENT THE BUILDINGS AS CONSTRUCTED AND THAT THERE ARE NO ENCROACHMENTS ON ADJUTING PROPERTIES, EXCEPT AS SHOWN.

TRANSFERRED
OCT 2 2 2004
MARK R. STEWART
LORAIN COUNTY AUDITOR

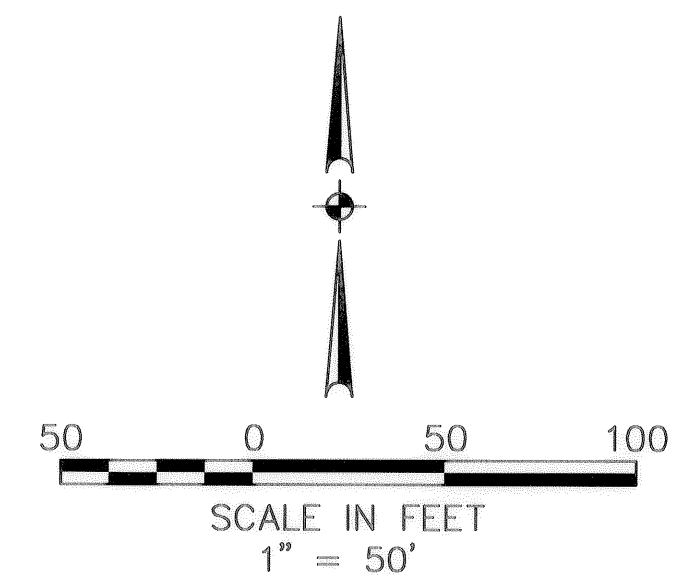

Lynn S. Miggins
LYNN S. MIGGINS
PROFESSIONAL ENGINEER NO. 46837

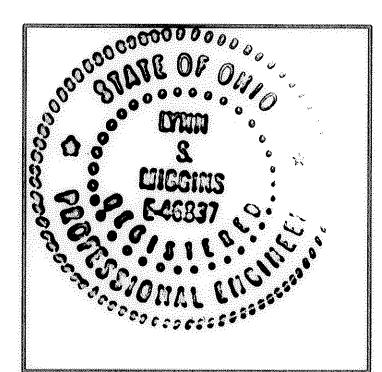

David L. Elwell
DAVID L. ELWELL
PROFESSIONAL SURVEYOR NO. 6333

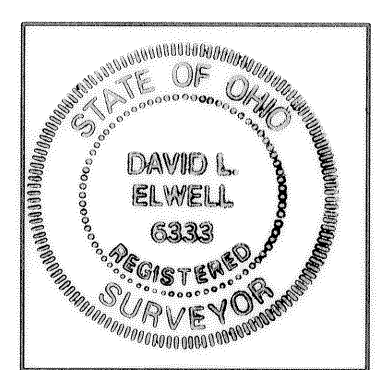

DATE	DESCRIPTION	BY
9-23-04	ORIGINAL ISSUE	BAP

KS ASSOCIATES
KS ASSOCIATES, INC.
960 Burns Road, Suite 100
Elyria, Ohio 44035
Phone (440) 365-4730
Fax (440) 365-4790
mailroom@ksassoc.com
www.ksassoc.com

STONEHEDGE CONDOMINIUMS
PHASE NO. 22
PART OF
CARLISLE TOWNSHIP SECTION NO. 5
CITY OF ELYRIA COUNTY OF LORAIN STATE OF OHIO

SHEET
1 OF
5
JOB NO.
92424-CP22

